



# Agenda Report

2725 Judge Fran Jamieson  
Way  
Viera, FL 32940

## Consent

---

F.1.

10/22/2024

---

### Subject:

Final Plat Approval, Re: Trafford Drive  
Developer: ADI Lynx, LLC      District 4

### Fiscal Impact:

None

### Dept/Office:

Planning and Development

### Requested Action:

In accordance with Section 62-2841(i) and Section 62-2844, it is requested that the Board of County Commissioners grant final plat approval and authorize the Chair to sign the final plat for Trafford Drive.

### Summary Explanation and Background:

There are three stages of review for a subdivision plan approval: pre-application, civil plan and preliminary plat approval, and final platting. The pre-application meeting for the Viera Village Center II was held March 4, 2021. The civil plans and preliminary plat were approved June 28, 2021. The third stage of review is the final plat approval for recordation. The original plat for Viera Village Center II was approved by the Board of County Commissioners and recorded with the Clerk of the Court on August 13, 2021. This subdivision of land establishing and dedicating Trafford Drive is a replat of Tract A of the Viera Village Center II plat.

Trafford Drive is located within the Viera DRI, east of Stadium Parkway, and north of Ivanhoe Drive. Board approval and acceptance of the proposed plat will dedicate Trafford Drive to the County for public use. Trafford Drive has been inspected and issued a certificate of completion from the Brevard County Public Works Department as part of the approved Engineering Revision for the ADI Office Park site plan 22SP00055.

Staff has reviewed the final plat and contract for Trafford Drive and has determined that it complies with the applicable ordinances.

Reference: 24FM00001, 21FM00007, 21SD00002, 22SP00055, 24ER00013

Contact: Tim Craven, Planner III, 321-350-8266

### Clerk to the Board Instructions:

Please have the plat mylar signed and return to Planning and Development.



Kimberly Powell, Clerk to the Board, 400 South Street • P.O. Box 999, Titusville, Florida 32781-0999

Telephone: (321) 637-2001  
Fax: (321) 264-6972  
Kimberly.Powell@brevardclerk.us

October 23, 2024

**M E M O R A N D U M**

TO: Tad Calkins, Planning and Development Director Attn: Tim Craven

RE: Item F.1., Final Plat Approval for Trafford Drive, Developer: ADI Lynx, LLC

The Board of County Commissioners, in regular session on October 22, 2024, in accordance with Section 62-2844, granted final plat approval; and authorized the Chair to sign the final plat.

Your continued cooperation is always appreciated.

Sincerely,

BOARD OF COUNTY COMMISSIONERS  
RACHEL M. SADOFF, CLERK

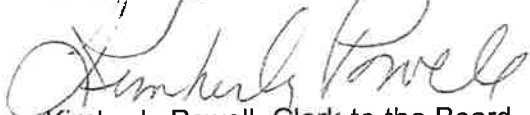
  
Kimberly Powell, Clerk to the Board

# TRAFFORD

BEING A REPLAT OF TRACT A, VIE  
AS RECORDED IN PLAT BC  
PUBLIC RECORDS OF BREVARD  
BEING IN SECTION 16, TOWNSHIP 26  
BREVARD COUNTY,

## DESCRIPTION

TRACT A, VIERA VILLAGE CENTER II, ACCORDING TO THE PLAT THEREOF AS RECORDED IN PLAT BOOK 69, P  
SECTION 16, TOWNSHIP 26 SOUTH, RANGE 36, EAST, BREVARD COUNTY, FLORIDA, AND BEING MORE PARTI  
BEGIN AT THE NORTHERLY MOST CORNER OF IVANHOE DRIVE, (A 70.00 FOOT WIDE PUBLIC RIGHT-OF-WAY),  
IN PLAT BOOK 66, PAGE 41, PUBLIC RECORDS OF BREVARD COUNTY, FLORIDA), (SAID POINT ALSO BEING TH  
ACCORDING TO THE PLAT THEREOF, AS RECORDED IN ROAD PLAT BOOK 5, PAGE 44, PUBLIC RECORDS OF I  
RIGHT-OF-WAY LINE OF SAID IVANHOE DRIVE, A DISTANCE OF 37.76 FEET TO THE BEGINNING OF A CURVE T  
CONTINUING ALONG SAID NORTH RIGHT-OF-WAY LINE, (SAID CURVE BEING CURVED CONCAVE TO THE NOR  
09°16'03", A CHORD BEARING OF S59°54'21"W AND A CHORD LENGTH OF 91.29 FEET), A DISTANCE OF 91.39 FI  
SOUTHERLY BOUNDARY OF BREVARD OAKS SKILLED NURSING FACILITY, ACCORDING TO THE PLAT THEREC  
BREVARD COUNTY, FLORIDA); THENCE ALONG THE EAST BOUNDARY OF SAID BREVARD OAKS SKILLED NUR  
THENCE ALONG THE ARC OF SAID CURVE, (SAID CURVE BEING CURVED CONCAVE TO THE NORTHWEST ANI  
CHORD BEARING OF N24°06'15"E AND A CHORD LENGTH OF 32.43 FEET), A DISTANCE OF 35.29 FEET TO A PO  
CURVE, (SAID CURVE BEING CURVED CONCAVE TO THE NORTHEAST AND HAVING A RADIUS OF 1025.00 FEET  
AND A CHORD LENGTH OF 275.98 FEET), A DISTANCE OF 276.82 FEET TO THE END OF SAID CURVE; 3) THENC  
CURVE TO THE LEFT; 4) THENCE ALONG THE ARC OF SAID CURVE, (SAID CURVE BEING CURVED CONCAVE T  
ANGLE OF 90°00'00", A CHORD BEARING OF N45°51'27"W AND A CHORD LENGTH OF 35.36 FEET), A DISTANCE  
SOUTH RIGHT-OF-WAY LINE OF VIDINA DRIVE, (A 50.00 FOOT WIDE PUBLIC RIGHT-OF-WAY ACCORDING TO TI  
PLAT BOOK 2, PAGE 39, PUBLIC RECORDS OF BREVARD COUNTY, FLORIDA); THENCE N89°08'33"E, ALONG SA  
BEGINNING OF A CURVE TO THE LEFT, (SAID POINT ALSO BEING A POINT ON THE WEST LINE OF LOT 1, BLOC  
OF SAID LOT 1, BLOCK B, THE FOLLOWING FOUR (4) COURSES AND DISTANCES; 1) THENCE ALONG THE ARC  
SOUTHEAST AND HAVING A RADIUS OF 25.00 FEET A CENTRAL ANGLE OF 80°00'00" A CHORD BEARING OF S

# Location Map

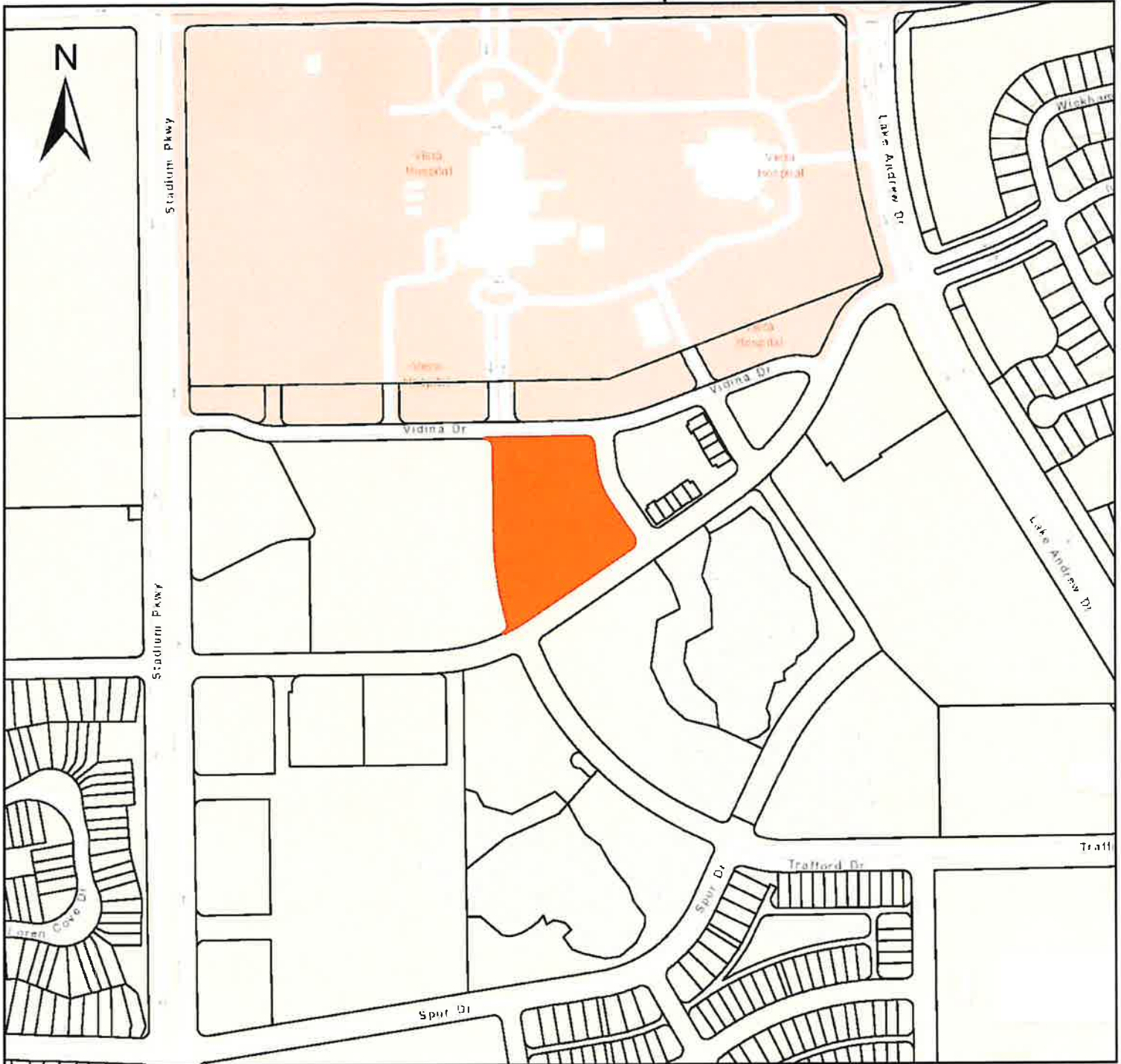

Subject Property in Orange

Disclaimer: This map was compiled from recorded documents and does not reflect an actual survey. The Brevard County Board of County Commissioners does not assume responsibility for errors or omissions hereon.

Scale: 1:6,000  
1 inch equals 500 feet

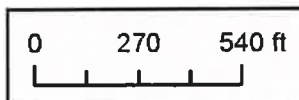

Print Time: 9/24/2024 11:13 AM