



Agenda Report

2725 Judge Fran Jamieson
Way
Viera, FL 32940

Public Hearing

H.12.

2/3/2022

Subject:

Justin M. Falscroft requests a change of zoning classification from RR-1 to AU. (21Z00039) (2404081) (District 1)

Fiscal Impact:

None

Dept/Office:

Planning & Development

Requested Action:

It is requested that the Board of County Commissioners conduct a public hearing to consider a change of zoning classification from RR-1 (Rural Residential) to AU (Agricultural Residential).

Summary Explanation and Background:

The applicant requests to change the zoning classification from RR-1 to AU in order to allow the agricultural uses and the development standards under the AU classification, such as larger accessory buildings, additional fence height, etc. The lot is currently developed with a residence and a pole barn. The AU zoning classification permits single-family residences and agricultural uses on 2.5-acre lots, with a minimum lot width and depth of 150 feet, and a minimum house size of 750 square feet. The AU classification also permits the raising/grazing of animals, fowl, beekeeping, and all agricultural pursuits, including the packing, processing, and sales of commodities raised on the premises .

The developed character of the surrounding area to the south of Highway 528 is suburban residential, which can be classified as 1 acre to 2.5-acre lots. Most lots are developed as single family on lots greater than one-acre. There are six AU-zoned lots within 1,000 feet of the subject property. The subject property is located in a residential neighborhood, which is a platted subdivision.

The Board may wish to consider the request is consistent and compatible with the surrounding area and the potential impact of agritourism.

On January 10, 2022, the Planning and Zoning Board heard the request and unanimously recommended approval.

Clerk to the Board Instructions:

Once resolution is received, please execute and return to Planning and Development.

ADMINISTRATIVE POLICIES OF THE FUTURE LAND USE ELEMENT

Administrative Policies in the Future Land Use Element establish the expertise of staff with regard to zoning land use issues and set forth criteria when considering a rezoning action or request for Conditional Use Permit, as follows:

Administrative Policy 1

The Brevard County zoning official, planners and the director of the Planning and Development staff, however designated, are recognized as expert witnesses for the purposes of Comprehensive Plan amendments as well as zoning, conditional use, special exception, and variance applications.

Administrative Policy 2

Upon Board request, members of the Brevard County Planning and Development staff shall be required to present written analysis and a recommendation, which shall constitute an expert opinion, on all applications for development approval that come before the Board of County Commissioners for quasi-judicial review and action. The Board may table an item if additional time is required to obtain the analysis requested or to hire an expert witness if the Board deems such action appropriate. Staff input may include the following:

Criteria:

- A. Staff shall analyze an application for consistency or compliance with comprehensive plan policies, zoning approval criteria and other applicable written standards.
- B. Staff shall conduct site visits of property which are the subject of analysis and recommendation. As part of the site visit, the staff shall take a videotape or photographs where helpful to the analysis and conduct an inventory of surrounding existing uses. Aerial photographs shall also be used where they would aid in an understanding of the issues of the case.
- C. In cases where staff analysis is required, both the applicant and the staff shall present proposed findings of fact for consideration by the Board.
- D. For re-zoning applications where a specific use has not been proposed, the worst case adverse impacts of potential uses available under the applicable land use classification shall be evaluated by the staff.

Administrative Policy 3

Compatibility with existing or proposed land uses shall be a factor in determining where a rezoning or any application involving a specific proposed use is being considered. Compatibility shall be evaluated by considering the following factors, at a minimum:

Criteria:

- A. Whether the proposed use(s) would have hours of operation, lighting, odor, noise levels, traffic, or site activity that would significantly diminish the enjoyment of, safety or quality of life in existing neighborhoods within the area which could foreseeably be affected by the proposed use.
- B. Whether the proposed use(s) would cause a material reduction (five percent or more) in the value of existing abutting lands or approved development.
- C. Whether the proposed use(s) is/are consistent with an emerging or existing pattern of surrounding development as determined through analysis of:

1. historical land use patterns;
 2. actual development over the immediately preceding three years; and
 3. development approved within the past three years but not yet constructed.
- D. Whether the proposed use(s) would result in a material violation of relevant policies in any elements of the Comprehensive Plan.

Administrative Policy 4

Character of a neighborhood or area shall be a factor for consideration whenever a rezoning or any application involving a specific proposed use is reviewed. The character of the area must not be materially or adversely affected by the proposed rezoning or land use application. In evaluating the character of an area, the following factors shall be considered:

Criteria:

- A. The proposed use must not materially and adversely impact an established residential neighborhood by introducing types of intensity of traffic (including but not limited to volume, time of day of traffic activity, type of vehicles, et cetera), parking, trip generation, commercial activity or industrial activity that is not already present within the identified boundaries of the neighborhood.
- B. In determining whether an established residential neighborhood exists, the following factors must be present:
 1. The area must have clearly established boundaries, such as roads, open spaces, rivers, lakes, lagoons, or similar features.
 2. Sporadic or occasional neighborhood commercial uses shall not preclude the existence of an existing residential neighborhood, particularly if the commercial use is non-conforming or pre-dates the surrounding residential use.
 3. An area shall be presumed not to be primarily residential but shall be deemed transitional where multiple commercial, industrial or other non-residential uses have been applied for and approved during the previous five (5) years.

Administrative Policy 5

In addition to the factors specified in Administrative Policies 2, 3, and 4, in reviewing a rezoning, conditional use permit or other application for development approval, the impact of the proposed use or uses on transportation facilities either serving the site or impacted by the use(s) shall be considered. In evaluating whether substantial and adverse transportation impacts are likely to result if an application is approved, the staff shall consider the following criteria:

Criteria:

- A. Whether adopted levels of services will be compromised;
- B. Whether the physical quality of the existing road system that will serve the proposed use(s) is sufficient to support the use(s) without significant deterioration;

- C. Whether the surrounding existing road system is of sufficient width and construction quality to serve the proposed use(s) without the need for substantial public improvements;
- D. Whether the surrounding existing road system is of such width and construction quality that the proposed use(s) would realistically pose a potential for material danger to public safety in the surrounding area;
- E. Whether the proposed use(s) would be likely to result in such a material and adverse change in traffic capacity of a road or roads in the surrounding area such that either design capacities would be significantly exceeded or a de facto change in functional classification would result;
- F. Whether the proposed use(s) would cause such material and adverse changes in the types of traffic that would be generated on the surrounding road system, that physical deterioration of the surrounding road system would be likely;
- G. Whether projected traffic impacts of the proposed use(s) would materially and adversely impact the safety or welfare of residents in existing residential neighborhoods.

Administrative Policy 6

The use(s) proposed under the rezoning, conditional use or other application for development approval must be consistent with, (a), all written land development policies set forth in these administrative policies; and (b), the future land use element, coastal management element, conservation element, potable water element, sanitary sewer element, solid waste management element, capital improvements element, recreation and open space element, surface water element, and transportation elements of the comprehensive plan.

Administrative Policy 7

Proposed use(s) shall not cause or substantially aggravate any, (a), substantial drainage problem on surrounding properties; or (b), significant, adverse and unmitigatable impact on significant natural wetlands, water bodies or habitat for listed species.

Administrative Policy 8

These policies, the staff analysis based upon these policies, and the applicant's written analysis, if any, shall be incorporated into the record of every quasi-judicial review application for development approval presented to the Board including rezoning, conditional use permits, and vested rights determinations.

Section 62-1151(c) of the Code of Ordinances of Brevard County directs, "The planning and zoning board shall recommend to the board of county commissioners the denial or approval of each application for amendment to the official zoning maps based upon a consideration of the following factors:

- (1) The character of the land use of the property surrounding the property being considered.
- (2) The change in conditions of the land use of the property being considered and the surrounding property since the establishment of the current applicable zoning classification, special use or conditional use.

- (3) The impact of the proposed zoning classification or conditional use on available and projected traffic patterns, water and sewer systems, other public facilities and utilities and the established character of the surrounding property.
- (4) The compatibility of the proposed zoning classification or conditional use with existing land use plans for the affected area.
- (5) The appropriateness of the proposed zoning classification or conditional use based upon a consideration of the applicable provisions and conditions contained in this article and other applicable laws, ordinances and regulations relating to zoning and land use regulations and based upon a consideration of the public health, safety and welfare.

The minutes of the planning and zoning board shall specify the reasons for the recommendation of approval or denial of each application."

CONDITIONAL USE PERMITS (CUPs)

In addition to the specific requirements for each Conditional Use Permit (CUP), Section 62-1901 provides that the following approval procedure and general standards of review are to be applied to all CUP requests, as applicable.

- (b) Approval procedure. An application for a specific conditional use within the applicable zoning classification shall be submitted and considered in the same manner and according to the same procedure as an amendment to the official zoning map as specified in Section 62-1151. The approval of a conditional use shall authorize an additional use for the affected parcel of real property in addition to those permitted in the applicable zoning classification. The initial burden is on the applicant to demonstrate that all applicable standards and criteria are met. Applications which do not satisfy this burden cannot be approved. If the applicant meets its initial burden, then the Board has the burden to show, by substantial and competent evidence, that the applicant has failed to meet such standards and the request is adverse to the public interest. As part of the approval of the conditional use permit, the Board may prescribe appropriate and reasonable conditions and safeguards to reduce the impact of the proposed use on adjacent and nearby properties or the neighborhood. A nearby property, for the purpose of this section, is defined as any property which, because of the character of the proposed use, lies within the area which may be substantially and adversely impacted by such use. In stating grounds in support of an application for a conditional use permit, it is necessary to show how the request fulfills both the general and specific standards for review. The applicant must show the effect the granting of the conditional use permit will have on adjacent and nearby properties, including, but not limited to traffic and pedestrian flow and safety, curb-cuts, off-street loading and parking, off-street pickup of passengers, odors, glare and noise, particulates, smoke, fumes, and other emissions, refuse and service areas, drainage, screening and buffering for protection of adjacent and nearby properties, and open space and economic impact on nearby properties. The applicant, at his discretion, may choose to present expert testimony where necessary to show the effect of granting the conditional use permit.
- (c) General Standards of Review.
 - (1) The planning and zoning board and the board of county commissioners shall base the denial or approval of each application for a conditional use based upon

a consideration of the factors specified in Section 62-1151(c) plus a determination whether an application meets the intent of this section.

- a. The proposed conditional use will not result in a substantial and adverse impact on adjacent and nearby properties due to: (1), the number of persons anticipated to be using, residing or working under the conditional use; (2), noise, odor, particulates, smoke, fumes and other emissions, or other nuisance activities generated by the conditional use; or (3), the increase of traffic within the vicinity caused by the proposed conditional use.
 - b. The proposed use will be compatible with the character of adjacent and nearby properties with regard to use, function, operation, hours of operation, type and amount of traffic generated, building size and setback, and parking availability.
 - c. The proposed use will not cause a substantial diminution in value of abutting residential property. A substantial diminution shall be irrebuttably presumed to have occurred if abutting property suffers a 15% reduction in value as a result of the proposed conditional use. A reduction of 10% of the value of abutting property shall create a rebuttable presumption that a substantial diminution has occurred. The Board of County Commissioners carries the burden to show, as evidenced by either testimony from or an appraisal conducted by an M A I certified appraiser, that a substantial diminution in value would occur. The applicant may rebut the findings with his own expert witnesses.
- (2) The following specific standards shall be considered, when applicable, in making a determination that the general standards specified in subsection (1) of this section are satisfied:
- a. Ingress and egress to the property and proposed structures thereon, with particular reference to automotive and pedestrian safety and convenience, traffic flow and control, and access in case of fire and catastrophe, shall be: (1), adequate to serve the proposed use without burdening adjacent and nearby uses, and (2), built to applicable county standards, if any. Burdening adjacent and nearby uses means increasing existing traffic on the closest collector or arterial road by more than 20%, or 10% if the new traffic is primarily comprised of heavy vehicles, except where the affected road is at Level of Service A or B. New traffic generated by the proposed use shall not cause the adopted level of service for transportation on applicable roadways, as determined by applicable Brevard County standards, to be exceeded. Where the design of a public road to be used by the proposed use is physically inadequate to handle the numbers, types or weights of vehicles expected to be generated by the proposed use without damage to the road, the conditional use permit cannot be approved without a commitment to improve the road to a standard adequate to handle the proposed traffic, or to maintain the road through a maintenance bond or other means as required by the Board of County Commissioners.
 - b. The noise, glare, odor, particulates, smoke, fumes or other emissions from the conditional use shall not substantially interfere with the use or enjoyment of the adjacent and nearby property.
 - c. Noise levels for a conditional use are governed by Section 62-2271.

- d. The proposed conditional use shall not cause the adopted level of service for solid waste disposal applicable to the property or area covered by such level of service, to be exceeded.
- e. The proposed conditional use shall not cause the adopted level of service for potable water or wastewater applicable to the property or the area covered by such level of service, to be exceeded by the proposed use.
- f. The proposed conditional use must have existing or proposed screening or buffering, with reference to type, dimensions and character to eliminate or reduce substantial, adverse nuisance, sight, or noise impacts on adjacent and nearby properties containing less intensive uses.
- g. Proposed signs and exterior lighting shall not cause unreasonable glare or hazard to traffic safety, or interference with the use or enjoyment of adjacent and nearby properties.
- h. Hours of operation of the proposed use shall be consistent with the use and enjoyment of the properties in the surrounding residential community, if any. For commercial and industrial uses adjacent to or near residential uses, the hours of operation shall not adversely affect the use and enjoyment of the residential character of the area.
- i. The height of the proposed use shall be compatible with the character of the area, and the maximum height of any habitable structure shall be not more than 35 feet higher than the highest residence within 1,000 feet of the property line.
- j. Off-street parking and loading areas, where required, shall not be created or maintained in a manner which adversely impacts or impairs the use and enjoyment of adjacent and nearby properties. For existing structures, the applicant shall provide competent, substantial evidence to demonstrate that actual or anticipated parking shall not be greater than that which is approved as part of the site plan under applicable county standards.

FACTORS TO CONSIDER FOR A REZONING REQUEST

Section 62-1151(c) sets forth factors to consider in connection with a rezoning request, as follows:

"The planning and zoning board shall recommend to the board of county commissioners the denial or approval of each application for amendment to the official zoning maps based upon a consideration of the following factors:

- (1) The character of the land use of the property surrounding the property being considered.
- (2) The change in conditions of the land use of the property being considered and the surrounding property since the establishment of the current applicable zoning classification, special use or conditional use.
- (3) The impact of the proposed zoning classification or conditional use on available and projected traffic patterns, water and sewer systems, other public facilities and utilities and the established character of the surrounding property.

- (4) The compatibility of the proposed zoning classification or conditional use with existing land use plans for the affected area.
- (5) The appropriateness of the proposed zoning classification or conditional use based upon a consideration of the applicable provisions and conditions contained in this article and other applicable laws, ordinances and regulations relating to zoning and land use regulations and based upon a consideration of the public health, safety and welfare."

These staff comments contain references to zoning classifications found in the Brevard County Zoning Regulations, Chapter 62, Article VI, Code of Ordinances of Brevard County. These references include brief summaries of some of the characteristics of that zoning classification. Reference to each zoning classification shall be deemed to incorporate the full text of the section or sections defining and regulating that classification into the Zoning file and Public Record for that item.

These staff comments contain references to sections of the Code of Ordinances of Brevard County. Reference to each code section shall be deemed to incorporate this section into the Zoning file and Public Record for that item.

These staff comments contain references to Policies of the Brevard County Comprehensive Plan. Reference to each Policy shall be deemed to incorporate the entire Policy into the Zoning file and Public Record for that item.

These staff comments refer to previous zoning actions which are part of the Public Records of Brevard County, Florida. These records will be referred to by reference to the file number. Reference to zoning files are intended to make the entire contents of the cited file a part of the Zoning file and Public Record for that item.

DEFINITIONS OF CONCURRENCY TERMS

Maximum Acceptable Volume (MAV): Maximum acceptable daily volume that a roadway can carry at the adopted Level of Service (LOS).

Current Volume: Building permit related trips added to the latest TPO (Transportation Planning Organization) traffic counts.

Volume with Development (VOL W/DEV): Equals Current Volume plus trip generation projected for the proposed development.

Volume/Maximum Acceptable Volume (VOL/MAV): Equals the ratio of current traffic volume to the maximum acceptable roadway volume.

Volume/Maximum Acceptable Volume with Development (VOL/MAV W/DEV): Ratio of volume with development to the Maximum Acceptable Volume.

Acceptable Level of Service (CURRENT LOS): The Level of Service at which a roadway is currently operating.

Level of Service with Development (LOS W/DEV): The Level of Service that a proposed development may generate on a roadway.



BOARD OF COUNTY COMMISSIONERS

Planning and Development Department

2725 Judge Fran Jamieson Way

Building A, Room 114

Viera, Florida 32940

(321)633-2070 Phone / (321)633-2074 Fax

<https://www.brevardfl.gov/PlanningDev>

STAFF COMMENTS

21Z00039

Justin M. Falscroft

RR-1 (Rural Residential) to AU (Agricultural Residential)

Tax Account Number: 2404081
Parcel I.D.: 24-35-11-50-*-6
Location: 3000 Friday Lane Cocoa, FL 32926 (District 1)
Acreage: 3.96 acres

Planning and Zoning Board: 1/10/2022
Board of County Commissioners: 2/03/2022

Consistency with Land Use Regulations

- Current zoning can be considered under the Future Land Use Designation, Section 62-1255.
- The proposal can be considered under the Future Land Use Designation, Section 62-1255.
- The proposal would maintain acceptable Levels of Service (LOS) (XIII 1.6.C)

	CURRENT	PROPOSED
Zoning	RR-1	AU
Potential*	3-units	1-unit
Can be Considered under the Future Land Use Map	YES RES 1	YES RES 1

* Zoning potential for concurrency analysis purposes only, subject to applicable land development regulations.

Background and Purpose of Request

The applicant requests to change the zoning classification from RR-1 (Rural Residential) to AU (Agricultural Residential) in order to allow the agricultural uses and the development standards under the AU classification, such as larger accessory buildings, additional fence height, etc. The lot is currently developed with a residence and a pole barn.

The original zoning was changed from GU (General Use) to RR-1 under Zoning action **Z-2118** on August 3, 1967.

Land Use

The subject property is currently designated as Residential 1 FLU. Both the RR-1 and AU zoning classification are consistent with the Residential 1 FLU designations.

Applicable Land Use Policies

Policy 1.9 –The Residential 1 Future land use designation. The Residential 1 land use designation permits low density residential development with a maximum density of up to one (1) dwelling unit per acre, except as otherwise may be provided for within the Future Land Use Element.

The Board should evaluate the compatibility of this application within the context of Administrative Policies 3 - 5 of the Future Land Use Element.

Analysis of Administrative Policy #3 - Compatibility between this site and the existing or proposed land uses in the area.

The subject property lies within the Residential 1 FLU designation which allows development of 1 acre lots or larger. To the west is property under the jurisdiction of the City of Cocoa. That abutting parcel has a Conservation FLU designation which limits use of the property to conservation and open space.

Analysis of Administrative Policy #4 - Character of a neighborhood or area. The developed character of the surrounding area to the south of Highway 528 is suburban residential. Suburban residential can be classified as 1 acre to 2.5 acre lots. Most lots are developed as single family on lots greater than one-acre. There are 6 AU zoned lots within 1,000 feet of this site. Two AU lots lying south of this site have agricultural exemptions on part of their property. The subject property is located in a residential neighborhood, which is a platted subdivision.

To the north is Highway 528. To its north is a developed single-family residential subdivision located within the city limits of Cocoa. To the east and south are developed single-family lots on one-acre or larger lots zoned RR-1. To the west is an undeveloped parcel lying within the city limits of Cocoa.

The property abuts the county zoning classification of RR-1 to the east and south. AU zoning can be found 650 feet to the south.

RR-1 classification permits single-family residential land uses on a minimum one-acre lot, with a minimum lot width and depth of 125 feet. The RR-1 classification permits horses, barns and horticulture as accessory uses to a single-family residence. The minimum house size is 1,200 square feet. Keeping of horses and agricultural uses are accessory to a principle residence within the RR-1 zoning district.

AU zoning classification permits single-family residences and agricultural uses on 2.5-acre lots, with a minimum lot width and depth of 150 feet. The minimum house size in AU is 750 square feet. The AU classification also permits the raising/grazing of animals, fowl and beekeeping.

GU classification is a holding category, allowing single-family residences on five acre lots with a minimum width and depth of 300 feet. The minimum house size in GU is 750 square feet.

Surrounding Area

There has been two zoning actions within a half-mile radius of the subject property within the last three years. The most recent action, **20PZ00022**, was for a change of zoning from GU to AU(L) (Agricultural Residential, Low-Intensity) adopted on May 7, 2020. This location lies 1,440 feet in a northerly direction from this parcel and is located on the north side of Oneida Street. The second action, **19PZ00078**, was for a rezoning from RR-1 to AU adopted on September 5, 2019. This location lies 2,060 feet in a southeasterly direction from this site and is located on the south side of James Road.

Preliminary Concurrency

The closest concurrency management segment to the subject property is Highway 524, between Cox Road to Industry Road, which has a Maximum Acceptable Volume (MAV) of 19,470 trips per day, a Level of Service (LOS) of D, and currently operates at 64.34% of capacity daily. The maximum development potential from the proposed rezoning does not increase the percentage of MAV utilization. The corridor is anticipated to operate at 64.34% of capacity daily. The proposal is not anticipated to create a deficiency in LOS.

No school concurrency information has been provided as the development potential of this site falls below the minimum number of new residential lots that would require a formal review.

The parcel is connected to City of Cocoa water and on-site septic.

Environmental Constraints

- Hydric Soils/Wetlands
- Aquifer Recharge Soils
- Land Clearing and Landscape Requirements
- Protected Species

The subject parcel contains mapped hydric soils. A wetland delineation will be required prior to any land clearing activities or building permit application submittal. Per Section 62-3694(c)(2), residential land uses within wetlands shall be limited to not more than one (1) dwelling unit per five (5) acres unless strict application of this policy renders a legally established parcel as of September 9, 1988, which is less than five (5) acres, as unbuildable. The preceding limitation of one dwelling unit per five (5) acres within wetlands may be applied as a maximum percentage limiting wetland impacts to not more than 1.8% of the total property. Any permitted wetland impacts must meet the requirements of Sections 62-3694(e), including avoidance of impacts, and will require mitigation in accordance with 62-3696.

Section 62-3694 states that non-bona fide agricultural and forestry operations utilizing best management practices are permitted in wetlands provided they do not result in permanent degradation or destruction of wetlands, or adversely affect the functions of the wetlands. Pursuant to the Florida Agricultural Lands and Practices Act (Chapter 163.3162(4), Florida Statutes), any activity

of a Bona Fide Agricultural Use on land classified as agricultural land pursuant to Section 193.461, Florida Statute is exempt. **The Brevard County Property Appraiser's Office establishes Bona Fide Agricultural land classification.**

Historical aerals indicate that unpermitted land clearing and filling activities may have occurred between 2020 and 2021. The discovery of unpermitted wetland impacts or land clearing activities, prior to Bona Fide Agricultural land classification, may result in code enforcement action.

The applicant is encouraged to contact NRM at 321-633-2016 prior to any site plan design or permit submittal.

For Board Consideration

The Board may wish to consider the request is consistent and compatible with the surrounding area and the potential impact of agritourism.

**NATURAL RESOURCES MANAGEMENT DEPARTMENT
Rezoning Review & Summary**

Item # 21Z00039

Applicant: Justin Falscroft

Zoning Request: RR-1 to AU

Notes: Applicant wants agricultural uses; farm animals, accessory building, higher fence.

P&Z Hearing Date: 01/10/22; **BCC Hearing Date:** 02/03/22

Tax ID No: 2404081

- This is a preliminary review based on best available data maps reviewed by the Natural Resources Management Department (NRM) and does not include a site inspection to verify the accuracy of the mapped information.
- In that the rezoning process is not the appropriate venue for site plan review, specific site designs submitted with the rezoning request will be deemed conceptual. Board comments relative to specific site design do not provide vested rights or waivers from Federal, State or County regulations.
- **This review does not guarantee whether or not the proposed use, specific site design, or development of the property can be permitted under current Federal, State, or County Regulations.**

Summary of Mapped Resources and Noteworthy Land Use Issues:

- Hydric Soils/Wetlands
- Aquifer Recharge Soils
- Land Clearing and Landscape Requirements
- Protected Species

The subject parcel contains mapped hydric soils. A wetland delineation will be required prior to any land clearing activities or building permit application submittal. Per Section 62-3694(c)(2), residential land uses within wetlands shall be limited to not more than one (1) dwelling unit per five (5) acres unless strict application of this policy renders a legally established parcel as of September 9, 1988, which is less than five (5) acres, as unbuildable. The preceding limitation of one dwelling unit per five (5) acres within wetlands may be applied as a maximum percentage limiting wetland impacts to not more than 1.8% of the total property. Any permitted wetland impacts must meet the requirements of Sections 62-3694(e), including avoidance of impacts, and will require mitigation in accordance with 62-3696.

Section 62-3694 states that non-bona fide agricultural and forestry operations utilizing best management practices are permitted in wetlands provided they do not result in permanent degradation or destruction of wetlands, or adversely affect the functions of the wetlands. Pursuant to the Florida Agricultural Lands and Practices Act (Chapter 163.3162(4), Florida Statutes), any activity of a Bona Fide Agricultural Use on land classified as agricultural land pursuant to Section 193.461, Florida Statute is exempt. **The Brevard County Property Appraiser's Office establishes Bona Fide Agricultural land classification.**

Historical aerials indicate that unpermitted land clearing and filling activities may have occurred between 2020 and 2021. The discovery of unpermitted wetland impacts or land clearing activities, prior to Bona Fide Agricultural land classification, may result in code enforcement action.

The applicant is encouraged to contact NRM at 321-633-2016 prior to any site plan design or permit submittal.

Land Use Comments:

Hydric Soils/Wetlands

The subject parcel contains mapped hydric soils (Valkaria sand) as shown on the USDA Soil Conservation Service Soils Survey map; an indicator that wetlands may be present on the property. A wetland delineation will be required prior to any land clearing activities or building permit application submittal. Per Section 62-3694(c)(2), residential land uses within wetlands shall be limited to not more than one (1) dwelling unit per five (5) acres unless strict application of this policy renders a legally established parcel as of September 9, 1988, which is less than five (5) acres, as unbuildable. The preceding limitation of one dwelling unit per five (5) acres within wetlands may be applied as a maximum percentage limiting wetland impacts to not more than 1.8% of the total property. Any permitted wetland impacts must meet the requirements of Sections 62-3694(e), including avoidance of impacts, and will require mitigation in accordance with 62-3696.

Section 62-3694 states that non-bona fide agricultural and forestry operations utilizing best management practices are permitted in wetlands provided they do not result in permanent degradation or destruction of wetlands, or adversely affect the functions of the wetlands. Pursuant to the Florida Agricultural Lands and Practices Act (Chapter 163.3162(4), Florida Statutes), any activity of a Bona Fide Agricultural Use on land classified as agricultural land pursuant to Section 193.461, Florida Statute is exempt. **The Brevard County Property Appraiser's Office establishes Bona Fide Agricultural land classification.**

Historical aerials indicate that unpermitted land clearing and filling activities may have occurred between 2020 and 2021. The discovery of unpermitted wetland impacts or land clearing activities, prior to Bona Fide Agricultural land classification, may result in code enforcement action.

Aquifer Recharge Soils

Valkaria sand may also function as an aquifer recharge soil. The applicant is hereby notified of the development and impervious restrictions within Conservation Element Policy 10.2 and the Aquifer Protection Ordinance.

Land Clearing and Landscape Requirements

The applicant is advised to refer to Article XIII, Division 2, entitled Land Clearing, Landscaping, and Tree Protection, for specific requirements for Protected and Specimen tree preservation, and canopy coverage requirements. Land clearing is not permitted without prior authorization by NRM. The discovery of unpermitted land clearing activities may result in code enforcement action.

Protected Species

Information available to NRM indicates that federally and/or state protected species may be present on the property. Prior to any plan, permit submittal, or development activity, including land clearing, the applicant should obtain any necessary permits or clearance letters from the Florida Fish and Wildlife Conservation Commission and/or U.S. Fish and Wildlife Service, as applicable.

LOCATION MAP

FALSCROFT, JUSTIN M.

21Z00039

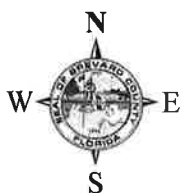

1:24,000 or 1 inch = 2,000 feet

Buffer Distance: 500 feet

This map was compiled from recorded documents and does not reflect an actual survey. The Brevard County Board of County Commissioners does not assume responsibility for errors or omissions hereon.

Produced by BoCC - GIS Date: 11/4/2021

— Buffer
■ Subject Property

ZONING MAP

FALSCROFT, JUSTIN M.

21Z00039

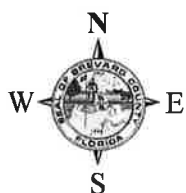
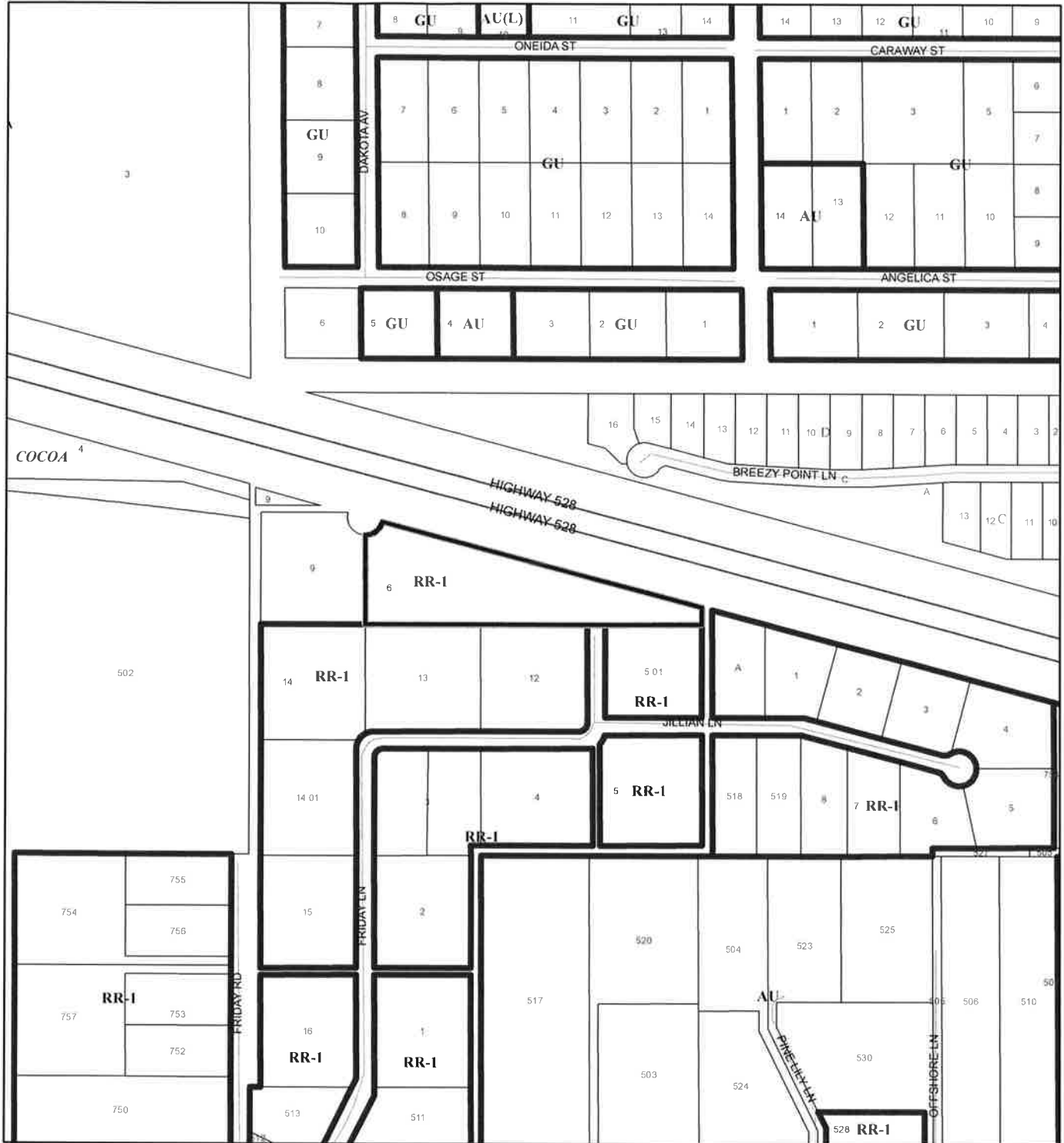

1:4,800 or 1 inch = 400 feet

This map was compiled from recorded documents and does not reflect an actual survey. The Brevard County Board of County Commissioners does not assume responsibility for errors or omissions hereon.

Produced by BoCC - GIS Date: 11/4/2021

— Subject Property

□ Parcels

□ Zoning

FUTURE LAND USE MAP

FALSCROFT, JUSTIN M.

21Z00039

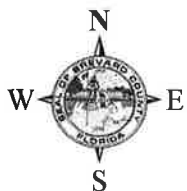

1:4,800 or 1 inch = 400 feet

Subject Property
 Parcels

This map was compiled from recorded documents and does not reflect an actual survey. The Brevard County Board of County Commissioners does not assume responsibility for errors or omissions hereon.

Produced by BoCC - GIS Date: 11/3/2021

AERIAL MAP

FALSCROFT, JUSTIN M.

21Z00039

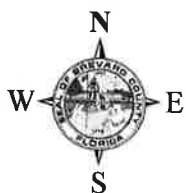
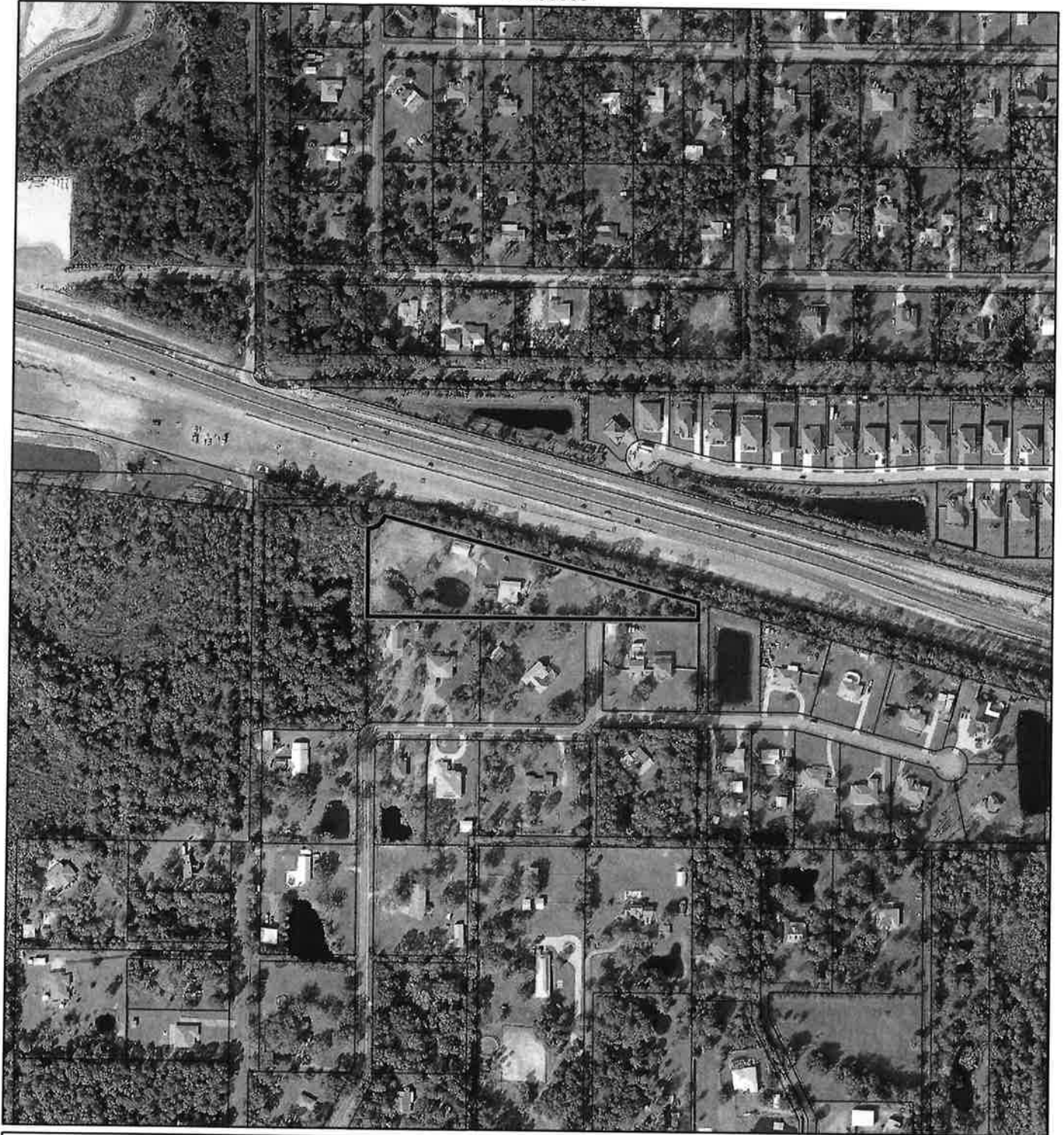



1:4,800 or 1 inch = 400 feet

PHOTO YEAR: 2021

This map was compiled from recorded documents and does not reflect an actual survey. The Brevard County Board of County Commissioners does not assume responsibility for errors or omissions hereon.

Produced by BoCC - GIS Date: 11/3/2021

 Subject Property
 Parcels

NWI WETLANDS MAP

FALSCROFT, JUSTIN M.

21Z00039



1:4,800 or 1 inch = 400 feet

This map was compiled from recorded documents and does not reflect an actual survey. The Brevard County Board of County Commissioners does not assume responsibility for errors or omissions hereon.

Produced by BoCC - GIS Date: 11/3/2021

National Wetlands Inventory (NWI)

	Estuarine and Marine Deepwater		Freshwater Pond
	Estuarine and Marine Wetland		Lake
	Freshwater Emergent Wetland		Other
	Freshwater Forested/Shrub Wetland		Riverine
	Subject Property		Parcels

SJRWMD FLUCCS WETLANDS - 6000 Series MAP

FALSCROFT, JUSTIN M.

21Z00039

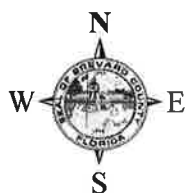
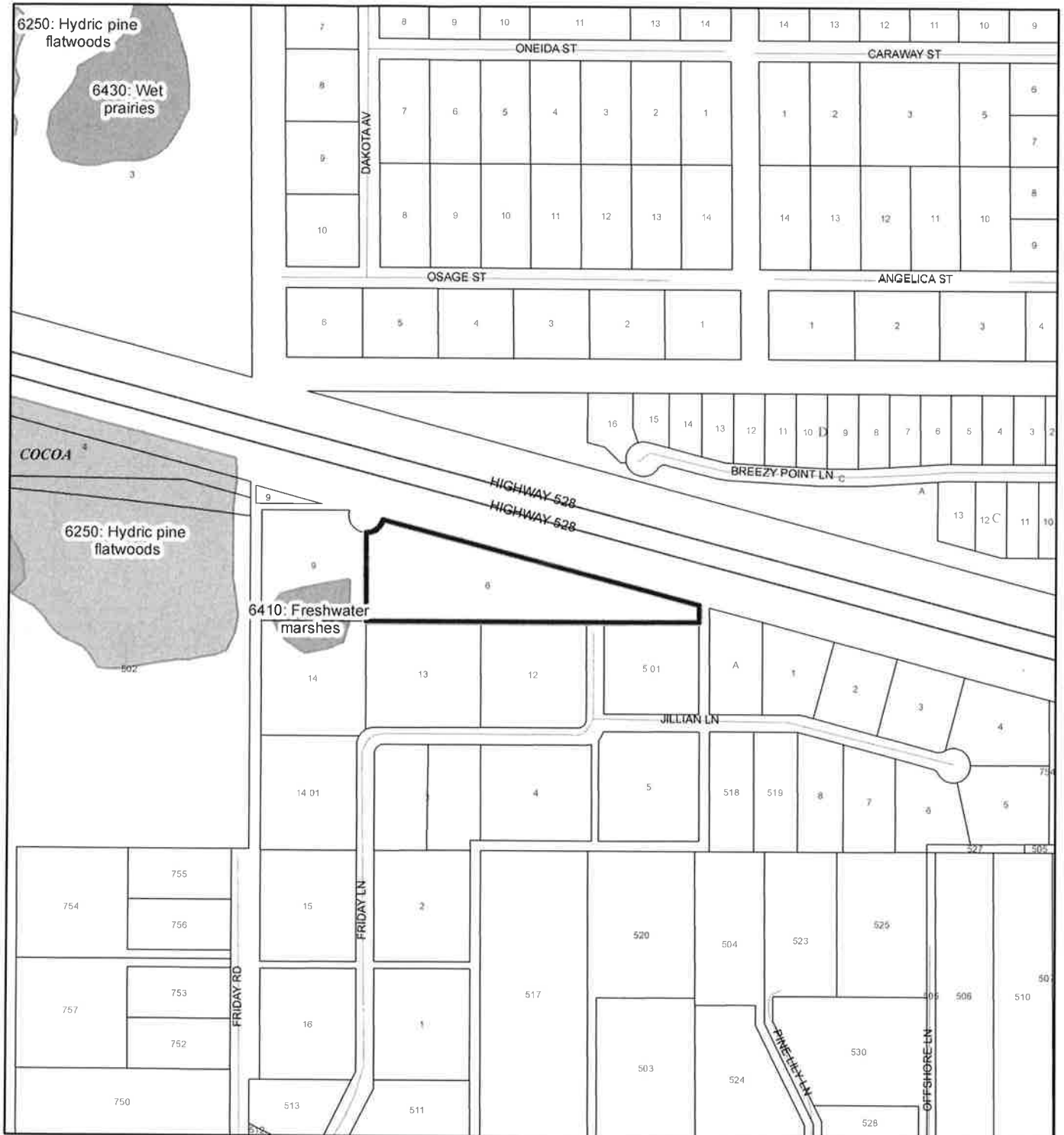

1:4,800 or 1 inch = 400 feet

This map was compiled from recorded documents and does not reflect an actual survey. The Brevard County Board of County Commissioners does not assume responsibility for errors or omissions hereon.

Produced by BoCC - GIS Date: 11/3/2021

SJRWMD FLUCCS WETLANDS





- Wetland Hardwood Forests - Series 6100
- Wetland Coniferous Forest - Series 6200
- Wetland Forested Mixed - Series 6300
- Vegetated Non-Forested Wetlands - Series 6400
- Non-Vegetated Wetland - Series 6500

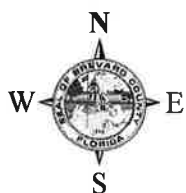

Subject Property Parcels

21Z00039



Produced by BoCC - GIS Date: 11/3/2021

 Aquifer and Hydric
 Aquifer
 Hydric
 None

 Subject Property
 Parcels

FEMA FLOOD ZONES MAP

FALSCROFT, JUSTIN M.

21Z00039

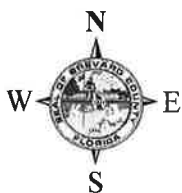

1:4,800 or 1 inch = 400 feet

This map was compiled from recorded documents and does not reflect an actual survey. The Brevard County Board of County Commissioners does not assume responsibility for errors or omissions hereon.

Produced by BoCC - GIS Date: 11/3/2021

FEMA Flood Zones

- | | | |
|------------------|------------|---|
| A | AO | X |
| AE | Open Water | |
| AH | VE | |
| Subject Property | Parcels | |

21Z00039

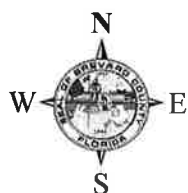

SurgeZoneCat1

INDIAN RIVER LAGOON SEPTIC OVERLAY MAP

FALSCROFT, JUSTIN M.

21Z00039

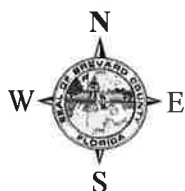

1:4,800 or 1 inch = 400 feet

This map was compiled from recorded documents and does not reflect an actual survey. The Brevard County Board of County Commissioners does not assume responsibility for errors or omissions hereon.

Produced by BoCC - GIS Date: 11/3/2021

 Subject Property

 Parcels

Septic Overlay

 40 Meters

 60 Meters

 All Distances

EAGLE NESTS MAP

FALSCROFT, JUSTIN M.

21Z00039

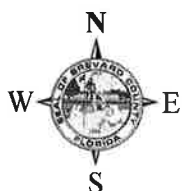

1:4,800 or 1 inch = 400 feet

This map was compiled from recorded documents and does not reflect an actual survey. The Brevard County Board of County Commissioners does not assume responsibility for errors or omissions hereon.

Produced by BoCC - GIS Date: 11/3/2021

 Subject Property

 Parcels

 Eagle Nests
FWS 2010

SCRUB JAY OCCUPANCY MAP

FALSCROFT, JUSTIN M.

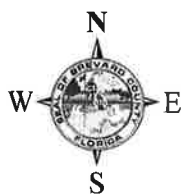

21Z00039



1:4,800 or 1 inch = 400 feet

This map was compiled from recorded documents and does not reflect an actual survey. The Brevard County Board of County Commissioners does not assume responsibility for errors or omissions hereon.

Produced by BoCC - GIS Date: 11/3/2021

-  Subject Property
-  Parcels
-  Scrub Jay Occupancy

SJRWMD FLUCCS UPLAND FORESTS - 4000 Series MAP

FALSCROFT, JUSTIN M.

21Z00039

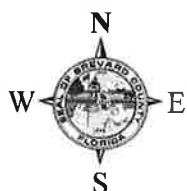
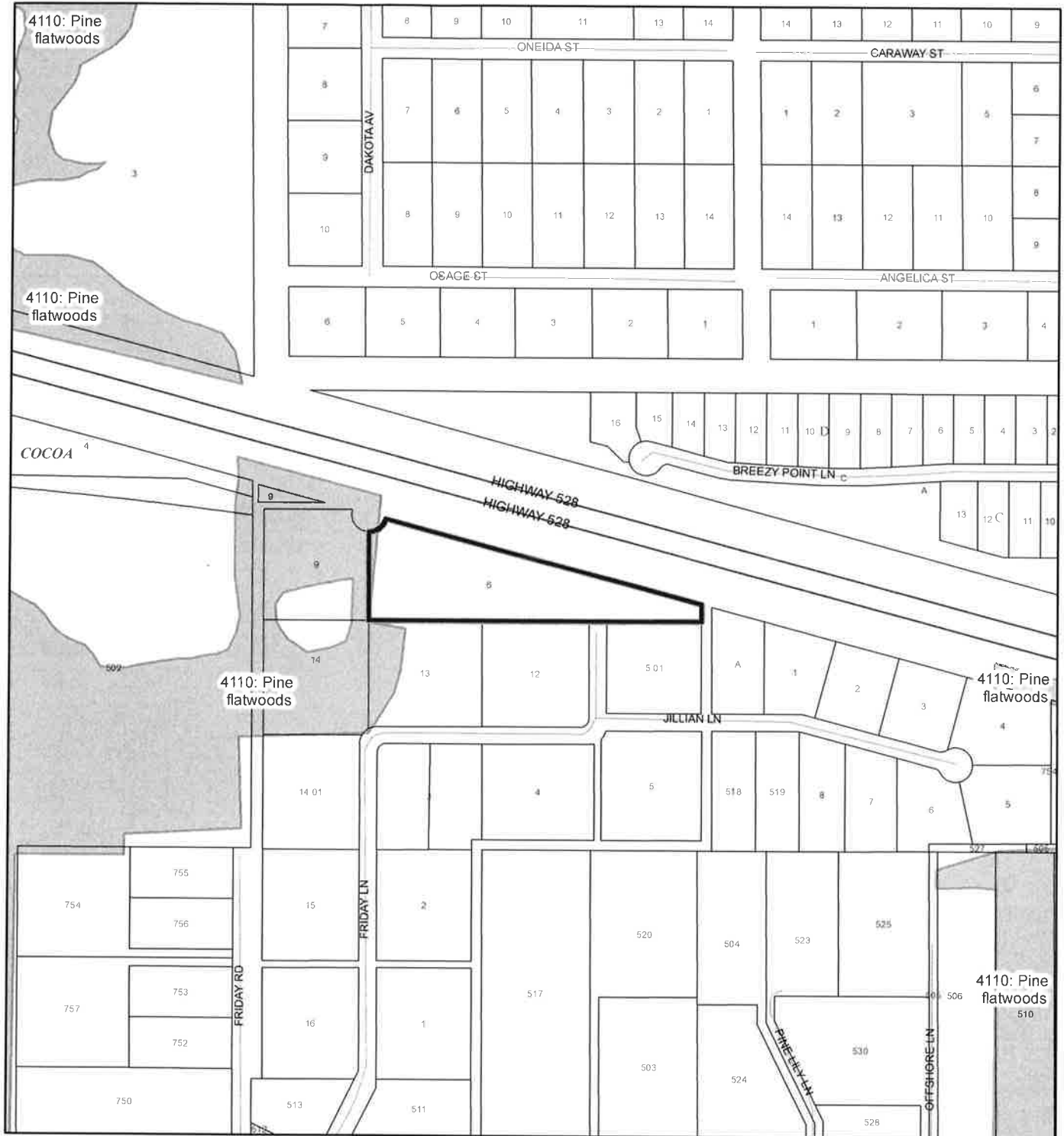

1:4,800 or 1 inch = 400 feet

This map was compiled from recorded documents and does not reflect an actual survey. The Brevard County Board of County Commissioners does not assume responsibility for errors or omissions hereon.

Produced by BoCC - GIS Date: 11/3/2021

SJRWMD FLUCCS Upland Forests

- Upland Coniferous Forest - 4100 Series
- Upland Hardwood Forest - 4200 Series
- Upland Mixed Forest - 4300 Series
- Tree Plantations - 4400 Series

Subject Property Parcels

PLANNING AND ZONING BOARD/LOCAL PLANNING AGENCY MINUTES

The Brevard County Planning & Zoning Board met in regular session on **Monday, January 10, 2022**, at **3:00 p.m.**, in the Florida Room, Building C, Brevard County Government Center, 2725 Judge Fran Jamieson Way, Viera, Florida.

The meeting was called to order at 3:00 p.m.

At the outset of the meeting, nine Board members were present and voted on all items on the agenda: Henry Minneboo (D1); Ron Bartcher (D1); Robert Sullivan (D2); Ben Glover (D3); William Capote (D3); Mark Wadsworth, Chair (D4); Liz Alward (D4); Peter Filiberto, Vice Chair (D5); and John Hoppengarten (BPS).

Bruce Moia (D5) was present for Items H.14 & H.15 only.

Lorraine Koss (D2 - Alt) was present, but did not participate from the dais.

Staff members present were: Tad Calkins, Planning & Development Director; Jeffrey Ball, Planning and Zoning Manager; George Ritchie, Planner III; Kyle Harris, Associate Planner; Virginia Barker, Natural Resources Management Director; Amanda Elmore, Natural Resources Management Deputy Director; Darcie McGee, Natural Resources Management Assistant Director; Alex Esseeesse, Assistant County Attorney; and Jennifer Jones, Special Projects Coordinator.

Excerpt from Complete Minutes

Justin M. Falscroft

A change of zoning classification from RR-1 (Rural Residential) to AU (Agricultural Residential). The property is 3.96 acres, located at the north end of Friday Rd., on the south side of S.R. 528. (3000 Friday Rd., Cocoa) (Tax Account 2404081) (District 1)

Justin Falscroft, 3000 Friday Lane, Cocoa, stated he would like a change of zoning specifically to utilize the 3.69 acres and build a shop to house horse trailers and other equipment. The size restrictions in RR-1 limits the size of shop he would like to build. He stated he has no interest in having any animals other than a horse or two.

No public comment.

Motion by Peter Filiberto, seconded by William Capote, to recommend approval of a change of zoning classification from RR-1 to AU. The motion passed unanimously.