



# Agenda Report

2725 Judge Fran Jamieson  
Way  
Viera, FL 32940

## Public Hearing

---

H.6.

4/6/2023

---

### Subject:

Half Halt Stables, LLP (Toni Pastermack) requests a change of zoning classification from AU to RU-1-9. (22Z00068) (Tax Account 2407648) (District 2)

### Fiscal Impact:

None

### Dept/Office:

Planning & Development

### Requested Action:

It is requested that the Board of County Commissioners conduct a public hearing to consider a change of zoning classification from AU (Agricultural Residential) to RU-1-9 (Single-Family Residential).

### Summary Explanation and Background:

The applicants are requesting a change of zoning classification from AU to RU-1-9 on a portion of their property in order to subdivide the a 0.33-acre portion in order to sell. The entire property consists of 12.28-acres with two zoning classifications, RR-1 (Rural Residential) and AU. The applicants combined two parcels creating two single-family homes on one parcel forming the current configuration. The intention is to separate them, putting them back in their original configuration.

The proposed RU-1-9 zoning classification permits single-family residential development on lots a minimum of 6,600 square feet, with a minimum width of 66 feet and a minimum depth of 100 feet, and a minimum living area of 900 square feet.

The character of the area is predominantly residential with lot sizes ranging from 1 acre to over 17.92 acres.

The Board may consider whether the proposed request is consistent and compatible with the surrounding area.

On March 13, 2023, the Planning & Zoning Board heard the request and unanimously recommended approval.

### Clerk to the Board Instructions:

Once the resolution is received, please execute and return a copy to Planning & Development.

**Resolution 22Z00068**

On motion by Commissioner Goodson, seconded by Commissioner Feltner, the following resolution was adopted by a unanimous vote:

**WHEREAS, Half Halt Stables, LLP** has requested a change of zoning classification from AU (Agricultural Residential) to RU-1-9 (Single-Family Residential), on property described as a part of the SW ¼ of the NW ¼ of the SE ¼ of **Section 25, Township 24S, Range 35E**, Brevard County, Florida, being more particularly described as follows: begin at the SW corner of the NW ¼ of the SE ¼ of said Section 25; thence for a first course run north along the west line of the NW ¼ of the SE ¼ of said Section 25, a distance of 105 ft.; thence for a second course, run N89deg15'41"E, parallel to the south line of the NW ¼ of the SE ¼ a distance of 168 ft.; thence for a third course, run south a distance of 105 ft.; thence for a fourth and final course, run S89deg15'41"W, a distance of 168 ft. to the point of beginning. Less 33 ft. of road right-of-way for Burnett Rd. (0.33 acres) Located on the east side of Burnett Rd., approx. 0.25 mile north of Lake Dr. (525 & 655 N. Burnett Rd., Cocoa); and

**WHEREAS**, a public hearing of the Brevard County Planning and Zoning Board was advertised and held, as required by law, and after hearing all interested parties and considering the adjacent areas, the Brevard County Planning and Zoning Board recommended that the application be approved; and

**WHEREAS**, the Board, after considering said application and the Planning and Zoning Board's recommendation, and hearing all interested parties, and after due and proper consideration having been given to the matter, find that the application should be approved as recommended; now therefore,

**BE IT RESOLVED** by the Board of County Commissioners of Brevard County, Florida, that the requested change of zoning classification from AU to RU-1-9 be approved. The Planning and Development Director, or designee, is hereby directed to make this change on the official zoning maps of Brevard County, Florida.

**BE IT FURTHER RESOLVED** that this resolution shall become effective as of April 6, 2023.

BOARD OF COUNTY COMMISSIONERS  
Brevard County, Florida

Rita Pritchett, Chair  
Brevard County Commission  
As approved by the Board on April 6, 2023.



ATTEST:

RACHEL SADOFF, CLERK

(SEAL)



P&Z Board Hearing – March 13, 2023

Please note: A CUP (Conditional Use Permit) will generally expire on the three-year anniversary of its approval if the use is not established prior to that date. CUPs for Towers and Antennas shall expire if a site plan for the tower is not submitted within one year of approval or if construction does not commence within two years of approval. A Planned Unit Development Preliminary Development Plan expires if a final development plan is not filed within three years. **The granting of this zoning does not guarantee physical development of the property. At the time of development, said development must be in accordance with the criteria of the Brevard County Comprehensive Plan and other applicable laws and ordinances.**

## **ADMINISTRATIVE POLICIES OF THE FUTURE LAND USE ELEMENT**

Administrative Policies in the Future Land Use Element establish the expertise of staff with regard to zoning land use issues and set forth criteria when considering a rezoning action or request for Conditional Use Permit, as follows:

### **Administrative Policy 1**

The Brevard County zoning official, planners and the Director of the Planning and Development, however designated, are recognized as expert witnesses for the purposes of Comprehensive Plan amendments as well as zoning, conditional use, special exception, and variance applications.

### **Administrative Policy 2**

Upon Board request, members of the Brevard County planning and zoning staff shall be required to present written analysis and a recommendation, which shall constitute an expert opinion, on all applications for zoning, conditional uses, comprehensive plan amendments, vested rights, or other applications for development approval that come before the Board of County Commissioners for quasi-judicial review and action. The Board may table an item if additional time is required to obtain the analysis requested or to hire an expert witness if the Board deems such action appropriate. Staff input may include the following:

#### **Criteria:**

- A. Staff shall analyze an application for consistency or compliance with comprehensive plan policies, zoning approval criteria and other applicable written standards.
- B. Staff shall conduct site visits of property which are the subject of analysis and recommendation. As part of the site visit, the staff shall take a videotape or photographs where helpful to the analysis and conduct an inventory of surrounding existing uses. Aerial photographs shall also be used where they would aid in an understanding of the issues of the case.
- C. In cases where staff analysis is required, both the applicant and the staff shall present proposed findings of fact for consideration by the Board.
- D. For development applications where a specific use has not been proposed, the worst case adverse impacts of potential uses available under the applicable land use classification shall be evaluated by the staff.

### **Administrative Policy 3**

Compatibility with existing or proposed land uses shall be a factor in determining where a rezoning or any application involving a specific proposed use is being considered. Compatibility shall be evaluated by considering the following factors, at a minimum:

#### **Criteria:**

- A. Whether the proposed use(s) would have hours of operation, lighting, odor, noise levels, traffic, or site activity that would significantly diminish the enjoyment of, safety or quality of life in existing neighborhoods within the area which could foreseeably be affected by the proposed use.

- B. Whether the proposed use(s) would cause a material reduction (five percent or more) in the value of existing abutting lands or approved development.
- C. Whether the proposed use(s) is/are consistent with an emerging or existing pattern of surrounding development as determined through analysis of:
  - 1. historical land use patterns;
  - 2. actual development over the immediately preceding three years; and
  - 3. development approved within the past three years but not yet constructed.
- D. Whether the proposed use(s) would result in a material violation of relevant policies in any elements of the Comprehensive Plan.

**Administrative Policy 4**

Character of a neighborhood or area shall be a factor for consideration whenever a rezoning or any application involving a specific proposed use is reviewed. The character of the area must not be materially or adversely affected by the proposed rezoning or land use application. In evaluating the character of an area, the following factors shall be considered:

**Criteria:**

- A. The proposed use must not materially and adversely impact an established residential neighborhood by introducing types of intensity of traffic (including but not limited to volume, time of day of traffic activity, type of vehicles, et cetera), parking, trip generation, commercial activity or industrial activity that is not already present within the identified boundaries of the neighborhood.
- B. In determining whether an established residential neighborhood exists, the following factors must be present:
  - 1. The area must have clearly established boundaries, such as roads, open spaces, rivers, lakes, lagoons, or similar features.
  - 2. Sporadic or occasional neighborhood commercial uses shall not preclude the existence of an existing residential neighborhood, particularly if the commercial use is non-conforming or pre-dates the surrounding residential use.
  - 3. An area shall be presumed not to be primarily residential but shall be deemed transitional where multiple commercial, industrial or other non-residential uses have been applied for and approved during the previous five (5) years.

**Administrative Policy 5**

In addition to the factors specified in Administrative Policies 2, 3, and 4, in reviewing a rezoning, conditional use permit or other application for development approval, the impact of the proposed use or uses on transportation facilities either serving the site or impacted by the

use(s) shall be considered. In evaluating whether substantial and adverse transportation impacts are likely to result if an application is approved, the staff shall consider the following:

**Criteria:**

- A. Whether adopted levels of services will be compromised;
- B. Whether the physical quality of the existing road system that will serve the proposed use(s) is sufficient to support the use(s) without significant deterioration;
- C. Whether the surrounding existing road system is of sufficient width and construction quality to serve the proposed use(s) without the need for substantial public improvements;
- D. Whether the surrounding existing road system is of such width and construction quality that the proposed use(s) would realistically pose a potential for material danger to public safety in the surrounding area;
- E. Whether the proposed use(s) would be likely to result in such a material and adverse change in traffic capacity of a road or roads in the surrounding area such that either design capacities would be significantly exceeded or a de facto change in functional classification would result;
- F. Whether the proposed use(s) would cause such material and adverse changes in the types of traffic that would be generated on the surrounding road system, that physical deterioration of the surrounding road system would be likely;
- G. Whether projected traffic impacts of the proposed use(s) would materially and adversely impact the safety or welfare of residents in existing residential neighborhoods.

**Administrative Policy 6**

The use(s) proposed under the rezoning, conditional use or other application for development approval must be consistent with, (a), all written land development policies set forth in these administrative policies; and (b), the future land use element, coastal management element, conservation element, potable water element, sanitary sewer element, solid waste management element, capital improvements element, recreation and open space element, surface water element, and transportation elements of the comprehensive plan.

**Administrative Policy 7**

Proposed use(s) shall not cause or substantially aggravate any, (a), substantial drainage problem on surrounding properties; or (b), significant, adverse and unmitigatable impact on significant natural wetlands, water bodies or habitat for listed species.

**Administrative Policy 8**

These policies, the staff analysis based upon these policies, and the applicant's written analysis, if any, shall be incorporated into the record of every quasi-judicial review application for development approval presented to the Board including rezoning, conditional use permits, and vested rights determinations.

Section 62-1151(c) of the Code of Ordinances of Brevard County directs, "The planning and zoning board shall recommend to the board of county commissioners the denial or approval of each application for amendment to the official zoning maps based upon a consideration of the following factors:

- (1) The character of the land use of the property surrounding the property being considered.
- (2) The change in conditions of the land use of the property being considered and the surrounding property since the establishment of the current applicable zoning classification, special use or conditional use.
- (3) The impact of the proposed zoning classification or conditional use on available and projected traffic patterns, water and sewer systems, other public facilities and utilities and the established character of the surrounding property.
- (4) The compatibility of the proposed zoning classification or conditional use with existing land use plans for the affected area.
- (5) The appropriateness of the proposed zoning classification or conditional use based upon a consideration of the applicable provisions and conditions contained in this article and other applicable laws, ordinances and regulations relating to zoning and land use regulations and based upon a consideration of the public health, safety and welfare.

The minutes of the planning and zoning board shall specify the reasons for the recommendation of approval or denial of each application."

#### **CONDITIONAL USE PERMITS (CUPs)**

In addition to the specific requirements for each Conditional Use Permit (CUP), Section 62-1901 provides that the following approval procedure and general standards of review are to be applied to all CUP requests, as applicable.

- (b) Approval procedure. An application for a specific conditional use within the applicable zoning classification shall be submitted and considered in the same manner and according to the same procedure as an amendment to the official zoning map as specified in Section 62-1151. The approval of a conditional use shall authorize an additional use for the affected parcel of real property in addition to those permitted in the applicable zoning classification. The initial burden is on the applicant to demonstrate that all applicable standards and criteria are met. Applications which do not satisfy this burden cannot be approved. If the applicant meets its initial burden, then the Board has the burden to show, by substantial and competent evidence, that the applicant has failed to meet such standards and the request is adverse to the public interest. As part of the approval of the conditional use permit, the Board may prescribe appropriate and reasonable conditions and safeguards to reduce the impact of the proposed use on adjacent and nearby properties or the neighborhood. A nearby property, for the purpose of this section, is defined as any property which, because of the character of the proposed use, lies within the area which may be substantially and adversely impacted by such use. In stating grounds in

support of an application for a conditional use permit, it is necessary to show how the request fulfills both the general and specific standards for review. The applicant must show the effect the granting of the conditional use permit will have on adjacent and nearby properties, including, but not limited to traffic and pedestrian flow and safety, curb-cuts, off-street loading and parking, off-street pickup of passengers, odors, glare and noise, particulates, smoke, fumes, and other emissions, refuse and service areas, drainage, screening and buffering for protection of adjacent and nearby properties, and open space and economic impact on nearby properties. The applicant, at his discretion, may choose to present expert testimony where necessary to show the effect of granting the conditional use permit.

(c) General Standards of Review.

- (1) The planning and zoning board and the board of county commissioners shall base the denial or approval of each application for a conditional use based upon a consideration of the factors specified in Section 62-1151(c) plus a determination whether an application meets the intent of this section.
  - a. The proposed conditional use will not result in a substantial and adverse impact on adjacent and nearby properties due to: (1), the number of persons anticipated to be using, residing or working under the conditional use; (2), noise, odor, particulates, smoke, fumes and other emissions, or other nuisance activities generated by the conditional use; or (3), the increase of traffic within the vicinity caused by the proposed conditional use.
  - b. The proposed use will be compatible with the character of adjacent and nearby properties with regard to use, function, operation, hours of operation, type and amount of traffic generated, building size and setback, and parking availability.
  - c. The proposed use will not cause a substantial diminution in value of abutting residential property. A substantial diminution shall be irrebuttably presumed to have occurred if abutting property suffers a 15% reduction in value as a result of the proposed conditional use. A reduction of 10% of the value of abutting property shall create a rebuttable presumption that a substantial diminution has occurred. The Board of County Commissioners carries the burden to show, as evidenced by either testimony from or an appraisal conducted by an M A I certified appraiser, that a substantial diminution in value would occur. The applicant may rebut the findings with his own expert witnesses.
- (2) The following specific standards shall be considered, when applicable, in making a determination that the general standards specified in subsection (1) of this section are satisfied:

- a. Ingress and egress to the property and proposed structures thereon, with particular reference to automotive and pedestrian safety and convenience, traffic flow and control, and access in case of fire and catastrophe, shall be: (1), adequate to serve the proposed use without burdening adjacent and nearby uses, and (2), built to applicable county standards, if any. Burdening adjacent and nearby uses means increasing existing traffic on the closest collector or arterial road by more than 20%, or 10% if the new traffic is primarily comprised of heavy vehicles, except where the affected road is at Level of Service A or B. New traffic generated by the proposed use shall not cause the adopted level of service for transportation on applicable roadways, as determined by applicable Brevard County standards, to be exceeded. Where the design of a public road to be used by the proposed use is physically inadequate to handle the numbers, types or weights of vehicles expected to be generated by the proposed use without damage to the road, the conditional use permit cannot be approved without a commitment to improve the road to a standard adequate to handle the proposed traffic, or to maintain the road through a maintenance bond or other means as required by the Board of County Commissioners.
- b. The noise, glare, odor, particulates, smoke, fumes or other emissions from the conditional use shall not substantially interfere with the use or enjoyment of the adjacent and nearby property.
- c. Noise levels for a conditional use are governed by Section 62-2271.
- d. The proposed conditional use shall not cause the adopted level of service for solid waste disposal applicable to the property or area covered by such level of service, to be exceeded.
- e. The proposed conditional use shall not cause the adopted level of service for potable water or wastewater applicable to the property or the area covered by such level of service, to be exceeded by the proposed use.
- f. The proposed conditional use must have existing or proposed screening or buffering, with reference to type, dimensions and character to eliminate or reduce substantial, adverse nuisance, sight, or noise impacts on adjacent and nearby properties containing less intensive uses.
- g. Proposed signs and exterior lighting shall not cause unreasonable glare or hazard to traffic safety, or interference with the use or enjoyment of adjacent and nearby properties.
- h. Hours of operation of the proposed use shall be consistent with the use and enjoyment of the properties in the surrounding residential community, if any. For commercial and industrial uses adjacent to or near residential uses, the hours of operation shall not adversely affect the use and enjoyment of the residential character of the area.
- i. The height of the proposed use shall be compatible with the character of the area, and the maximum height of any habitable structure shall be not more than 35 feet higher than the highest residence within 1,000 feet of the property line.



- j. Off-street parking and loading areas, where required, shall not be created or maintained in a manner which adversely impacts or impairs the use and enjoyment of adjacent and nearby properties. For existing structures, the applicant shall provide competent, substantial evidence to demonstrate that actual or anticipated parking shall not be greater than that which is approved as part of the site plan under applicable county standards.

**FACTORS TO CONSIDER FOR A REZONING REQUEST**

Section 62-1151(c) sets forth factors to consider in connection with a rezoning request, as follows:

“The planning and zoning board shall recommend to the board of county commissioners the denial or approval of each application for amendment to the official zoning maps based upon a consideration of the following factors:

- (1) The character of the land use of the property surrounding the property being considered.
- (2) The change in conditions of the land use of the property being considered and the surrounding property since the establishment of the current applicable zoning classification, special use or conditional use.
- (3) The impact of the proposed zoning classification or conditional use on available and projected traffic patterns, water and sewer systems, other public facilities and utilities and the established character of the surrounding property.
- (4) The compatibility of the proposed zoning classification or conditional use with existing land use plans for the affected area.
- (5) The appropriateness of the proposed zoning classification or conditional use based upon a consideration of the applicable provisions and conditions contained in this article and other applicable laws, ordinances and regulations relating to zoning and land use regulations and based upon a consideration of the public health, safety and welfare.”

These staff comments contain references to zoning classifications found in the Brevard County Zoning Regulations, Chapter 62, Article VI, Code of Ordinances of Brevard County. These references include brief summaries of some of the characteristics of that zoning classification. Reference to each zoning classification shall be deemed to incorporate the full text of the section or sections defining and regulating that classification into the Zoning file and Public Record for that item.

These staff comments contain references to sections of the Code of Ordinances of Brevard County. Reference to each code section shall be deemed to incorporate this section into the Zoning file and Public Record for that item.

These staff comments contain references to Policies of the Brevard County Comprehensive Plan. Reference to each Policy shall be deemed to incorporate the entire Policy into the Zoning file and Public Record for that item.

These staff comments refer to previous zoning actions which are part of the Public Records of Brevard County, Florida. These records will be referred to by reference to the file number. Reference to zoning files are intended to make the entire contents of the cited file a part of the Zoning file and Public Record for that item.

#### DEFINITIONS OF CONCURRENCY TERMS

**Maximum Acceptable Volume (MAV):** Maximum acceptable daily volume that a roadway can carry at the adopted Level of Service (LOS).

**Current Volume:** Building permit related trips added to the latest TPO (Transportation Planning Organization) traffic counts.

**Volume with Development (VOL W/DEV):** Equals Current Volume plus trip generation projected for the proposed development.

**Volume/Maximum Acceptable Volume (VOL/MAV):** Equals the ratio of current traffic volume to the maximum acceptable roadway volume.

**Volume/Maximum Acceptable Volume with Development (VOL/MAV W/DEV):** Ratio of volume with development to the Maximum Acceptable Volume.

**Acceptable Level of Service (CURRENT LOS):** The Level of Service at which a roadway is currently operating.

**Level of Service with Development (LOS W/DEV):** The Level of Service that a proposed development may generate on a roadway.



BOARD OF COUNTY COMMISSIONERS

**Planning and Development Department**

2725 Judge Fran Jamieson Way  
 Building A, Room 114  
 Viera, Florida 32940  
 (321)633-2070 Phone / (321)633-2074 Fax  
<https://www.brevardfl.gov/PlanningDev>

**STAFF COMMENTS  
 22Z00068**

**Half Halt Stables, LLP**

**AU (Agricultural Residential) to RU-1-9 (Single-Family Residential)**

Tax Account Number: 2407648  
 Parcel I.D.s: 24-35-25-00-768  
 Location: East side of Burnett Road, 1,310-feet north of Lake Drive (District 2)  
 Acreage: 0.33 acres  
 Planning & Zoning Board: 03/13/2023  
 Board of County Commissioners: 04/06/2023

**Consistency with Land Use Regulations**

- Current zoning can be considered under the Future Land Use Designation, Section 62-1255.
- The proposal can be considered under the Future Land Use Designation, Section 62-1255.
- The proposal would maintain acceptable Levels of Service (LOS) (XIII 1.6.C)

	<b>CURRENT</b>	<b>PROPOSED</b>
<b>Zoning</b>	AU	RU-1-9
<b>Potential*</b>	2 SF Units	1 SF unit
<b>Can be Considered under the Future Land Use Map</b>	YES RES 15	YES RES 15

\* Zoning potential for concurrency analysis purposes only, subject to applicable land development regulations.

**Background and Purpose of Request**

The applicants are requesting a change of zoning classification from AU (Agricultural Residential) to RU-1-9 (Single-family Residential) on a portion of their property in order to subdivide the parcel on 0.33-acre parcel and sell. The entire property consists of 12.28-acres with two zoning classifications, RR-1 (Rural Residential) and AU (Agricultural Residential). The applicants combined two parcels creating two single-family homes on one parcel forming the current configuration. The intention is to separate them, putting them back in their original configuration.

The original zoning on the property was GU and under zoning resolution **Z-2145** was changed to AU in September 1967. There were two prior denied zoning requests, **Z-6538** was a request to change from AU to RR-1 November 17, 1983 and then **Z-5510** was a request to change from AU to RU-1-9 January 1981.

## **Land Use**

The subject property is currently designated Residential 15 (RES 15). Both the AU and RU-1-9 zoning classifications are consistent with the Residential 15 FLU designation.

## **Applicable Land Use Policies**

### **FLUE Policy 1.2 – Public Facilities and Services Requirements**

Minimum public facilities and services requirements should increase as residential density allowances become higher. The following criteria shall serve as guidelines for approving new residential land use designations:

#### **Criteria:**

- A. Adequate roadways, solid waste disposal, drainage and recreation facilities to serve the needs of associated development shall be available concurrent with development in all residential land use designations.
- B. Fire and police protection and emergency medical services to serve the needs of associated development shall be available concurrent with development in all residential land use designations in accordance with policies set forth in the "Service Delivery, Concurrency and Growth" section of this Future Land Use Element.
- C. In the Residential 30 Directive, Residential 15, Residential 10, Residential 6 and Residential 4 land use designations, centralized potable water and wastewater treatment shall be available concurrent with the impact of the development.
- D. Where public water service is available, residential development proposals with densities greater than four units per acre shall be required to connect to a centralized sewer system.
- E. Where public water service is not available, residential development proposals with densities greater than two units per acre shall be required to connect to centralized sewer system.

**FLUE Policy 1.4 –** The Residential 15 land use designation affords the second highest density allowance, permitting a maximum density of up to fifteen (15) units per acre. The Residential 15 land use designation may be considered for lands within the following generalized locations:

#### **Criteria:**

- A. Areas located east of Interstate-95, except in instances where they are adjacent to existing or designated residential densities of an equal or higher density allowance; and
- B. Unincorporated areas which are adjacent to incorporated areas and may be considered a logical transition for Residential 15 area;

- C. Areas adjacent to an existing Residential 15 land use designation; and
- D. Areas which have access to an arterial or collector roadway, without impacting existing or designated lower density/intensity areas.

**Analysis of Administrative Policy #3 - Compatibility between this site and the existing or proposed land uses in the area.**

Compatibility shall be evaluated by considering the following factors, at a minimum:

Criteria:

- A. Whether the proposed use(s) would have hours of operation, lighting, odor, noise levels, traffic, or site activity that would significantly diminish the enjoyment of, safety or quality of life in existing neighborhoods within the area which could foreseeably be affected by the proposed use;

**A single-family residence is not anticipated to have hours of operation, lighting, odor, noise levels, traffic or site activity that would significantly diminish the enjoyment of, safety or quality of life in existing neighborhoods within the area. There would be no change to it's current use.**

- B. Whether the proposed use(s) would cause a material reduction (five per cent or more) in the value of existing abutting lands or approved development.

**Only a certified MAI (Master Appraisal Institute) appraisal can determine if material reduction has or will occur due to the proposed request.**

- C. Whether the proposed use(s) is/are consistent with an emerging or existing pattern of surrounding development as determined through an analysis of:

- 1. historical land use patterns;

**The property is developed with a Residential 15 (RES 15) FLU. There are two (2) Brevard County FLU designations (RES 15 and NC) within 500-feet of this site. The NC FLU designation is located to the south east off Gray Road. The proposed RU-1-9 zoning is consistent with the existing RES 15 FLU designation.**

- 2. actual development over the immediately preceding three years; and

**There has been one single-family residence located to the northwest of the subject property off Brush Lane, application 20BC25757, approved December 22, 2020.**

- 3. development approved within the past three years but not yet constructed.

**There has not been any approved development but not yet constructed within this area in the preceding three (3) years.**

- D. Whether the proposed use(s) would result in a material violation of relevant policies in any elements of the Comprehensive Plan.

**No material violation of relevant policies has been identified.**

**Analysis of Administrative Policy #4 - Character of a neighborhood or area.**

Character of a neighborhood or area shall be a factor for consideration whenever a rezoning or any application involving a specific proposed use is reviewed. The character of the area must not be materially or adversely affected by the proposed rezoning or land use application. In evaluating the character of an area, the following factors shall be considered:

**Criteria:**

- A. The proposed use must not materially and adversely impact an established residential neighborhood by introducing types or intensity of traffic (including but not limited to volume, time of day of traffic activity, type of vehicles, etc.), parking, trip generation, commercial activity or industrial activity that is not already present within the identified boundaries of the neighborhood.

**The character of the area is predominantly residential with zoning classifications of AU, GU, RR-1, RU-2-8 and RU-2-15 (11). The lot sizes range from 1.0-acre to over 17.92-acre lot sizes. This portion of the parcel abuts N. Burnett Road to the west. The undeveloped parcel to the south is zoned RU-2-15 (11). To the north and east the zoning is AU as well as RR-1 and is the main parcel that the subject property is being requested to be portioned from.**

**The use could be considered an introduction of RU-1-9 on the southern east portion of N Burnett Road. The RU-1-9 zoning classification allows for a lot size of 6,600 square feet.**

- B. In determining whether an established residential neighborhood exists, the following factors must be present:
1. The area must have clearly established boundaries, such as roads, open spaces, rivers, lakes, lagoons, or similar features.

**This developed parcel is located in a residential area on the outskirts of Cocoa.**

2. Sporadic or occasional neighborhood commercial uses shall not preclude the existence of an existing residential neighborhood, particularly if the commercial use is non-conforming or pre-dates the surrounding residential use.

**The request is not for commercial use.**

3. An area shall be presumed not to be primarily residential but shall be deemed transitional where multiple commercial, industrial or other non-residential uses have been applied for and approved during the previous five (5) years.

**There have been no zoning changes within 0.5-miles of the subject property within the last 5 years.**

**Surrounding Area**

	<b>Existing Land Use</b>	<b>Zoning</b>	<b>Future Land Use</b>
<b>North</b>	Single-family and Undeveloped	RR-1	RES 15
<b>South</b>	Undeveloped	RU-2-15 (11)	RES 15
<b>East</b>	Single-family and Undeveloped	AU & GU	RES 15
<b>West</b>	N Burnett Road	N/A	N/A

The current AU zoning classification permits single-family residences and agricultural uses on 2.5 acre lots, with a minimum lot width and depth of 150 feet. The minimum house size in AU is 750 square feet. The AU classification also permits the raising/grazing of animals and plants nurseries. Conditional uses in AU include hog farms, zoological parks, and land alteration.

The proposed RU-1-9 classification permits single family residential development on lots of 6,600 square feet (minimum). The minimum house size is 900 square feet.

RR-1 zoning classification permits single-family residential land uses on a minimum one-acre lot, with a minimum lot width and depth of 125 feet. The RR-1 classification permits horses, barns and horticulture as accessory uses to a single-family residence. The minimum house size is 1,200 square feet.

RU-2-15 (11) zoning classification is a 11 unit per acre multiple-family residential zoning classification. It permits multiple-family residential development or single-family residences at a density of up to 11 units per acre on 7,500 square foot lots.

The GU zoning classification is a holding category allowing single-family residences on five-acre lots with a minimum width and depth of 300-feet. The minimum house size in GU is 750 square feet.

There has been no zoning action within a half-mile radius of the subject property within the last three years.

**Preliminary Concurrence**

The closest concurrency management segment to the subject property is Lake Drive, between Cox Road to Range Road, which has a Maximum Acceptable Volume (MAV) of 17,700 trips per day, a Level of Service (LOS) of D, and currently operates at 18.64% of capacity daily. As there is already a SFR on the proposed rezoning parcel, the maximum development potential from the proposed rezoning would not increase the percentage of MAV utilization. The corridor would continue to operate at 18.64% of capacity daily. The proposal is not anticipated to create a deficiency in LOS.

No school concurrency information has been provided as the development potential of this site falls below the minimum number of new residential lots that would require a formal review.

The site is currently developed. The subject property has potable water through the City of Cocoa. There does not appear to be any access to city or county sewer. This parcel is on septic.

### **Environmental Constraints**

- Hydric Soils
- Aquifer Recharge Soils

NRM reserves the right to assess consistency with environmental ordinances at all applicable future stages of development.

### **For Board Consideration**

The Board may wish to consider whether the proposed request is consistent and compatible with the surrounding area.



**NATURAL RESOURCES MANAGEMENT (NRM) DEPARTMENT  
Zoning Review & Summary**

**Item #22Z00068**

**Applicant:** Antonia Pastermack

**Zoning Request:** AU to RU-1-9

**Note:** Applicant wants to subdivide a portion of 0.33 acres from the 12.28-acre property to allow for the sale of an existing single-family home on the property.

**P&Z Hearing Date:** 03/13/23; **BCC Hearing Date:** 04/06/2023

**Tax ID No:** Portion of 2407648

- This is a preliminary review based on best available data maps reviewed by the Natural Resources Management Department (NRM) and does not include a site inspection to verify the accuracy of the mapped information.
- In that the rezoning process is not the appropriate venue for site plan review, specific site designs submitted with the rezoning request will be deemed conceptual. Board comments relative to specific site design do not provide vested rights or waivers from Federal, State or County regulations.
- **This review does not guarantee whether or not the proposed use, specific site design, or development of the property can be permitted under current Federal, State, or County Regulations.**

**Summary of Mapped Resources and Noteworthy Land Use Issues:**

- Hydric Soils
- Aquifer Recharge Soils

NRM reserves the right to assess consistency with environmental ordinances at all applicable future stages of development.

**Land Use Comments:**

**Hydric Soils**

The entire subject parcel contains mapped hydric soils (Pompano sand), as shown on the USDA Soil Conservation Service Soils Survey map; an indicator that hydric soils and wetlands may be present on the property. A wetland determination may be required for further development and/or clearing. Per Section 62-3694(c)(1), residential land uses within wetlands shall be limited to not more than one (1) dwelling unit per five (5) acres unless strict application of this policy renders a legally established parcel as of September 9, 1988, which is less than five (5) acres, as unbuildable. For multi-family parcels greater than five acres in area, the preceding limitation of one dwelling unit per five (5) acres within wetlands may be applied as a maximum percentage limiting wetland impacts to not more than 1.8% of the total non-commercial and non-industrial acreage on a cumulative basis as set forth in Section 65-3694(c)(6). Any permitted wetland impacts must meet the requirements of Section 62-3694(e) including avoidance of impacts, and will require mitigation in accordance with Section 62-3696. Wetland impacts are not allowed for accessory structures. The applicant is encouraged to contact NRM at 321-633-2016 prior to any plan or permit submittal.

#### **Aquifer Recharge Soils**

Pompano sand may also function as an aquifer recharge soil. The applicant is hereby notified of the development and impervious restrictions within Conservation Element Policy 10.2 and the Aquifer Protection Ordinance.

#### **Protected and Specimen Trees**

The applicant is advised to refer to Article XIII, Division 2, entitled Land Clearing, Landscaping, and Tree Protection, for specific requirements for preservation and canopy coverage and minimum landscaping requirements. Applicant should contact NRM at 321-633-2016 prior to performing any land clearing activities.

#### **Protected Species**

Prior to any plan, permit submittal, or development activity, including land clearing, the applicant should obtain any necessary permits or clearance letters from the Florida Fish and Wildlife Conservation Commission and/or U.S. Fish and Wildlife Service, as applicable.

# LOCATION MAP

Half Halt Stables  
22Z00068

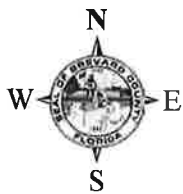
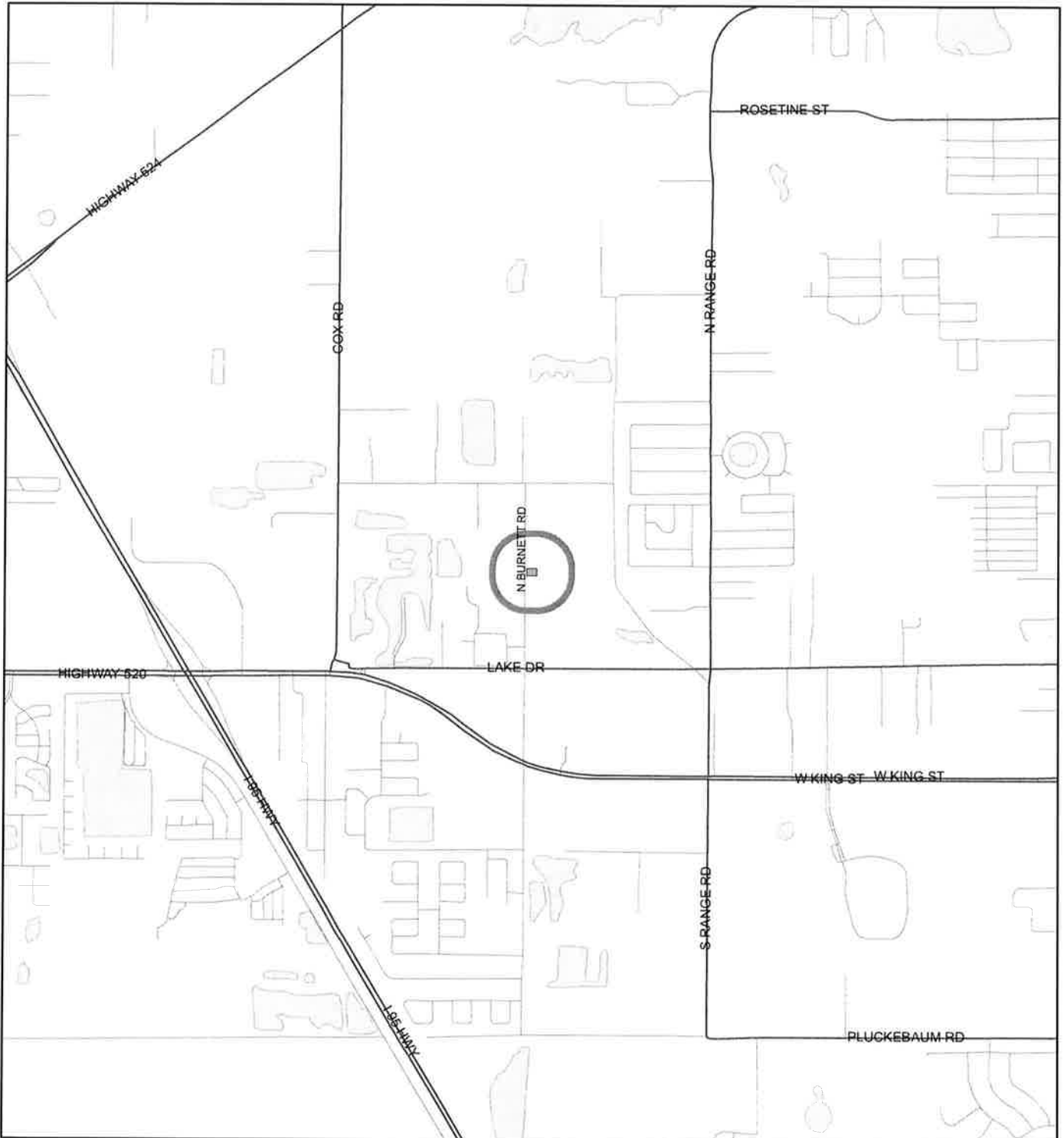



1:24,000 or 1 inch = 2,000 feet

Buffer Distance: 500 feet

This map was compiled from recorded documents and does not reflect an actual survey. The Brevard County Board of County Commissioners does not assume responsibility for errors or omissions hereon.

Produced by BoCC - GIS Date: 1/5/2023

-  Buffer
-  Subject Property

# ZONING MAP

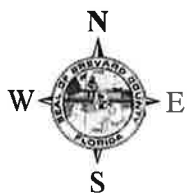
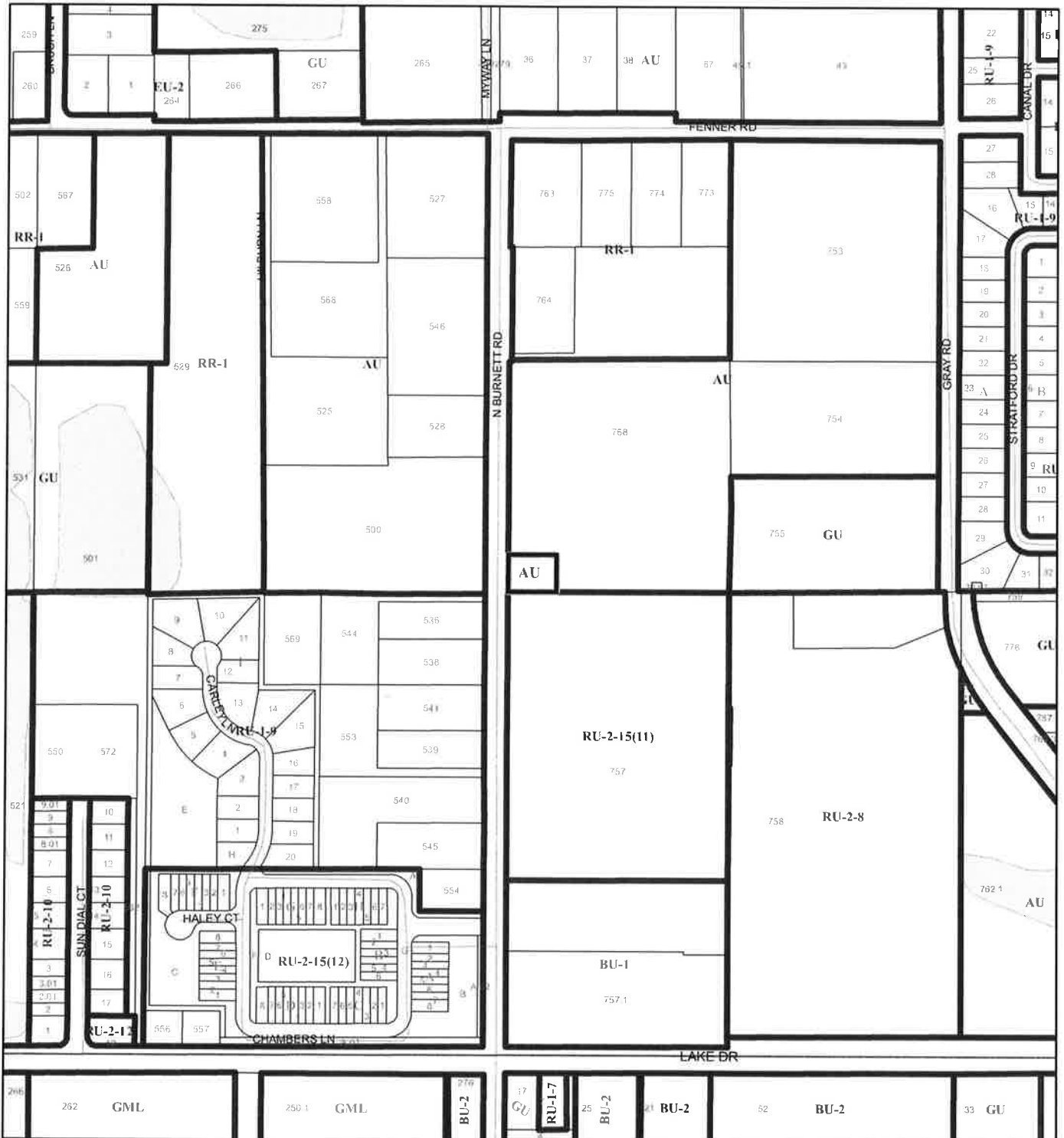

Half Halt Stables  
22Z00068



1:4,800 or 1 inch = 400 feet

This map was compiled from recorded documents and does not reflect an actual survey. The Brevard County Board of County Commissioners does not assume responsibility for errors or omissions hereon.

Produced by BoCC - GIS Date: 1/3/2023

-  Subject Property
-  Parcels
-  Zoning

# FUTURE LAND USE MAP

Half Halt Stables  
22Z00068

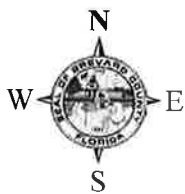

1:4,800 or 1 inch = 400 feet

— Subject Property  
 □ Parcels

This map was compiled from recorded documents and does not reflect an actual survey. The Brevard County Board of County Commissioners does not assume responsibility for errors or omissions hereon.

Produced by BoCC - GIS Date: 1/3/2023

# AERIAL MAP

Half Halt Stables  
22Z00068

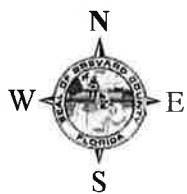



1:2,400 or 1 inch = 200 feet

PHOTO YEAR: 2022

This map was compiled from recorded documents and does not reflect an actual survey. The Brevard County Board of County Commissioners does not assume responsibility for errors or omissions hereon.

Produced by BoCC - GIS Date: 1/3/2023

-  Subject Property
-  Parcels

# NWI WETLANDS MAP

Half Halt Stables  
22Z00068

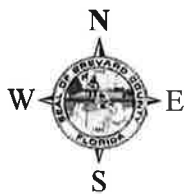
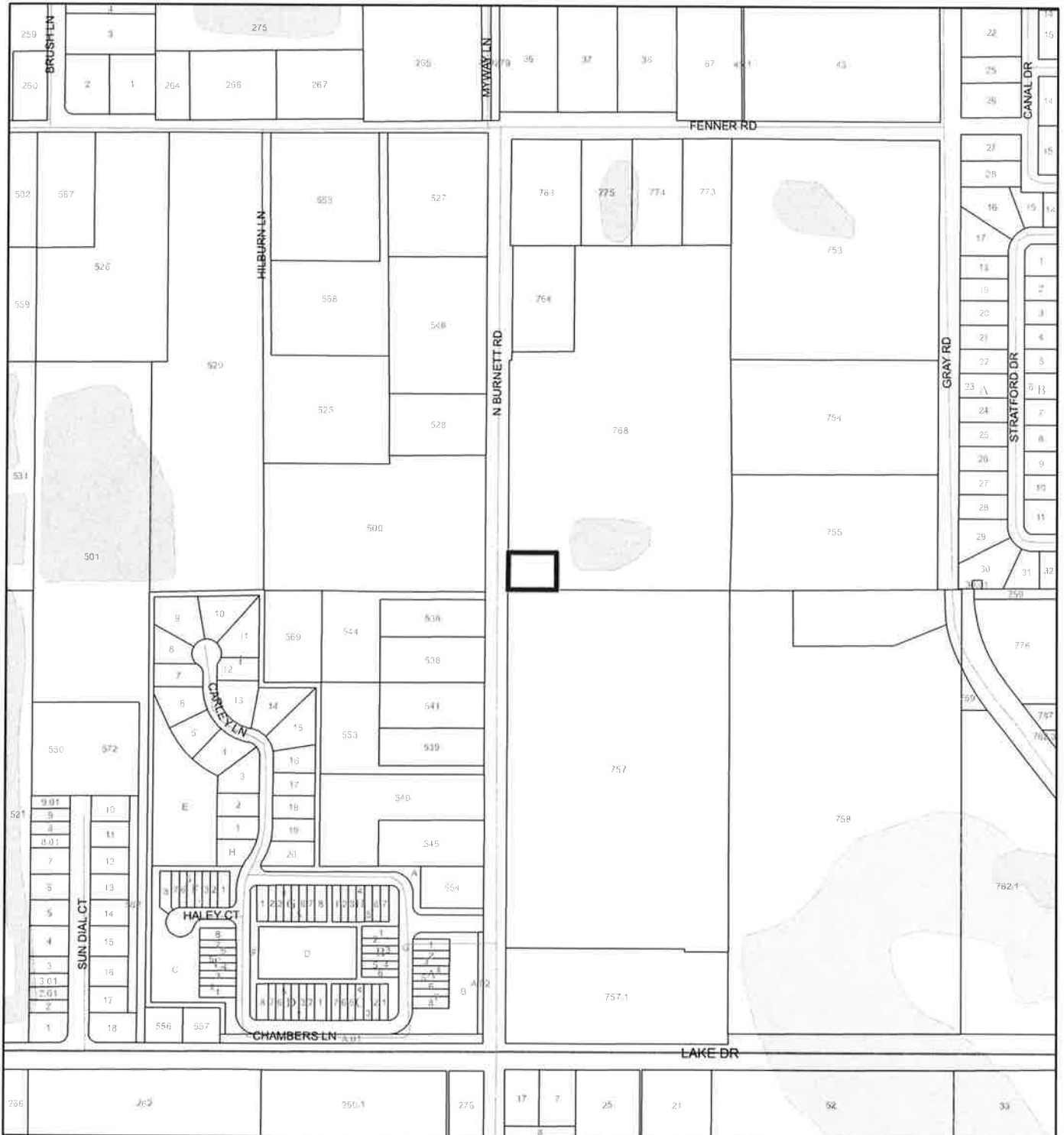











1:4,800 or 1 inch = 400 feet

This map was compiled from recorded documents and does not reflect an actual survey. The Brevard County Board of County Commissioners does not assume responsibility for errors or omissions hereon.

Produced by BoCC - GIS Date: 1/3/2023

### National Wetlands Inventory (NWI)

- |  |  |
|--|--|
|  Estuarine and Marine Deepwater    |  Freshwater Pond  |
|  Estuarine and Marine Wetland      |  Lake             |
|  Freshwater Emergent Wetland       |  Other            |
|  Freshwater Forested/Shrub Wetland |  Riverine         |
|  |  Subject Property |
|  |  Parcels          |

# SJRWMD FLUCCS WETLANDS - 6000 Series MAP

Half Halt Stables  
22Z00068

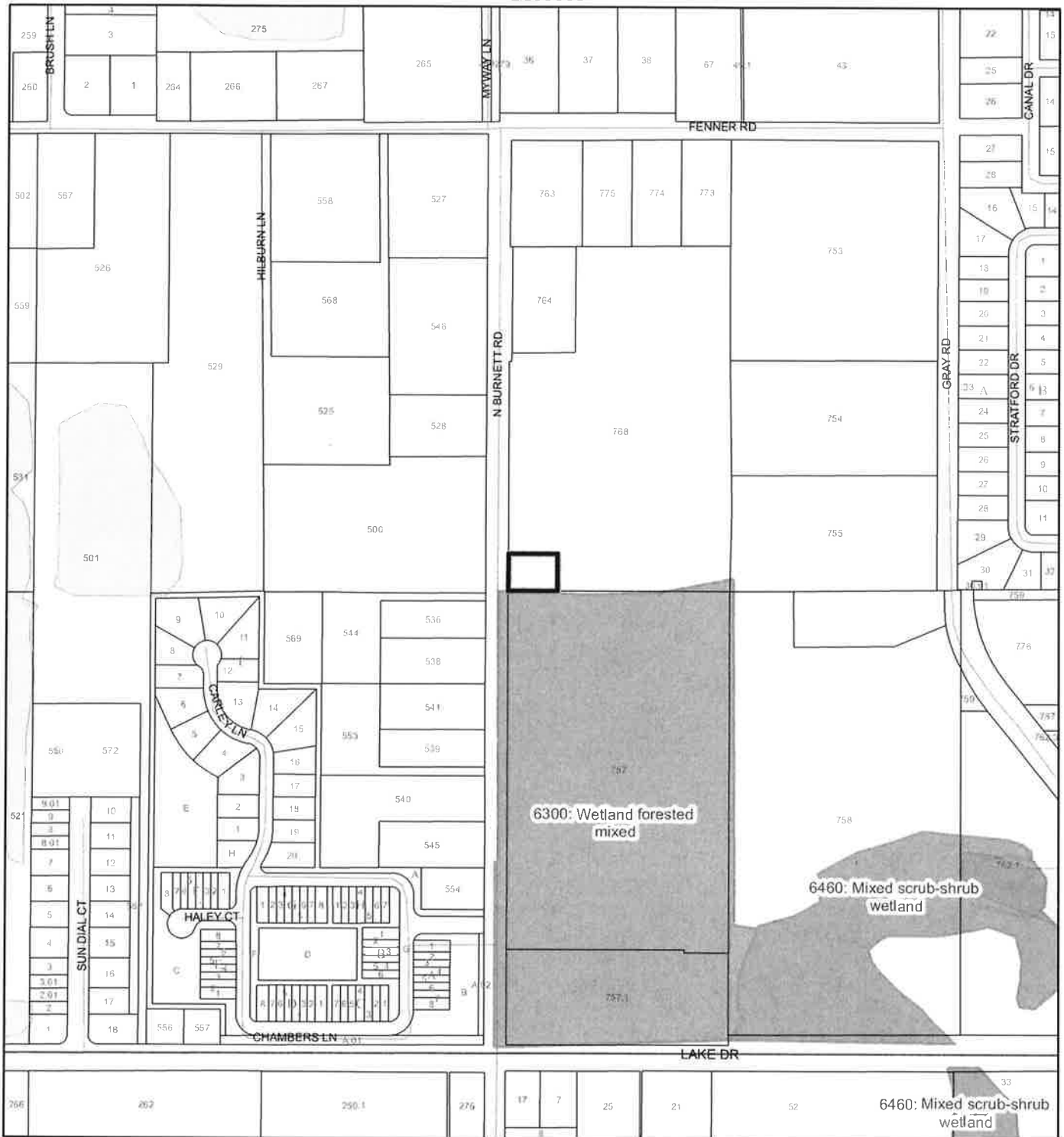

1:4,800 or 1 inch = 400 feet

This map was compiled from recorded documents and does not reflect an actual survey. The Brevard County Board of County Commissioners does not assume responsibility for errors or omissions hereon.

Produced by BoCC - GIS Date: 1/3/2023

## SJRWMD FLUCCS WETLANDS

-  Wetland Hardwood Forests - Series 6100
-  Wetland Coniferous Forest - Series 6200
-  Wetland Forested Mixed - Series 6300
-  Vegetated Non-Forested Wetlands - Series 6400
-  Non-Vegetated Wetland - Series 6500

 Subject Property

 Parcels



# USDA SCSSS SOILS MAP





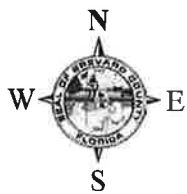
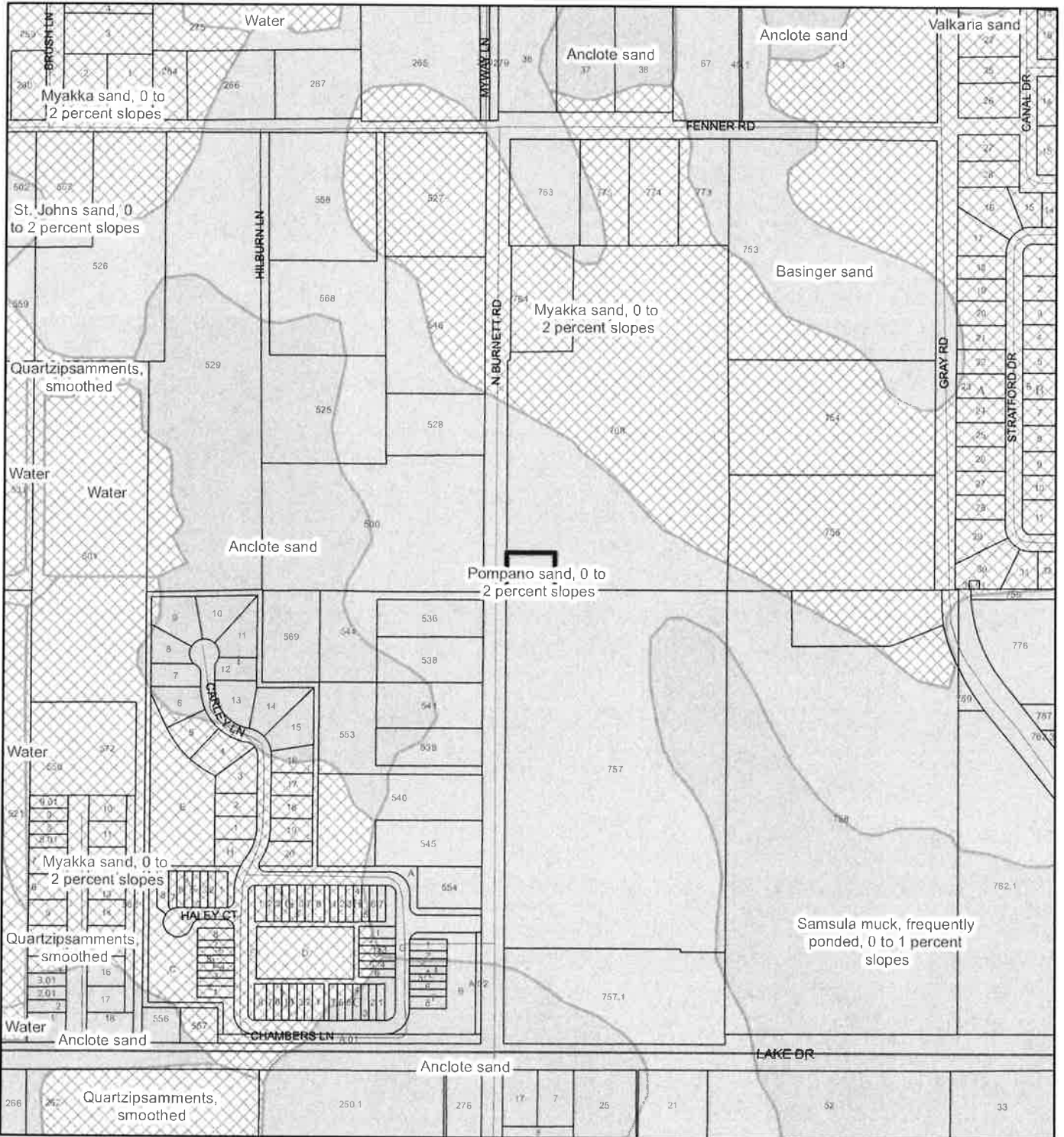

Half Halt Stables

22Z00068



1:4,800 or 1 inch = 400 feet

### USDA SCSSS Soils

-  Aquifer and Hydric
-  Aquifer
-  Hydric
-  None
-  Subject Property
-  Parcels

This map was compiled from recorded documents and does not reflect an actual survey. The Brevard County Board of County Commissioners does not assume responsibility for errors or omissions hereon.

Produced by BoCC - GIS Date: 1/3/2023

# FEMA FLOOD ZONES MAP

Half Halt Stables  
22Z00068

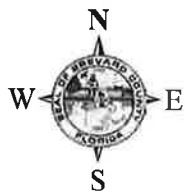
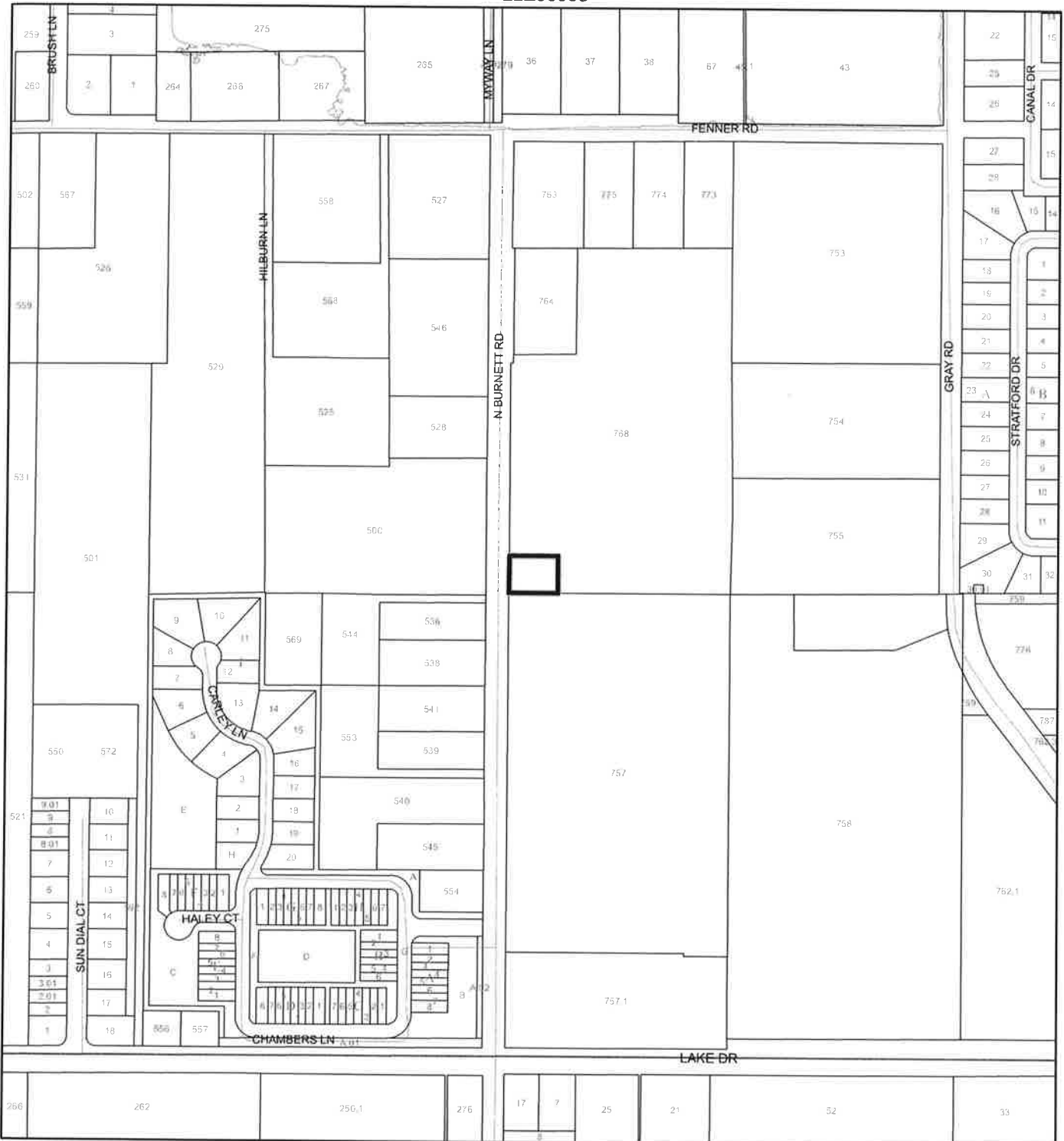

1:4,800 or 1 inch = 400 feet

This map was compiled from recorded documents and does not reflect an actual survey. The Brevard County Board of County Commissioners does not assume responsibility for errors or omissions hereon.

Produced by BoCC - GIS Date: 1/3/2023

### FEMA Flood Zones

- |  |  |  |
|--|--|--|
|  |  |  |
|  |  |  |
|  |  |  |
|  |  |  |

# COASTAL HIGH HAZARD AREA MAP

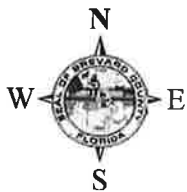
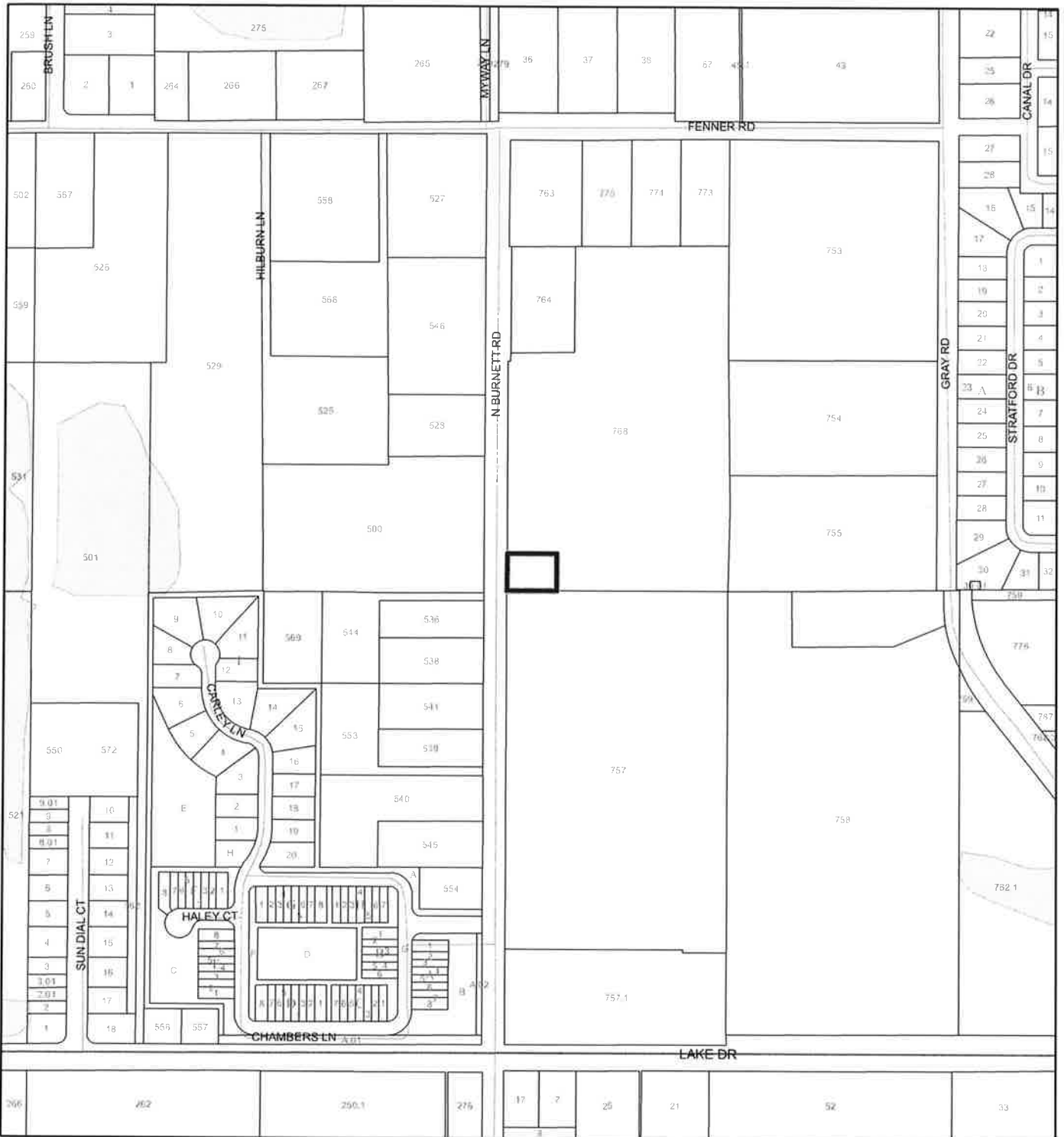

Half Halt Stables  
22Z00068



1:4,800 or 1 inch = 400 feet

This map was compiled from recorded documents and does not reflect an actual survey. The Brevard County Board of County Commissioners does not assume responsibility for errors or omissions hereon.

Produced by BoCC - GIS Date: 1/3/2023

-  Subject Property
-  Parcels
- Coastal High Hazard Area**
-  SurgeZoneCat1

# INDIAN RIVER LAGOON SEPTIC OVERLAY MAP

Half Halt Stables  
22Z00068

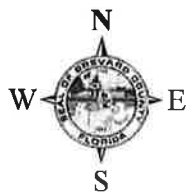
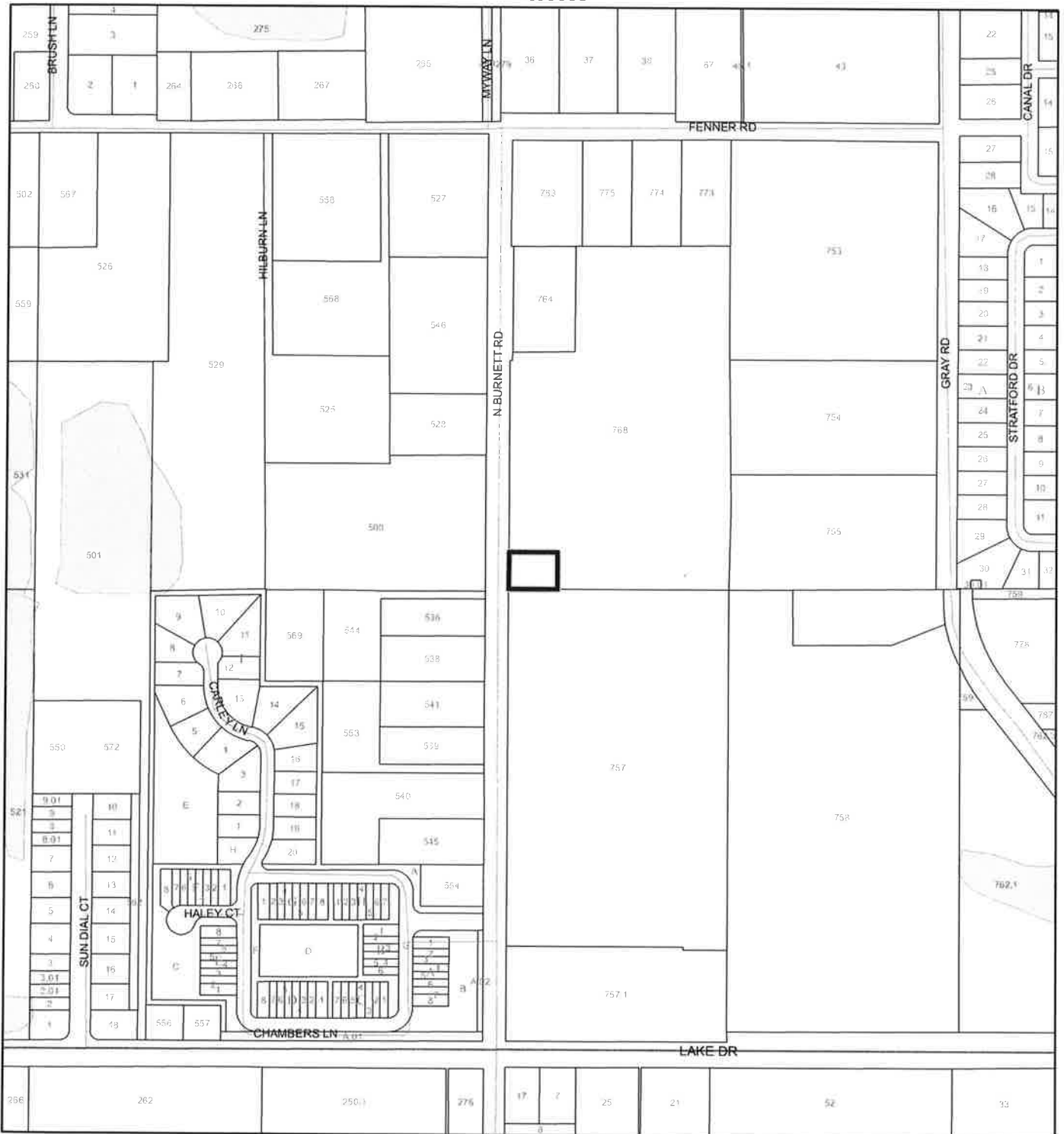

1:4,800 or 1 inch = 400 feet

This map was compiled from recorded documents and does not reflect an actual survey. The Brevard County Board of County Commissioners does not assume responsibility for errors or omissions hereon.

Produced by BoCC - GIS Date: 1/3/2023

 Subject Property

 Parcels

**Septic Overlay**

 40 Meters

 60 Meters

 All Distances

# EAGLE NESTS MAP

Half Halt Stables  
22Z00068

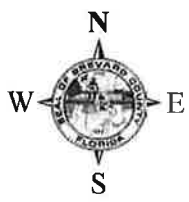
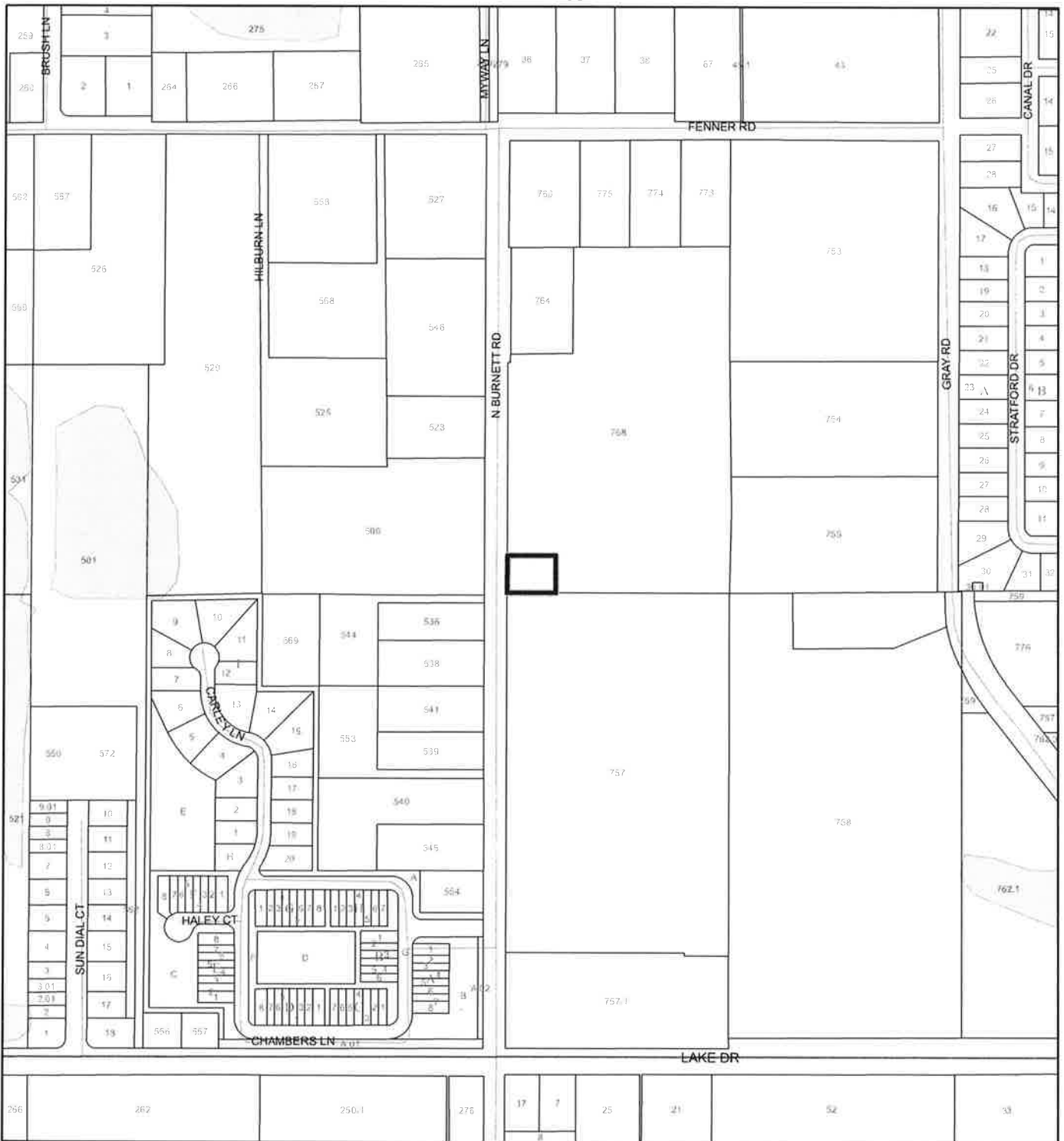

1:4,800 or 1 inch = 400 feet

This map was compiled from recorded documents and does not reflect an actual survey. The Brevard County Board of County Commissioners does not assume responsibility for errors or omissions hereon.

Produced by BoCC - GIS Date: 1/3/2023

-  Subject Property
-  Parcels
-  Eagle Nests FWS 2010

# SCRUB JAY OCCUPANCY MAP

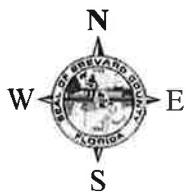
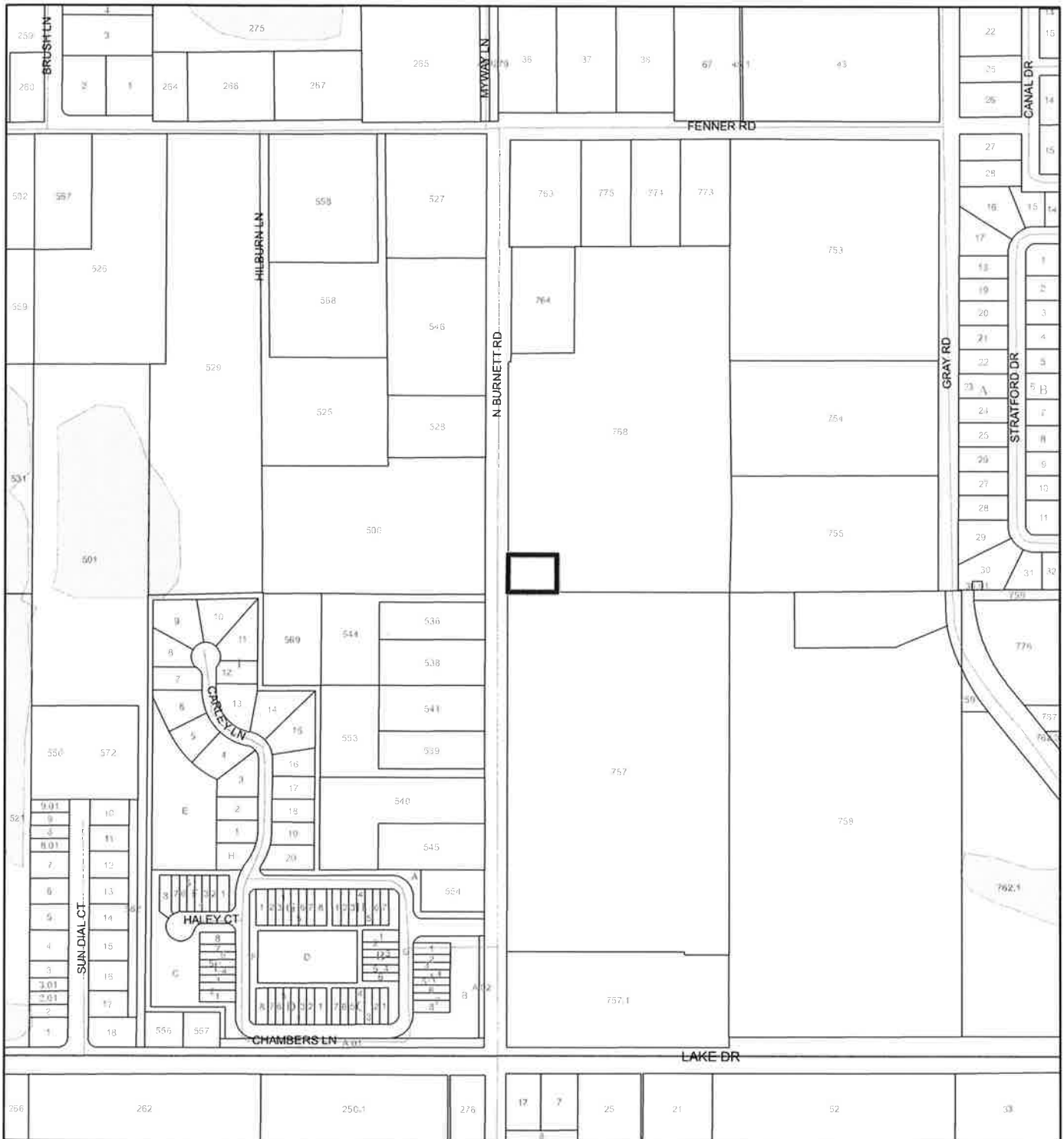

Half Halt Stables  
22Z00068



1:4,800 or 1 inch = 400 feet

This map was compiled from recorded documents and does not reflect an actual survey. The Brevard County Board of County Commissioners does not assume responsibility for errors or omissions hereon.

Produced by BoCC - GIS Date: 1/3/2023

-  Subject Property
-  Parcels
-  Scrub Jay Occupancy

# SJRWMD FLUCCS UPLAND FORESTS - 4000 Series MAP

Half Halt Stables

22Z00068

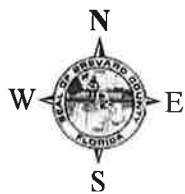
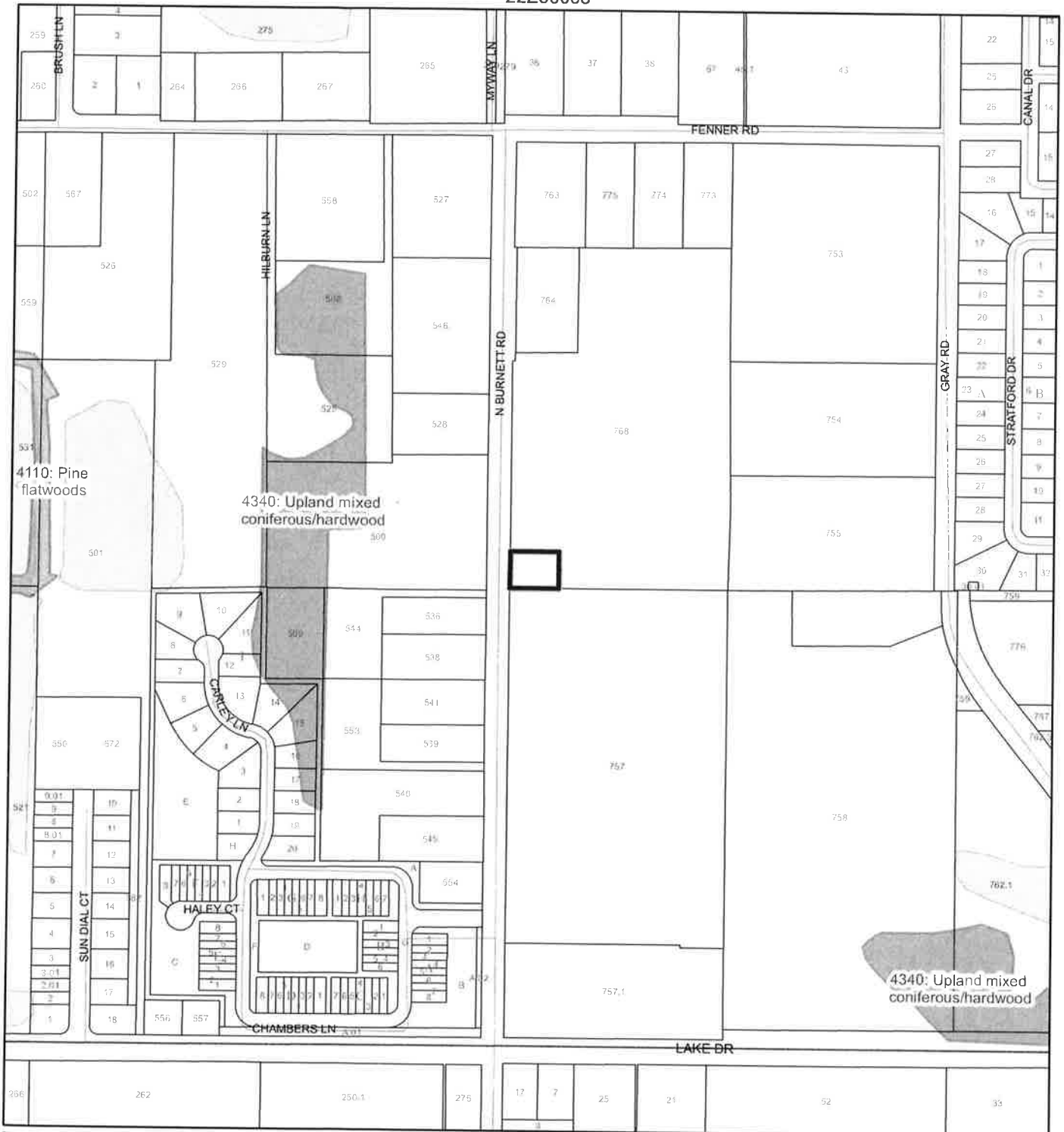





1:4,800 or 1 inch = 400 feet

This map was compiled from recorded documents and does not reflect an actual survey. The Brevard County Board of County Commissioners does not assume responsibility for errors or omissions hereon.

Produced by BoCC - GIS Date: 1/3/2023

### SJRWMD FLUCCS Upland Forests

-  Upland Coniferous Forest - 4100 Series
-  Upland Hardwood Forest - 4200 Series
-  Upland Mixed Forest - 4300 Series
-  Tree Plantations - 4400 Series

 Subject Property

 Parcels

## PLANNING AND ZONING BOARD/LOCAL PLANNING AGENCY MINUTES

The Brevard County Planning & Zoning Board met in regular session on **Monday, March 13, 2023**, at **3:00 p.m.**, in the Florida Room, Building C, Brevard County Government Center, 2725 Judge Fran Jamieson Way, Viera, Florida.

The meeting was called to order at 3:00 p.m.

Board members present were: Board members present were: Henry Minneboo (D1); Ron Bartcher (D1); Robert Sullivan (D2); Lorraine Koss (D2-Alt.); Ben Glover, Vice Chair (D3); Debbie Thomas (D4); Mark Wadsworth, Chair (D4); Logan Luse (D4-Alt.); Bruce Moia; and John Hopengarten (BPS).

Staff members present were: Jeffrey Ball, Planning and Zoning Manager; Alex Esseesse, Deputy County Attorney; Jane Hart, Planner III; Paul Body, Planner III; Trina Gilliam, Planner II; Melissa Wilbrandt, Associate Planner; and Jennifer Jones, Special Projects Coordinator.

### Excerpt of Complete Agenda

#### **Half Halt Stables, LLP** (Toni Pastermack)

A change of zoning classification from AU (Agricultural Residential) to RU-1-9 (Single-Family Residential), on 0.33 acres, located on the east side of Burnett Rd., approx. 0.25 mile north of Lake Dr. (525 & 655 N. Burnett Rd., Cocoa) (22Z00068) (Tax Account 2407648) (District 2)

Toni Pastermack, 4405 Crooked Mile Road, Merritt Island, stated the subject property is part of larger property that is zoned AU and is a horse farm. She said her clients would like to rezone to RU-1-9 in order to sell the house.

No public comment.

Motion by Bruce Moia, seconded by Debbie Thomas, to recommend approval of the change of zoning classification from AU to RU-1-9. The motion passed unanimously.