



Agenda Report

2725 Judge Fran Jamieson
Way
Viera, FL 32940

Consent

F.3.

2/25/2020

Subject:

Approval Re: Emergency Medical Services Impact Fee Advisory Committee Project Funding Recommendation.
(Districts 1 - 5)

Fiscal Impact:

The Emergency Medical Services Impact Fees that will be used to fund this purchase have already been collected and deposited in the Emergency Medical Services Impact Fee Trust Fund for Benefit District 1 (Fund 1330). The Trust Fund Balance at the beginning of this fiscal year was \$323,717.37. The approval of this funding request of \$25,000.00 or less will not have a significant fiscal impact on the Trust Fund.

Dept/Office:

Planning and Development Department

Requested Action:

It is requested that the Board of County Commissioners approve the project funding recommendation adopted by the Impact Fee Advisory Committee for Emergency Medical Services Impact Fee Benefit District 1 and authorize the Budget Office to execute any budget changes required to implement the project recommendation.

Summary Explanation and Background:

The Brevard County Fire/Rescue Department has identified a need for an all-terrain vehicle to respond to emergencies along the 2.8 mile, long Linear Trail between the Brevard Zoo and the terminus of Turtle mound Road in Windover Farms of Melbourne. The Linear Trail is not accessible by current Rescue Units. The all-terrain vehicle will be stored at the northern end of the trail in a building that will be constructed by Brevard County Parks and Recreation Department.

The Emergency Medical Services Impact Fee Advisory Committee met on January 23, 2020 and recommended approval of the acquisition of the all-terrain vehicle as proposed by Brevard County Fire/Rescue at a cost not to exceed \$25,000.00. The Advisory Committee is composed of one representative from Brevard County and one representative each of the municipalities in Brevard County.

The funding request presented by Fire/Rescue is attached for your review along with a map depicting the Emergency Medical Services Impact Fee Benefit District boundaries.

Clerk to the Board Instructions:

47



Tammy Rowe, Clerk to the Board, 400 South Street • P.O. Box 999, Titusville, Florida 32781-0999

Telephone: (321) 637-2001

Fax: (321) 264-6972

Tammy.Rowe@brevardclerk.us

February 26, 2020

M E M O R A N D U M

TO: Tad Calkins, Planning and Development Director

RE: Item F.3., Emergency Medical Services Impact Fee Advisory Committee Project Funding Recommendation

The Board of County Commissioners, in regular session on February 25, 2020, approved the project funding recommendation adopted by the Impact Fee Advisory Committee for Emergency Medical Services Impact Fee Benefit District 1, for acquisition of an all-terrain vehicle; and authorized the Budget Office to execute any budget changes required to implement the project recommendation.

Your continued cooperation is always appreciated.

Sincerely,

**BOARD OF COUNTY COMMISSIONERS
SCOTT ELLIS, CLERK**

Tammy Rowe

Tammy Rowe, Deputy Clerk

cc: Fire Rescue
Finance
Budget



BOARD OF COUNTY COMMISSIONERS

Brevard County Fire Rescue

1040 S. Florida Ave.

Rockledge FL 32955

Inter-Office Memo

TO: Stephen Swanke, Impact Fee Program Coordinator

THRU: Matthew Wallace, Public Safety Director Wallace, Matthew

Digitally signed by Wallace, Matthew
Date: 2019.11.18 09:18:09 -05'00'

THRU: Mark Schollmeyer, Fire Chief 

FROM: Scott Gold, Assistant Chief Support Services 

DATE: November 12, 2019

SUBJECT: EMS Impact Fee Project- Linear Trail ATV

Fire Rescue is requesting a committee evaluation for the use of EMS impact fees to purchase an all-terrain vehicle for the Linear Trail located near the Brevard Zoo. The paved nature trail proceeds from the dead end of the zoo entrance to the Turtle Mound road area; approximately 2.5 miles. Access to the trail is not possible for standard emergency vehicles. Fire Rescue, in cooperation with Parks and Recreation, would like to place a storage building and all-terrain vehicle near the trail entrance for emergency response consideration; the current method for patient access along the trail is by foot.

A modest vehicle was selected for the project to include room for EMS crew members to travel and function during and EMS incident; the vehicle will hold our stretcher and EMS equipment configuration. Parks and Recreation has agreed to supply a storage building for the vehicle to allow for quick access to EMS calls along the trail. In the last year we have received several calls for service at the trail location. We thank you in advance for your consideration and time.

Attached:

Aerial Map of Linear trail

Street Map View

ATV Quote

ATV Picture

LINEAR PARK TRAIL



—— Roadways

Linear Trail

— Access Point

Trail

50

LINEAR PARK TRAIL

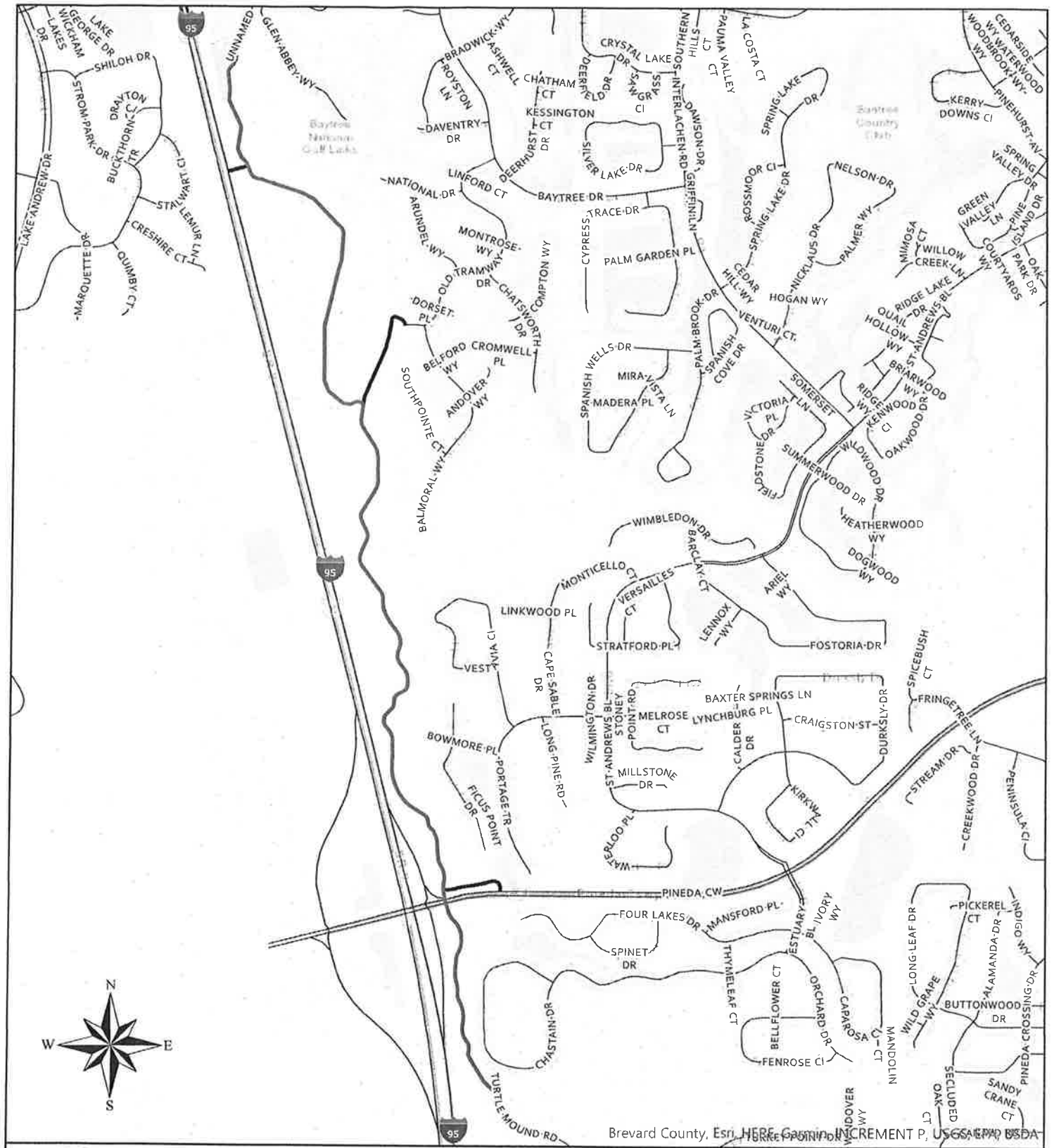

Brevard County, Esri, HERE, Garmin, INCREMENT P, USGS, NOAA, USDA



0 0.1 0.3 0.5 0.8 Miles

— Roadways

Linear Trail

— Access Point

— Trail

51

McKibben Powersports Of Lake Placid

Call Us first, for all of your Powersports needs.

PHONE (863) 699-2453

WWW.GHCMOTORSPORTS.COM

Corporate Office	614 U.S. 27 South Lake Placid, FL 33852	Mailing Address	614 U.S. 27 South Lake Placid, FL 33852
Direct 863-699-2453		Fax 863-699-2639	

PURCHASE QUOTE SHEET

FSA18-VEH16.0 Cab & Chasis Trucks & Other Fleet Equipment

DATE 19-Sep-19

PAGE 1 of 1

REQUESTING AGENCY:

Brevard County Fire Rescue

CONTACT PERSON:

Eisen Witcher

PHONE NUMBER:

321-266-6042

FAX NUMBER:

E-mail eisen.witcher@brevardcounty.us

2019 Yamaha Viking
700cc ENGINE/4X4/AUTOMATIC

MODEL: YXM70VDXK

SPECIFICATION #

2

Units will be ordered in RED!!!

CENTRAL BASE PRICE: \$10,763.00

OPTION #	DESCRIPTION		COST
YXC70VPXKG	Model Upgrade to Viking 6 EPS	Included	\$3,186.00
1XD-H21B0-V0-00	Dual Battery Kit	Installed	\$637.00
2PG-K84A0-V0-00	Poly top	Installed	\$537.00
Labor	Labor to Install Lights and Sirens		\$392.00
Lights/Siren	4 Corner Lights and Siren		\$199.00
KIMTEK	KIMTEK Medlite MTD-103	Installed	\$4,400.00

TOTAL OF OPTIONS: \$9,351.00

EXTENDED WARRANTY:

SUB TOTAL \$15,714.00

TAX
FLORIDA REGISTRATION

Tax Exempt
Self Register

QTY 1 Each = \$20,114.00

I appreciate the opportunity to submit this quotation. Please review it carefully. If there are any errors or changes, please feel free to contact me at any time. I will be happy to assist you.

Comments:

McKibben Motorsports LP, INC DBA McKibben Powersports of Lake Placid

VEHICLE QUOTED BY: Paige Cowell

863-699-2453

"I Want to be Your Powersports Provider"

Paigeghc@gmail.com

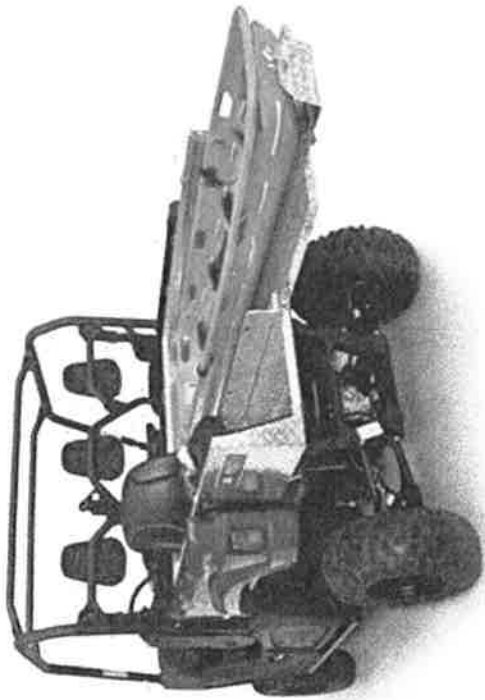

EMS Impact Fee Districts

