



# Agenda Report

2725 Judge Fran Jamieson  
Way  
Viera, FL 32940

## Public Hearing

---

G.1.

11/2/2023

---

### Subject:

Joseph S. Minnick requests a change of zoning classification from GU to RR-1. (23Z00064) (Tax Account 2001554) (District 1)

### Fiscal Impact:

None

### Dept/Office:

Planning & Development

### Requested Action:

It is requested that the Board of County Commissioners conduct a public hearing to consider a change of zoning classification from GU (General Use) to RR-1 (Rural Residential).

### Summary Explanation and Background:

The applicant is requesting to change the zoning classification from GU to RR-1 on a 1.59-acre lot to build a single-family residence. The subject parcel was originally platted in May 1914, and was subdivided in its current configuration in June 2002. Because of the lot split, the property does not meet the GU minimum lot size of 5 acres and has lost its non-conforming lot of record status.

The proposed RR-1 zoning classification permits single-family residential land uses on a minimum one-acre lot, with a minimum lot width and depth of 125 feet, and a minimum house size of 1,200 square feet. The RR-1 classification permits horses, barns and horticulture as accessory uses to a single-family residence.

To the north across the right-of-way is a single-family residence on 1.47-acres with RRMH-1 zoning. To the south is a 0.27-acre undeveloped substandard parcel with GU zoning. To the east is an undeveloped 1.81-acre parcel with GU zoning. To the west is a single-family residence on 2 acres with RRMH-1 zoning. The developed character of the surrounding area can be characterized as single-family residential on larger lots. West of the subject property, RR-1 and RRMH-1 zoning classifications are the most prevalent zoning classifications. Further east, there is limited development potential due to access issues.

The Board may wish to consider if the request is consistent and compatible with the surrounding area.

On October 16, 2023, the Planning & Zoning Board heard the request and unanimously recommended approval.

### Clerk to the Board Instructions:

Once resolution is received, please execute and return a copy to Planning & Development.

**Resolution 23Z00064**

On motion by Commissioner Feltner, seconded by Commissioner Tobia, the following resolution was adopted by a unanimous vote: (Commissioner Steele absent)

**WHEREAS, Joseph S. Minnick** requests a change of zoning classification from GU (General Use) to RR-1 (Rural Residential), on property described as Lot 3.02, Block 4, Indian River Park, as recorded in ORB 9533, Pages 2882 – 2883, of the Public Records of Brevard County, Florida. **Section 16, Township 20G, Range 34.** (1.32 acres) Located on the south side of April Lane, approx. 0.22 miles east of International Ave. (4055 April Lane, Mims); and

**WHEREAS,** a public hearing of the Brevard County Planning and Zoning Board was advertised and held, as required by law, and after hearing all interested parties and considering the adjacent areas, the Brevard County Planning and Zoning Board recommended that the application be approved; and

**WHEREAS,** the Board, after considering said application and the Planning and Zoning Board's recommendation, and hearing all interested parties, and after due and proper consideration having been given to the matter, find that the application should be approved as recommended; now therefore,

**BE IT RESOLVED** by the Board of County Commissioners of Brevard County, Florida, that the requested change of zoning classification from GU to RR-1, be approved. The Planning and Development Director, or designee, is hereby directed to make this change on the official zoning maps of Brevard County, Florida.

**BE IT FURTHER RESOLVED** that this resolution shall become effective as of November 2, 2023.

BOARD OF COUNTY COMMISSIONERS  
Brevard County, Florida

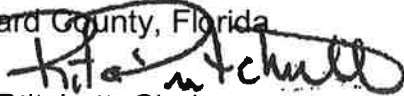
  
Rita Pritchett, Chair

Brevard County Commission

As approved by the Board on November 2, 2023.

ATTEST:

  
  
RACHEL SADOFF, CLERK

(SEAL)

P&Z Board Hearing – October 16, 2023

Please note: A CUP (Conditional Use Permit) will generally expire on the three-year anniversary of its approval if the use is not established prior to that date. CUPs for Towers and Antennas shall expire if a site plan for the tower is not submitted within one year of approval or if construction does not commence within two years of approval. A Planned Unit Development Preliminary Development Plan expires if a final development plan is not filed within three years. **The granting of this zoning does not guarantee physical development of the property. At the time of development, said development must be in accordance with the criteria of the Brevard County Comprehensive Plan and other applicable laws and ordinances.**

## **ADMINISTRATIVE POLICIES OF THE FUTURE LAND USE ELEMENT**

Administrative Policies in the Future Land Use Element establish the expertise of staff with regard to zoning land use issues and set forth criteria when considering a rezoning action or request for Conditional Use Permit, as follows:

### **Administrative Policy 1**

The Brevard County zoning official, planners and the Director of the Planning and Development, however designated, are recognized as expert witnesses for the purposes of Comprehensive Plan amendments as well as zoning, conditional use, special exception, and variance applications.

### **Administrative Policy 2**

Upon Board request, members of the Brevard County planning and zoning staff shall be required to present written analysis and a recommendation, which shall constitute an expert opinion, on all applications for zoning, conditional uses, comprehensive plan amendments, vested rights, or other applications for development approval that come before the Board of County Commissioners for quasi-judicial review and action. The Board may table an item if additional time is required to obtain the analysis requested or to hire an expert witness if the Board deems such action appropriate. Staff input may include the following:

#### **Criteria:**

- A. Staff shall analyze an application for consistency or compliance with comprehensive plan policies, zoning approval criteria and other applicable written standards.
- B. Staff shall conduct site visits of property which are the subject of analysis and recommendation. As part of the site visit, the staff shall take a videotape or photographs where helpful to the analysis and conduct an inventory of surrounding existing uses. Aerial photographs shall also be used where they would aid in an understanding of the issues of the case.
- C. In cases where staff analysis is required, both the applicant and the staff shall present proposed findings of fact for consideration by the Board.
- D. For development applications where a specific use has not been proposed, the worst case adverse impacts of potential uses available under the applicable land use classification shall be evaluated by the staff.

### **Administrative Policy 3**

Compatibility with existing or proposed land uses shall be a factor in determining where a rezoning or any application involving a specific proposed use is being considered. Compatibility shall be evaluated by considering the following factors, at a minimum:

#### **Criteria:**

- A. Whether the proposed use(s) would have hours of operation, lighting, odor, noise levels, traffic, or site activity that would significantly diminish the enjoyment of, safety or quality of life in existing neighborhoods within the area which could foreseeably be affected by the proposed use.

- B. Whether the proposed use(s) would cause a material reduction (five percent or more) in the value of existing abutting lands or approved development.
- C. Whether the proposed use(s) is/are consistent with an emerging or existing pattern of surrounding development as determined through analysis of:
  - 1. historical land use patterns;
  - 2. actual development over the immediately preceding three years; and
  - 3. development approved within the past three years but not yet constructed.
- D. Whether the proposed use(s) would result in a material violation of relevant policies in any elements of the Comprehensive Plan.

#### **Administrative Policy 4**

Character of a neighborhood or area shall be a factor for consideration whenever a rezoning or any application involving a specific proposed use is reviewed. The character of the area must not be materially or adversely affected by the proposed rezoning or land use application. In evaluating the character of an area, the following factors shall be considered:

##### **Criteria:**

- A. The proposed use must not materially and adversely impact an established residential neighborhood by introducing types of intensity of traffic (including but not limited to volume, time of day of traffic activity, type of vehicles, et cetera), parking, trip generation, commercial activity or industrial activity that is not already present within the identified boundaries of the neighborhood.
- B. In determining whether an established residential neighborhood exists, the following factors must be present:
  - 1. The area must have clearly established boundaries, such as roads, open spaces, rivers, lakes, lagoons, or similar features.
  - 2. Sporadic or occasional neighborhood commercial uses shall not preclude the existence of an existing residential neighborhood, particularly if the commercial use is non-conforming or pre-dates the surrounding residential use.
  - 3. An area shall be presumed not to be primarily residential but shall be deemed transitional where multiple commercial, industrial or other non-residential uses have been applied for and approved during the previous five (5) years.

#### **Administrative Policy 5**

In addition to the factors specified in Administrative Policies 2, 3, and 4, in reviewing a rezoning, conditional use permit or other application for development approval, the impact of the proposed use or uses on transportation facilities either serving the site or impacted by the

use(s) shall be considered. In evaluating whether substantial and adverse transportation impacts are likely to result if an application is approved, the staff shall consider the following:

**Criteria:**

- A. Whether adopted levels of services will be compromised;
- B. Whether the physical quality of the existing road system that will serve the proposed use(s) is sufficient to support the use(s) without significant deterioration;
- C. Whether the surrounding existing road system is of sufficient width and construction quality to serve the proposed use(s) without the need for substantial public improvements;
- D. Whether the surrounding existing road system is of such width and construction quality that the proposed use(s) would realistically pose a potential for material danger to public safety in the surrounding area;
- E. Whether the proposed use(s) would be likely to result in such a material and adverse change in traffic capacity of a road or roads in the surrounding area such that either design capacities would be significantly exceeded or a de facto change in functional classification would result;
- F. Whether the proposed use(s) would cause such material and adverse changes in the types of traffic that would be generated on the surrounding road system, that physical deterioration of the surrounding road system would be likely;
- G. Whether projected traffic impacts of the proposed use(s) would materially and adversely impact the safety or welfare of residents in existing residential neighborhoods.

**Administrative Policy 6**

The use(s) proposed under the rezoning, conditional use or other application for development approval must be consistent with, (a), all written land development policies set forth in these administrative policies; and (b), the future land use element, coastal management element, conservation element, potable water element, sanitary sewer element, solid waste management element, capital improvements element, recreation and open space element, surface water element, and transportation elements of the comprehensive plan.

**Administrative Policy 7**

Proposed use(s) shall not cause or substantially aggravate any, (a), substantial drainage problem on surrounding properties; or (b), significant, adverse and unmitigatable impact on significant natural wetlands, water bodies or habitat for listed species.

**Administrative Policy 8**

These policies, the staff analysis based upon these policies, and the applicant's written analysis, if any, shall be incorporated into the record of every quasi-judicial review application for development approval presented to the Board including rezoning, conditional use permits, and vested rights determinations.

Section 62-1151(c) of the Code of Ordinances of Brevard County directs, "The planning and zoning board shall recommend to the board of county commissioners the denial or approval of each application for amendment to the official zoning maps based upon a consideration of the following factors:

- (1) The character of the land use of the property surrounding the property being considered.
- (2) The change in conditions of the land use of the property being considered and the surrounding property since the establishment of the current applicable zoning classification, special use or conditional use.
- (3) The impact of the proposed zoning classification or conditional use on available and projected traffic patterns, water and sewer systems, other public facilities and utilities and the established character of the surrounding property.
- (4) The compatibility of the proposed zoning classification or conditional use with existing land use plans for the affected area.
- (5) The appropriateness of the proposed zoning classification or conditional use based upon a consideration of the applicable provisions and conditions contained in this article and other applicable laws, ordinances and regulations relating to zoning and land use regulations and based upon a consideration of the public health, safety and welfare.

The minutes of the planning and zoning board shall specify the reasons for the recommendation of approval or denial of each application."

#### **CONDITIONAL USE PERMITS (CUPs)**

In addition to the specific requirements for each Conditional Use Permit (CUP), Section 62-1901 provides that the following approval procedure and general standards of review are to be applied to all CUP requests, as applicable.

- (b) Approval procedure. An application for a specific conditional use within the applicable zoning classification shall be submitted and considered in the same manner and according to the same procedure as an amendment to the official zoning map as specified in Section 62-1151. The approval of a conditional use shall authorize an additional use for the affected parcel of real property in addition to those permitted in the applicable zoning classification. The initial burden is on the applicant to demonstrate that all applicable standards and criteria are met. Applications which do not satisfy this burden cannot be approved. If the applicant meets its initial burden, then the Board has the burden to show, by substantial and competent evidence, that the applicant has failed to meet such standards and the request is adverse to the public interest. As part of the approval of the conditional use permit, the Board may prescribe appropriate and reasonable conditions and safeguards to reduce the impact of the proposed use on adjacent and nearby properties or the neighborhood. A nearby property, for the purpose of this section, is defined as any property which, because of the character of the proposed use, lies within the area which may be substantially and adversely impacted by such use. In stating grounds in

support of an application for a conditional use permit, it is necessary to show how the request fulfills both the general and specific standards for review. The applicant must show the effect the granting of the conditional use permit will have on adjacent and nearby properties, including, but not limited to traffic and pedestrian flow and safety, curb-cuts, off-street loading and parking, off-street pickup of passengers, odors, glare and noise, particulates, smoke, fumes, and other emissions, refuse and service areas, drainage, screening and buffering for protection of adjacent and nearby properties, and open space and economic impact on nearby properties. The applicant, at his discretion, may choose to present expert testimony where necessary to show the effect of granting the conditional use permit.

(c) General Standards of Review.

- (1) The planning and zoning board and the board of county commissioners shall base the denial or approval of each application for a conditional use based upon a consideration of the factors specified in Section 62-1151(c) plus a determination whether an application meets the intent of this section.
  - a. The proposed conditional use will not result in a substantial and adverse impact on adjacent and nearby properties due to: (1), the number of persons anticipated to be using, residing or working under the conditional use; (2), noise, odor, particulates, smoke, fumes and other emissions, or other nuisance activities generated by the conditional use; or (3), the increase of traffic within the vicinity caused by the proposed conditional use.
  - b. The proposed use will be compatible with the character of adjacent and nearby properties with regard to use, function, operation, hours of operation, type and amount of traffic generated, building size and setback, and parking availability.
  - c. The proposed use will not cause a substantial diminution in value of abutting residential property. A substantial diminution shall be irrebuttably presumed to have occurred if abutting property suffers a 15% reduction in value as a result of the proposed conditional use. A reduction of 10% of the value of abutting property shall create a rebuttable presumption that a substantial diminution has occurred. The Board of County Commissioners carries the burden to show, as evidenced by either testimony from or an appraisal conducted by an M A I certified appraiser, that a substantial diminution in value would occur. The applicant may rebut the findings with his own expert witnesses.
- (2) The following specific standards shall be considered, when applicable, in making a determination that the general standards specified in subsection (1) of this section are satisfied:

- a. Ingress and egress to the property and proposed structures thereon, with particular reference to automotive and pedestrian safety and convenience, traffic flow and control, and access in case of fire and catastrophe, shall be: (1), adequate to serve the proposed use without burdening adjacent and nearby uses, and (2), built to applicable county standards, if any. Burdening adjacent and nearby uses means increasing existing traffic on the closest collector or arterial road by more than 20%, or 10% if the new traffic is primarily comprised of heavy vehicles, except where the affected road is at Level of Service A or B. New traffic generated by the proposed use shall not cause the adopted level of service for transportation on applicable roadways, as determined by applicable Brevard County standards, to be exceeded. Where the design of a public road to be used by the proposed use is physically inadequate to handle the numbers, types or weights of vehicles expected to be generated by the proposed use without damage to the road, the conditional use permit cannot be approved without a commitment to improve the road to a standard adequate to handle the proposed traffic, or to maintain the road through a maintenance bond or other means as required by the Board of County Commissioners.
- b. The noise, glare, odor, particulates, smoke, fumes or other emissions from the conditional use shall not substantially interfere with the use or enjoyment of the adjacent and nearby property.
- c. Noise levels for a conditional use are governed by Section 62-2271.
- d. The proposed conditional use shall not cause the adopted level of service for solid waste disposal applicable to the property or area covered by such level of service, to be exceeded.
- e. The proposed conditional use shall not cause the adopted level of service for potable water or wastewater applicable to the property or the area covered by such level of service, to be exceeded by the proposed use.
- f. The proposed conditional use must have existing or proposed screening or buffering, with reference to type, dimensions and character to eliminate or reduce substantial, adverse nuisance, sight, or noise impacts on adjacent and nearby properties containing less intensive uses.
- g. Proposed signs and exterior lighting shall not cause unreasonable glare or hazard to traffic safety, or interference with the use or enjoyment of adjacent and nearby properties.
- h. Hours of operation of the proposed use shall be consistent with the use and enjoyment of the properties in the surrounding residential community, if any. For commercial and industrial uses adjacent to or near residential uses, the hours of operation shall not adversely affect the use and enjoyment of the residential character of the area.
- i. The height of the proposed use shall be compatible with the character of the area, and the maximum height of any habitable structure shall be not more than 35 feet higher than the highest residence within 1,000 feet of the property line.



- j. Off-street parking and loading areas, where required, shall not be created or maintained in a manner which adversely impacts or impairs the use and enjoyment of adjacent and nearby properties. For existing structures, the applicant shall provide competent, substantial evidence to demonstrate that actual or anticipated parking shall not be greater than that which is approved as part of the site plan under applicable county standards.

### **FACTORS TO CONSIDER FOR A REZONING REQUEST**

Section 62-1151(c) sets forth factors to consider in connection with a rezoning request, as follows:

"The planning and zoning board shall recommend to the board of county commissioners the denial or approval of each application for amendment to the official zoning maps based upon a consideration of the following factors:

- (1) The character of the land use of the property surrounding the property being considered.
- (2) The change in conditions of the land use of the property being considered and the surrounding property since the establishment of the current applicable zoning classification, special use or conditional use.
- (3) The impact of the proposed zoning classification or conditional use on available and projected traffic patterns, water and sewer systems, other public facilities and utilities and the established character of the surrounding property.
- (4) The compatibility of the proposed zoning classification or conditional use with existing land use plans for the affected area.
- (5) The appropriateness of the proposed zoning classification or conditional use based upon a consideration of the applicable provisions and conditions contained in this article and other applicable laws, ordinances and regulations relating to zoning and land use regulations and based upon a consideration of the public health, safety and welfare."

These staff comments contain references to zoning classifications found in the Brevard County Zoning Regulations, Chapter 62, Article VI, Code of Ordinances of Brevard County. These references include brief summaries of some of the characteristics of that zoning classification. Reference to each zoning classification shall be deemed to incorporate the full text of the section or sections defining and regulating that classification into the Zoning file and Public Record for that item.

These staff comments contain references to sections of the Code of Ordinances of Brevard County. Reference to each code section shall be deemed to incorporate this section into the Zoning file and Public Record for that item.

These staff comments contain references to Policies of the Brevard County Comprehensive Plan. Reference to each Policy shall be deemed to incorporate the entire Policy into the Zoning file and Public Record for that item.

These staff comments refer to previous zoning actions which are part of the Public Records of Brevard County, Florida. These records will be referred to by reference to the file number. Reference to zoning files are intended to make the entire contents of the cited file a part of the Zoning file and Public Record for that item.

## DEFINITIONS OF CONCURRENCY TERMS

**Maximum Acceptable Volume (MAV):** Maximum acceptable daily volume that a roadway can carry at the adopted Level of Service (LOS).

**Current Volume:** Building permit related trips added to the latest TPO (Transportation Planning Organization) traffic counts.

**Volume with Development (VOL W/DEV):** Equals Current Volume plus trip generation projected for the proposed development.

**Volume/Maximum Acceptable Volume (VOL/MAV):** Equals the ratio of current traffic volume to the maximum acceptable roadway volume.

**Volume/Maximum Acceptable Volume with Development (VOL/MAV W/DEV):** Ratio of volume with development to the Maximum Acceptable Volume.

**Acceptable Level of Service (CURRENT LOS):** The Level of Service at which a roadway is currently operating.

**Level of Service with Development (LOS W/DEV):** The Level of Service that a proposed development may generate on a roadway.



BOARD OF COUNTY COMMISSIONERS

**Planning and Development Department**

2725 Judge Fran Jamieson Way  
Building A, Room 114  
Viera, Florida 32940  
(321)633-2070 Phone / (321)633-2074 Fax  
<https://www.brevardfl.gov/PlanningDev>

**STAFF COMMENTS**

**23Z00064**

**Joseph Minnick**

**GU (General Use to RR-1 (Rural Residential))**

Tax Account Number: 2001554  
Parcel I.D.: 20G-34-16-AI-4-3.02  
Location: South of April Ln. and approx. 1,155-feet east of International Ave.  
(District 1)  
Acreage: 1.59 (+/-) acres  
Planning & Zoning Board: 10/16/2023  
Board of County Commissioners: 11/02/2023

**Consistency with Land Use Regulations**

- Current zoning can be considered under the Future Land Use Designation, Section 62-1255.
- The proposal can be considered under the Future Land Use Designation, Section 62-1255.
- The proposal would maintain acceptable Levels of Service (LOS) (XIII 1.6.C)

	<b>CURRENT</b>	<b>PROPOSED</b>
<b>Zoning</b>	GU	RR-1
<b>Potential*</b>	0	1 SF unit
<b>Can be Considered under the Future Land Use Map</b>	YES RES 1	YES RES 1

\* Zoning potential for concurrency analysis purposes only, subject to applicable land development regulations.

**Background and Purpose of Request**

The applicant is requesting to change the zoning classification from GU (General Use) to RR-1 (Rural Residential) on a 1.59-acre lot to build a single-family residence. The subject parcel was originally platted May 26, 1914 in Plat Book 2, Page 33B. The parcel was subdivided on June 28, 2002 and recorded in OR Book 4626, Page 3093 to the current configuration. The property does not meet the GU zoning classification. GU requires 5-acres. Because of the lot split, the property has lost its non-conforming status. This rezoning request will correct this non-conformity.

The property has frontage on April Lane along the maintained portion of the roadway. This maintenance ends at the east property line.

There are no open code enforcement cases associated with the property.

## Surrounding Area

	Existing Use	Zoning	Future Land Use
<b>North</b>	SF Residence	RRMH-1	RES 1
<b>South</b>	Undeveloped	GU	RES 1
<b>East</b>	Undeveloped	GU	RES 1
<b>West</b>	SF Residence	RRMH-1	RES 1

To the north across the ROW is a single-family residence on 1.47-acres with RRMH-1 zoning.

To the south is a 0.27-acre substandard parcel that is undeveloped with GU zoning.

To the east is an undeveloped 1.81-acre parcel with GU zoning.

To the west is a single-family residence on 2-acres with RRMH-1 zoning.

The current GU classification of the subject parcel encompasses rural single-family residential development, or unimproved lands for which there is no definite current proposal for development, or lands in areas lacking specific development trends. It must have a minimum lot size of five (5) acres with a minimum width and depth of 300-feet. It must have a minimum floor area of 750 sq. ft. of living area.

The proposed RR-1 zoning classification permits single-family residential land uses on a minimum one-acre lot, with a minimum lot width and depth of 125 feet. The RR-1 classification permits horses, barns and horticulture as accessory uses to a single-family residence. The minimum house size is 1,200 square feet. Keeping of horses and agricultural uses are accessory to a principal residence within RR-1 zoning.

The RRMH-1 zoning classification permits one single-family home including mobile homes or detached dwelling unit on parcels of spacious character. This classification requires at least one (1) acre with a minimum width and depth of 125-feet. The minimum living area is 600 sq. ft. Keeping of horses and agricultural uses are accessory to a principal residence within RRMH-1 zoning.

Two zoning actions have been approved within a half-mile radius of the subject property within the last three years: **19PZ00098**, approved by the Board on February 12, 2020, was a request to change from GU (General Use) to SR (Suburban Residential) on 1.34-acres located approximately 0.3 miles south of the subject property. **22Z00008**, approved by the Board on May 5, 2022, was a request to change from BU-1 (General Retail Commercial) and AU (Agricultural Residential) to all AU on 7.24-acres located approximately 0.4 miles southeast of the subject property.

There are no pending zoning actions within a half-mile radius of the subject property.

## **Land Use**

The subject property is currently designated as Residential 1 (RES 1) FLU. The existing GU zoning can be considered consistent with the existing RES 1 FLU designation.

The proposed RR-1 zoning can be considered consistent with the existing Residential 1 (RES 1) FLU designation.

## **Applicable Land Use Policies**

**FLUE Policy 1.9** –The Residential 1 Future Land Use designation. The Residential 1 land use designation permits low density residential development with a maximum density of up to one (1) dwelling unit per acre, except as otherwise may be provided for within the Future Land Use Element.

The applicant's request can be considered consistent with the existing RES 1 Future Land Use.

The Board should evaluate the compatibility of this application within the context of Administrative Policies 2 – 8 of the Future Land Use Element.

## **Analysis of Administrative Policy #3 - Compatibility between this site and the existing or proposed land uses in the area.**

Compatibility shall be evaluated by considering the following factors, at a minimum:

### **Criteria:**

- A. Whether the proposed use(s) would have hours of operation, lighting, odor, noise levels, traffic, or site activity that would significantly diminish the enjoyment of, safety or quality of life in existing neighborhoods within the area which could foreseeably be affected by the proposed use;

**The applicant requests to rezone 1.59 acres to RR-1 zoning classification for the purpose of building a single-family residence. Development would need to meet performance standards set forth in code sections 62-2251 through 62-2272. The proposal is not anticipated to diminish the enjoyment of, safety or quality of life in existing neighborhoods within the area.**

- B. Whether the proposed use(s) would cause a material reduction (five per cent or more) in the value of existing abutting lands or approved development.

**Only a certified MAI appraisal can determine if material reduction has or will occur due to the proposed request.**

C. Whether the proposed use(s) is/are consistent with an emerging or existing pattern of surrounding development as determined through an analysis of:

1. historical land use patterns;

**The surrounding area is single-family residential in character on lots 1-acre or larger in size. There is one (1) FLU designation within 500 feet of the subject site: RES 1.**

2. actual development over the immediately preceding three years; and

**There has been one (1) recent development within a half-mile of the subject property within the last three years:**

- **20BC03438 for a single-family residence completed June 24, 2020. Tax Account 2001361, approx. 0.2 miles northeast of the subject property**

3. development approved within the past three years but not yet constructed.

**There has not been any development approved but not yet constructed within this area in the preceding three (3) years.**

**There are no pending zoning actions within one-half mile of the subject property.**

D. Whether the proposed use(s) would result in a material violation of relevant policies in any elements of the Comprehensive Plan.

**No material violation of relevant policies has been identified.**

#### **Analysis of Administrative Policy #4 - Character of a neighborhood or area.**

Character of a neighborhood or area shall be a factor for consideration whenever a rezoning or any application involving a specific proposed use is reviewed. The character of the area must not be materially or adversely affected by the proposed rezoning or land use application. In evaluating the character of an area, the following factors shall be considered:

Criteria:

- A. The proposed use must not materially and adversely impact an established residential neighborhood by introducing types or intensity of traffic (including but not limited to volume, time of day of traffic activity, type of vehicles, etc.), parking, trip generation, commercial activity or industrial activity that is not already present within the identified boundaries of the neighborhood.

**The proposed use is not anticipated to adversely impact the residential character within the surrounding area.**

- B. In determining whether an established residential neighborhood exists, the following factors must be present:

1. The area must have clearly established boundaries, such as roads, open spaces, rivers, lakes, lagoons, or similar features.

**The developed character of the surrounding area can be characterized as single-family residential on larger lots. The area does not have clearly defined boundaries to establish a residential neighborhood. West of the subject property, RR-1 and RRMH-1 zoning classifications are the most prevalent zoning classifications. Further east, there is limited development potential due to access issues.**

2. Sporadic or occasional neighborhood commercial uses shall not preclude the existence of an existing residential neighborhood, particularly if the commercial use is non-conforming or pre-dates the surrounding residential use.

**The parcel does not have any established neighborhood commercial uses or non-conforming commercial uses.**

3. An area shall be presumed not to be primarily residential but shall be deemed transitional where multiple commercial, industrial or other non-residential uses have been applied for and approved during the previous five (5) years.

**The request is not for commercial use. It is located within an existing residential area.**

### **Preliminary Concurrency**

The closest concurrency management segment to the subject property is US 1, from Burkholm to Volusia County which has a Maximum Acceptable Volume (MAV) of 40,300 trips per day, a Level of Service (LOS) of C, and currently operates at 10.10% of capacity daily. The maximum development potential from the proposed rezoning increases the percentage of MAV utilization by 0.02%. The corridor is anticipated to operate at 10.12% of capacity daily. The maximum development potential of the proposal is not anticipated to create a deficiency in LOS. Specific concurrency issues will be address at the time of site plan review. This is only a preliminary review and is subject to change.

No school concurrency information has been provided as the development potential of this site falls below the minimum number of new residential lots that would require a formal review.

The parcel will be serviced by a well and septic.

### **Environmental Constraints**

The property contains mapped hydric soils which may indicate the presence of wetlands on the subject parcel. A wetlands delineation will be required prior to any land clearing activities, site work, or building permit issuance. Since the lot was subdivided into the current configuration in June 2002, and the property is less than 5 acres, wetland impacts shall not exceed 1.8% of property area (approximately 1,246.7 square feet).

Please refer to all comments provided by the Natural Resource Management Department at the end of this report.

### **For Board Consideration**

The Board may wish to consider if the request is consistent and compatible with the surrounding area.



**NATURAL RESOURCES MANAGEMENT DEPARTMENT  
Zoning Review & Summary**

**Item No. 23Z00064**

**Applicant:** Joseph S. Minnick (Owner: Joseph S. Minnick)

**Zoning Request:** GU to RR-1

**Note:** To build a SFR

**Zoning Hearing:** 10/16/2023; **BCC Hearing:** 11/02/2023

**Tax ID No.:** 2001554

- This is a preliminary review based on best available data maps reviewed by the Natural Resources Management Department (NRM) and does not include a site inspection to verify the accuracy of the mapped information.
- In that the rezoning process is not the appropriate venue for site plan review, specific site designs submitted with the rezoning request will be deemed conceptual. Board comments relative to specific site design do not provide vested rights or waivers from Federal, State or County regulations.
- **This review does not guarantee whether or not the proposed use, specific site design, or development of the property can be permitted under current Federal, State, or County Regulations.**

**Summary of Mapped Resources and Noteworthy Land Use Issues:**

- Hydric Soils
- Aquifer Recharge Soils
- Protected and Specimen Trees
- Protected Species

A large portion of the subject parcel contains mapped hydric soils; an indicator that wetlands may be present on the property. A wetland delineation will be required prior to any land clearing activities, site plan design, or building permit submittal. Per Section 62-3694(c)(2), residential land uses within wetlands shall be limited to not more than one dwelling unit per five acres unless strict application of this policy would render a legally established parcel as of September 9, 1988, which is less than five acres, as unbuildable. Application of the one unit per five acres limitation shall limit impacts to wetlands for single-family residential development on a cumulative basis, to not more than 1.8% of the total property acreage. Any permitted wetland impacts must meet the requirements of Section 62-3694(e) including avoidance of impacts and will require mitigation in accordance with Section 62-3696. The applicant is encouraged to contact NRM at (321) 633-2016 prior to any plan or permit submittal.

Florida Scrub Jay occupancy is mapped on the entire parcel, and there is potential for the existence of Gopher Tortoises on site. Prior to any plan, permit submittal, or development activity, including land clearing, the applicant should obtain any necessary permits or clearance letters from the Florida Fish and Wildlife Conservation Commission and/or U.S. Fish and Wildlife Service, as applicable.

### **Land Use Comments:**

#### **Hydric Soils**

A large portion of the subject parcel is mapped with hydric soils (Basinger sand) as shown on the USDA Soil Conservation Service Soils Survey map; an indicator that wetlands may be present on the property. A wetland delineation will be required prior to any land clearing activities, site plan design, or building permit submittal. Per Section 62-3694(c)(2), residential land uses within wetlands shall be limited to not more than one dwelling unit per five acres unless strict application of this policy would render a legally established parcel as of September 9, 1988, which is less than five acres, as unbuildable. Application of the one unit per five acres limitation shall limit impacts to wetlands for single-family residential development on a cumulative basis, to not more than 1.8% of the total property acreage. Any permitted wetland impacts must meet the requirements of Section 62-3694(e) including avoidance of impacts and will require mitigation in accordance with Section 62-3696. The applicant is encouraged to contact NRM at (321) 633-2016 prior to any plan or permit submittal.

#### **Aquifer Recharge Soils**

Basinger sand can also function as an aquifer recharge soil. Mapped topographic elevations indicate the soils may consist of Type 2 or 3 Aquifer Recharge soils that have impervious area restrictions. A topographic survey should be completed prior to development to confirm elevations. The applicant is hereby notified of the development and impervious restrictions within Conservation Element Policy 10.2 and the Aquifer Protection Ordinance.

#### **Protected and Specimen Trees**

Protected and Specimen Trees may exist on the parcel. Per Brevard County Landscaping, Land Clearing and Tree Protection ordinance, Section 62-4331(3), encourages the protection of Specimen Trees. The applicant is advised to refer to Article XIII, Division 2, entitled Land Clearing, Landscaping, and Tree Protection, for specific requirements for preservation and canopy coverage requirements.

#### **Protected Species**

Information available to NRM indicates that federally and/or state protected species may be present on the property. Florida Scrub Jay occupancy is mapped on the entire parcel, and there is potential for existence of Gopher Tortoises on site. Prior to any plan, permit submittal, or development activity, including land clearing, the applicant should obtain any necessary permits or clearance letters from the Florida Fish and Wildlife Conservation Commission and/or U.S. Fish and Wildlife Service, as applicable.

# LOCATION MAP

MINNICK, JOSEPH S

23Z00064

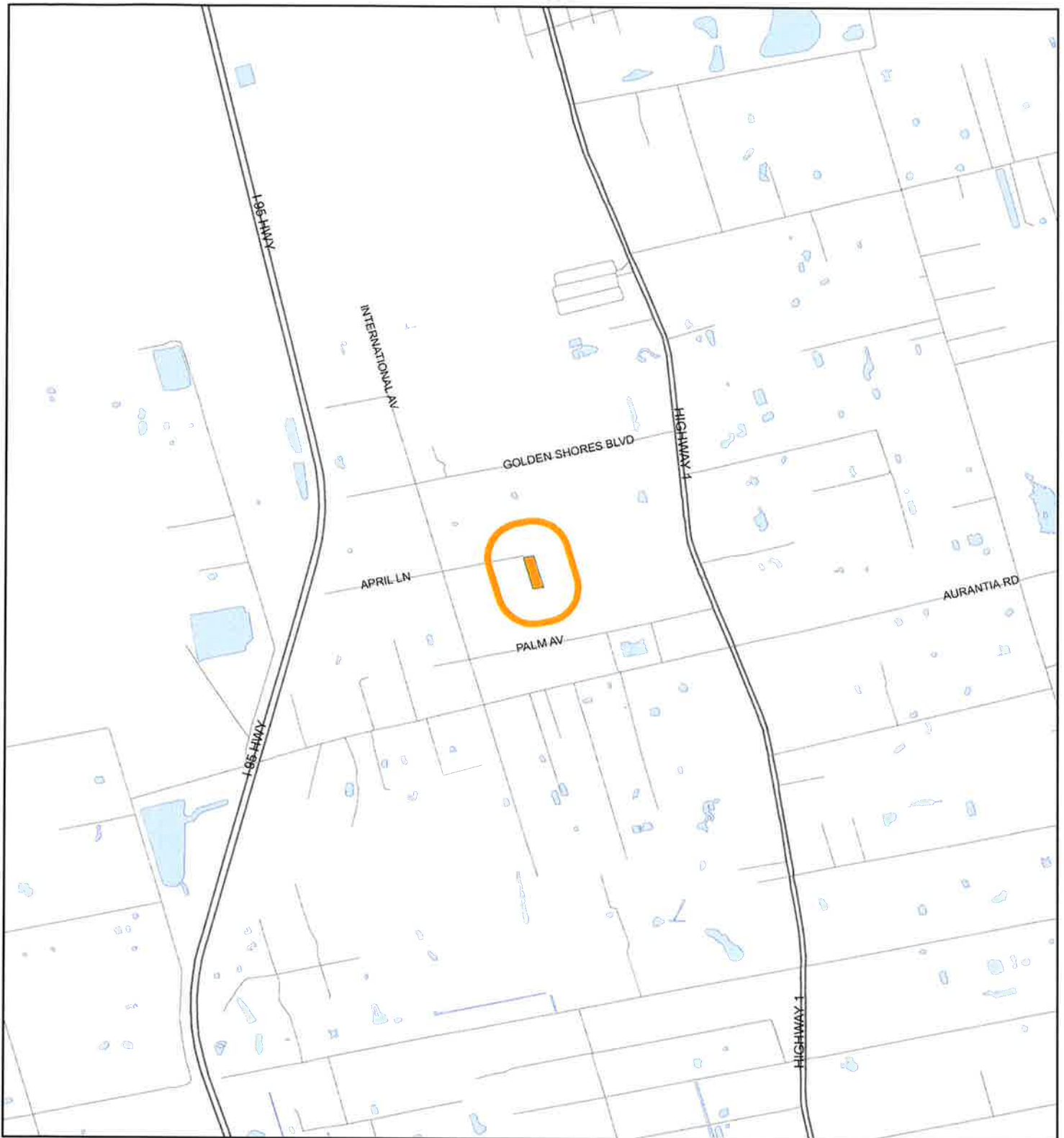

1:24,000 or 1 inch = 2,000 feet

Buffer Distance: 500 feet

This map was compiled from recorded documents and does not reflect an actual survey. The Brevard County Board of County Commissioners does not assume responsibility for errors or omissions hereon.

Produced by BoCC - GIS Date: 7/26/2023

— Buffer  
— Subject Property

# ZONING MAP

MINNICK, JOSEPH S

23Z00064

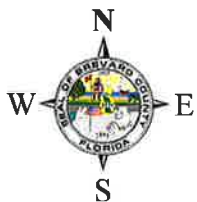

1:4,800 or 1 inch = 400 feet

This map was compiled from recorded documents and does not reflect an actual survey. The Brevard County Board of County Commissioners does not assume responsibility for errors or omissions hereon.

Produced by BoCC - GIS Date: 8/31/2023

Subject Property

Parcels

Zoning



# FUTURE LAND USE MAP

MINNICK, JOSEPH S

23Z00064

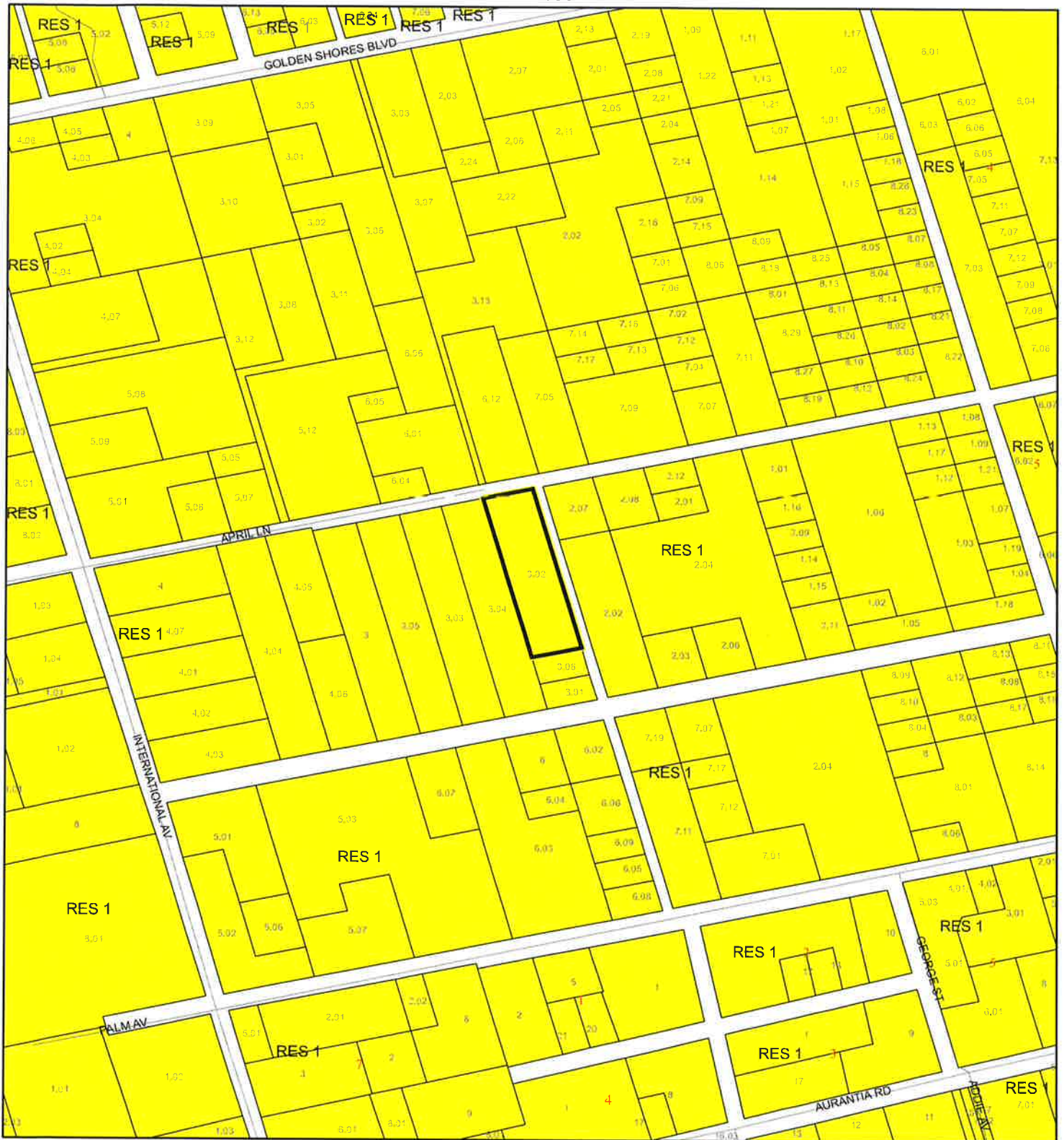

1:4,800 or 1 inch = 400 feet

— Subject Property  
 □ Parcels

This map was compiled from recorded documents and does not reflect an actual survey. The Brevard County Board of County Commissioners does not assume responsibility for errors or omissions hereon.

Produced by BoCC - GIS Date: 7/26/2023



AERIAL MAP

MINNICK, JOSEPH S  
23Z00064

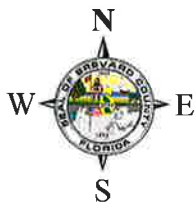

1:2,400 or 1 inch = 200 feet

PHOTO YEAR: 2023

This map was compiled from recorded documents and does not reflect an actual survey. The Brevard County Board of County Commissioners does not assume responsibility for errors or omissions hereon.

Produced by BoCC - GIS Date: 7/26/2023

 Subject Property

 Parcels



# NWI WETLANDS MAP

MINNICK, JOSEPH S

23Z00064

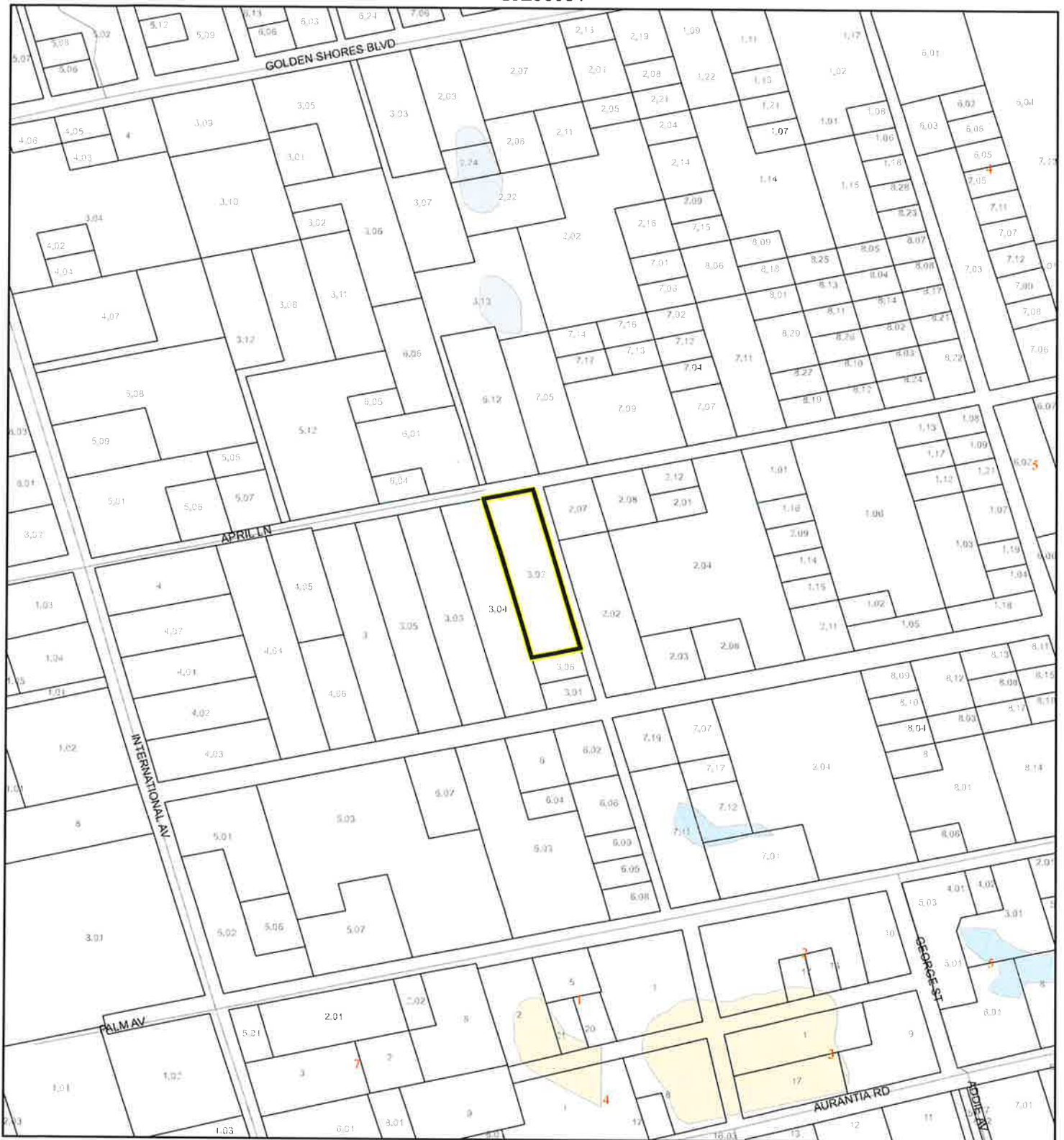

1:4,800 or 1 inch = 400 feet

This map was compiled from recorded documents and does not reflect an actual survey. The Brevard County Board of County Commissioners does not assume responsibility for errors or omissions hereon.

Produced by BoCC - GIS Date: 7/26/2023

## National Wetlands Inventory (NWI)

Estuarine and Marine Deepwater	Freshwater Pond
Estuarine and Marine Wetland	Lake
Freshwater Emergent Wetland	Other
Freshwater Forested/Shrub Wetland	Riverine
Subject Property	
Parcels	

# SJRWMD FLUCCS WETLANDS - 6000 Series MAP

MINNICK, JOSEPH S

23Z00064

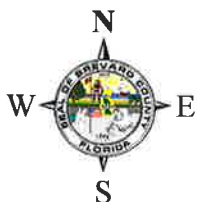

1:4,800 or 1 inch = 400 feet

This map was compiled from recorded documents and does not reflect an actual survey. The Brevard County Board of County Commissioners does not assume responsibility for errors or omissions hereon.

Produced by BoCC - GIS Date: 7/26/2023

## SJRWMD FLUCCS WETLANDS

- Wetland Hardwood Forests - Series 6100
- Wetland Coniferous Forest - Series 6200
- Wetland Forested Mixed - Series 6300
- Vegetated Non-Forested Wetlands - Series 6400
- Non-Vegetated Wetland - Series 6500

Subject Property

Parcels



# USDA SCSSS SOILS MAP

MINNICK, JOSEPH S

23Z00064

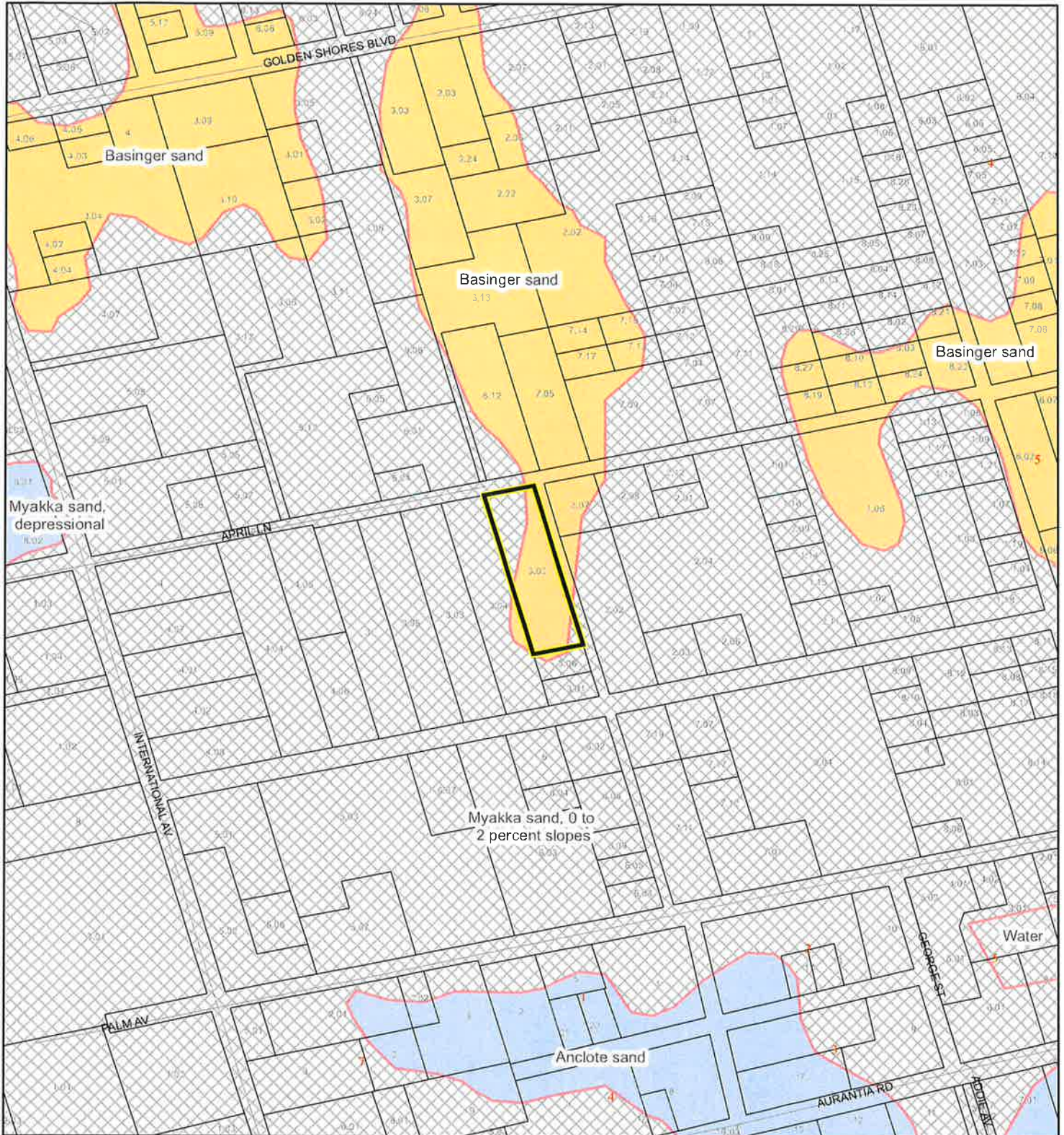

1:4,800 or 1 inch = 400 feet

This map was compiled from recorded documents and does not reflect an actual survey. The Brevard County Board of County Commissioners does not assume responsibility for errors or omissions hereon.

Produced by BoCC - GIS Date: 7/26/2023

## USDA SCSSS Soils

- Aquifer and Hydric
- Aquifer
- Hydric
- None

- Subject Property
- Parcels



23Z00064

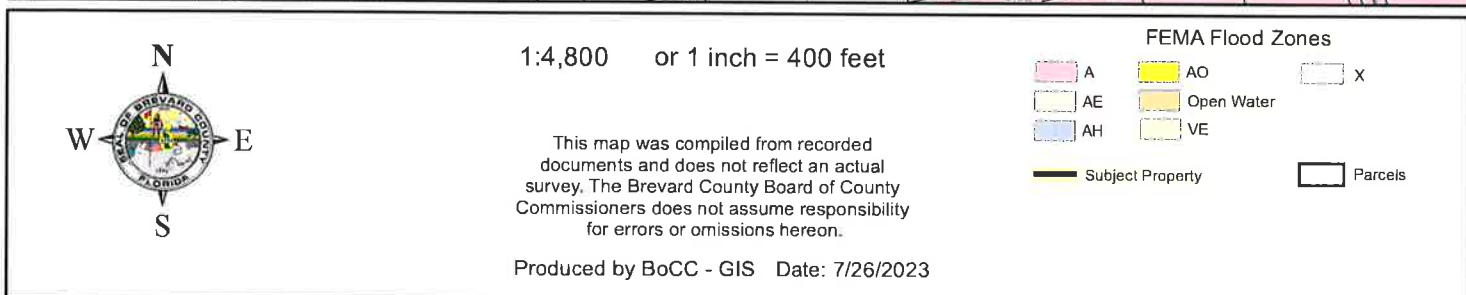

# COASTAL HIGH HAZARD AREA MAP

MINNICK, JOSEPH S

23Z00064

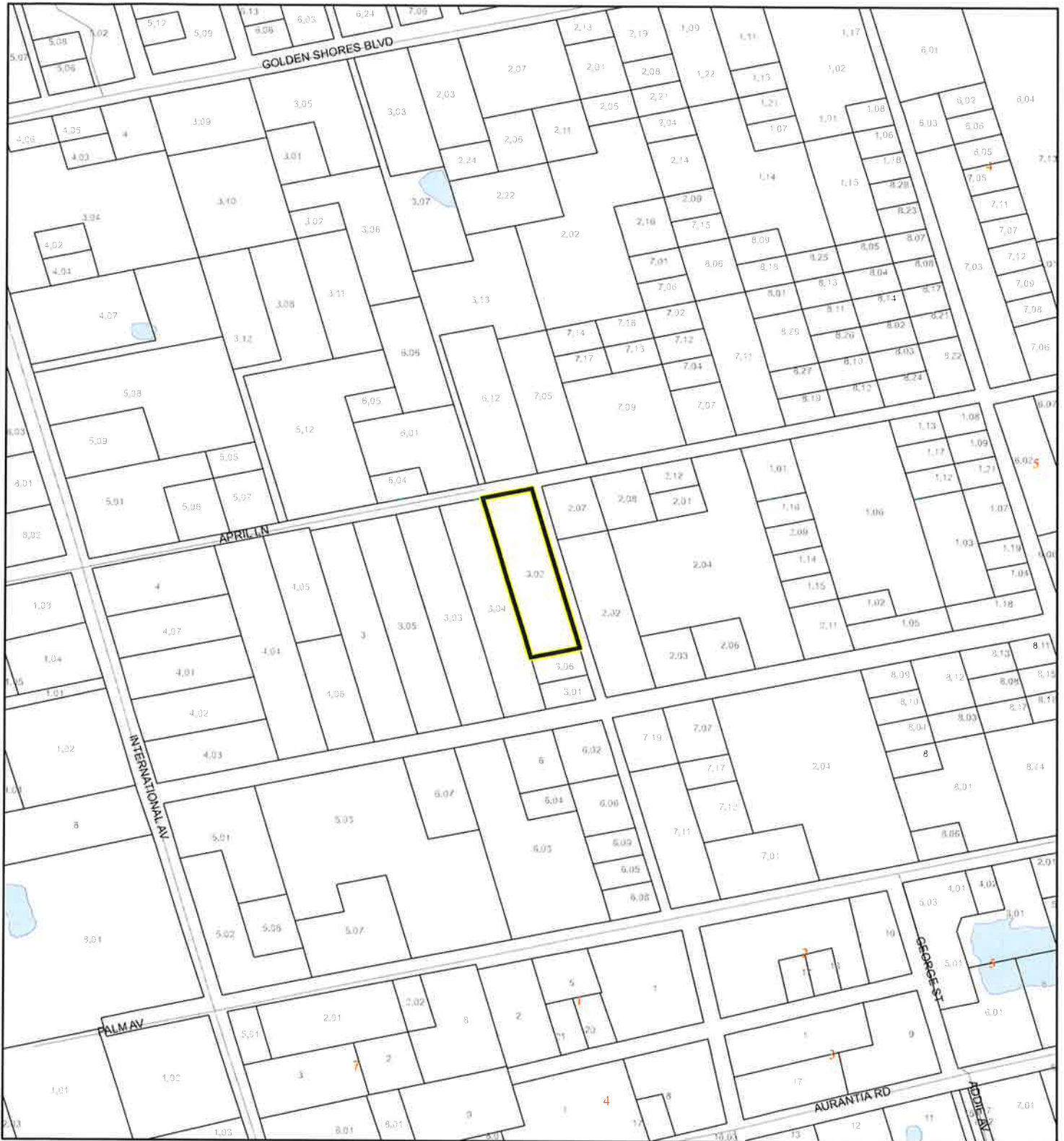

1:4,800 or 1 inch = 400 feet

This map was compiled from recorded documents and does not reflect an actual survey. The Brevard County Board of County Commissioners does not assume responsibility for errors or omissions hereon.

Produced by BoCC - GIS Date: 7/26/2023

 Subject Property

 Parcels

**Coastal High Hazard Area**

 SurgeZoneCat1



# INDIAN RIVER LAGOON SEPTIC OVERLAY MAP

MINNICK, JOSEPH S

23Z00064

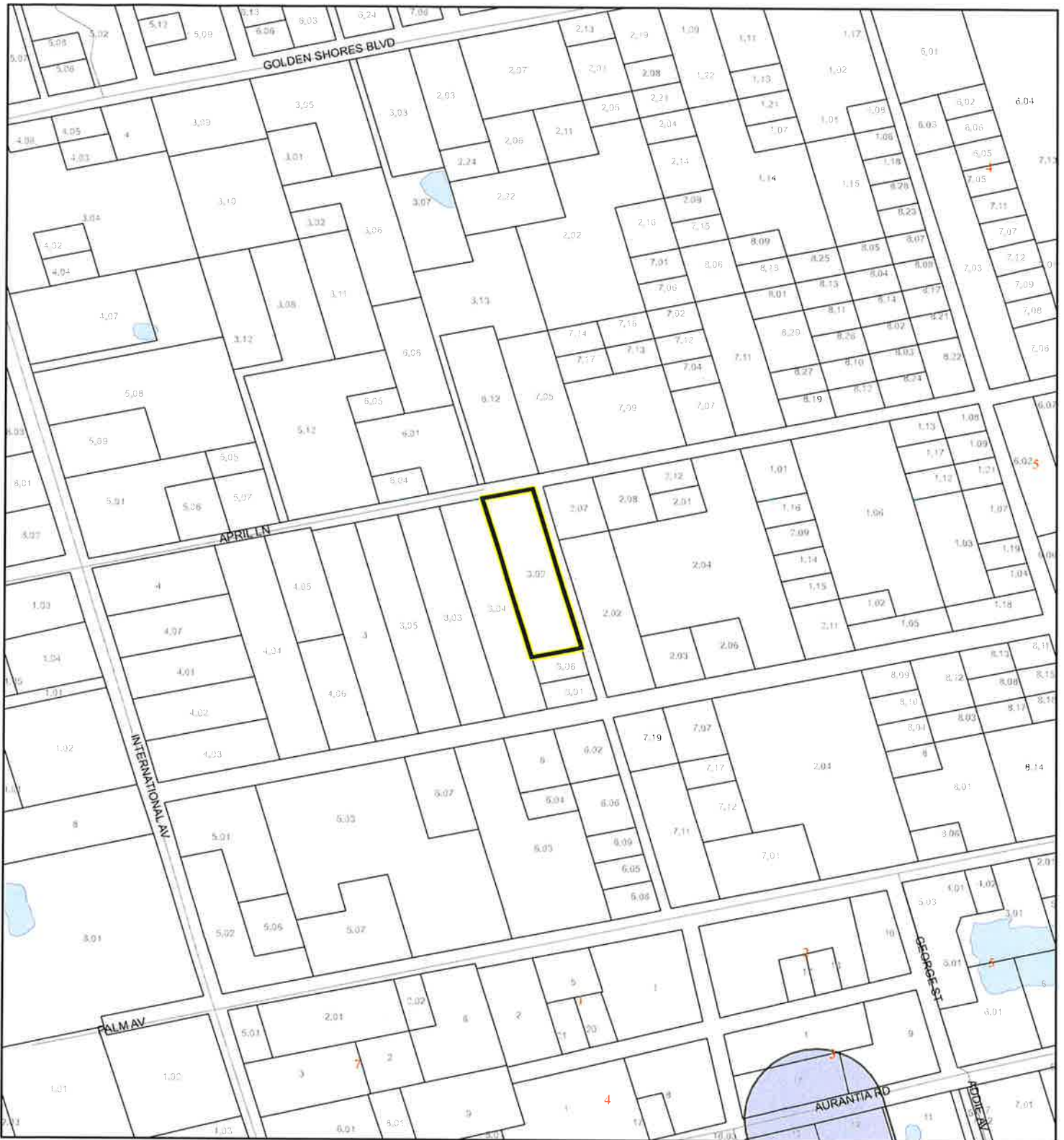

1:4,800 or 1 inch = 400 feet

This map was compiled from recorded documents and does not reflect an actual survey. The Brevard County Board of County Commissioners does not assume responsibility for errors or omissions hereon.

Produced by BoCC - GIS Date: 7/26/2023

 Subject Property

 Parcels

## Septic Overlay

 40 Meters

 60 Meters

 All Distances

# EAGLE NESTS MAP

MINNICK, JOSEPH S

23Z00064

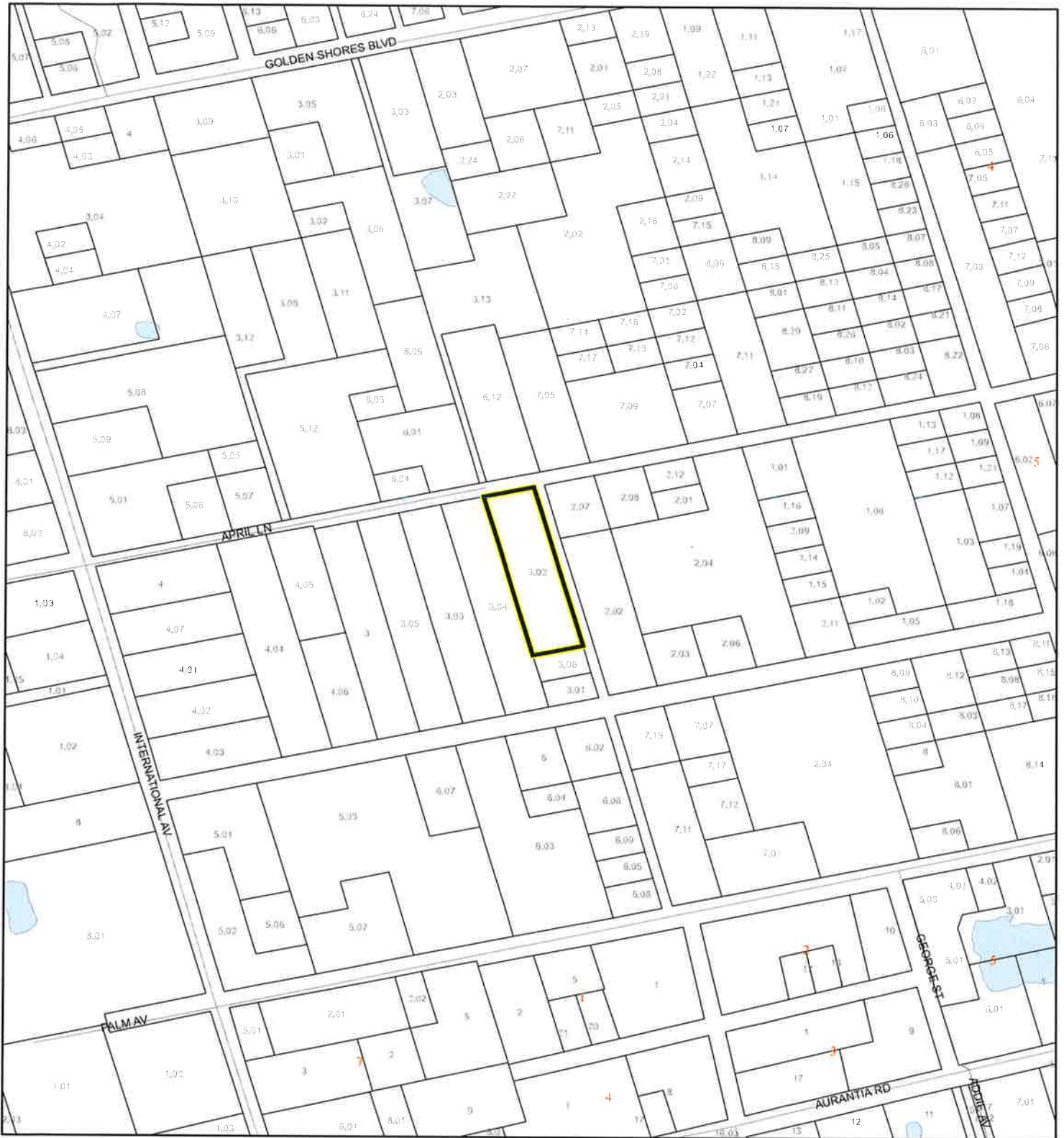

1:4,800 or 1 inch = 400 feet

This map was compiled from recorded documents and does not reflect an actual survey. The Brevard County Board of County Commissioners does not assume responsibility for errors or omissions hereon.

Produced by BoCC - GIS Date: 7/26/2023

 Subject Property

 Parcels



Eagle Nests  
FWS



# SCRUB JAY OCCUPANCY MAP

MINNICK, JOSEPH S

23Z00064

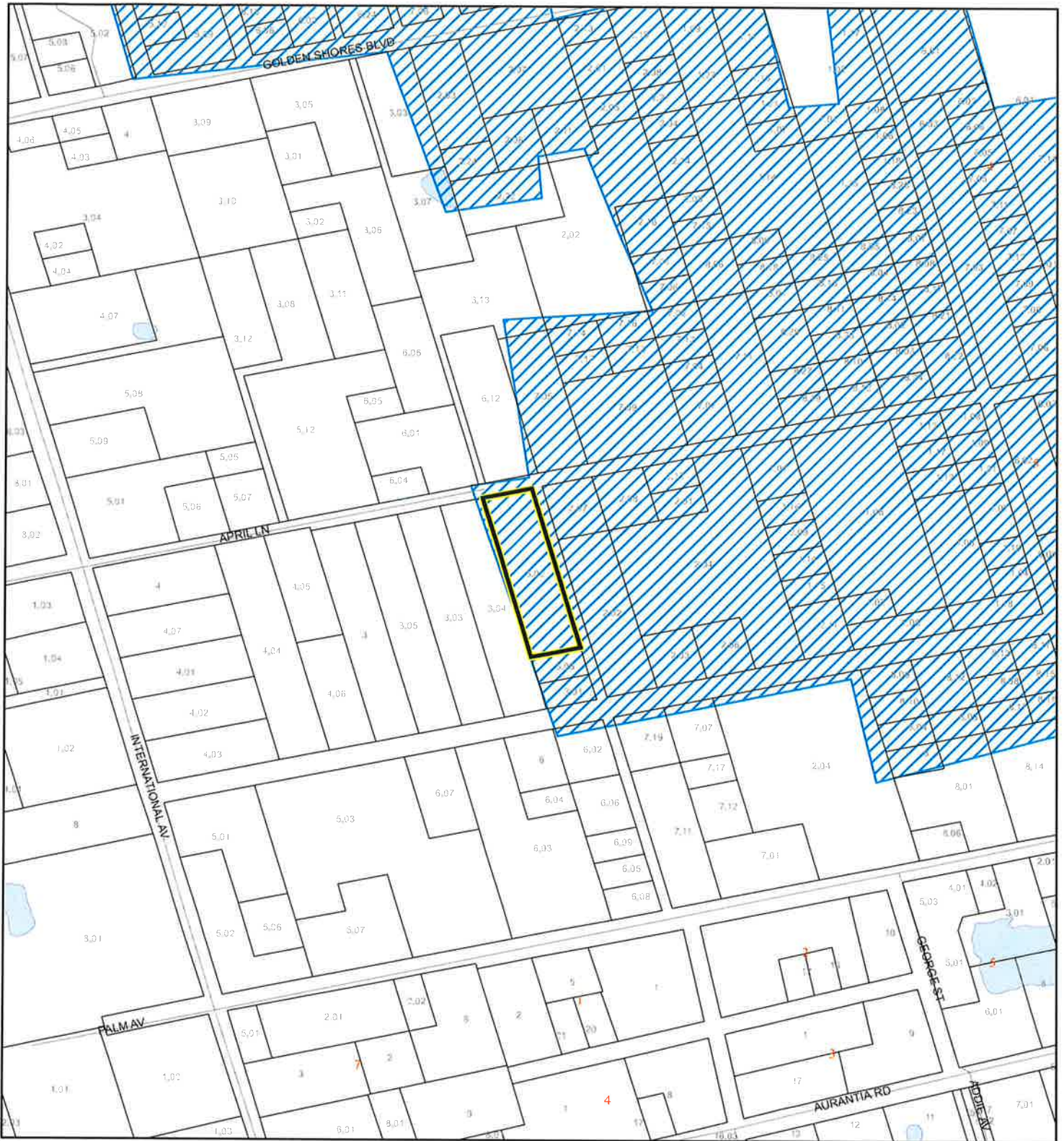

1:4,800 or 1 inch = 400 feet

This map was compiled from recorded documents and does not reflect an actual survey. The Brevard County Board of County Commissioners does not assume responsibility for errors or omissions hereon.

Produced by BoCC - GIS Date: 7/26/2023

- Subject Property
- Parcels
- Scrub Jay Occupancy



# SJRWMD FLUCCS UPLAND FORESTS - 4000 Series MAP

MINNICK, JOSEPH S

23Z00064

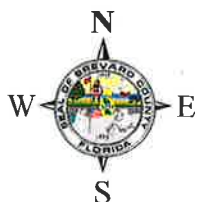

1:4,800 or 1 inch = 400 feet

This map was compiled from recorded documents and does not reflect an actual survey. The Brevard County Board of County Commissioners does not assume responsibility for errors or omissions hereon.

Produced by BoCC - GIS Date: 7/26/2023

## SJRWMD FLUCCS Upland Forests

- Upland Coniferous Forest - 4100 Series
- Upland Hardwood Forest - 4200 Series
- Upland Mixed Forest - 4300 Series
- Tree Plantations - 4400 Series

Subject Property  Parcels

## **PLANNING AND ZONING BOARD/LOCAL PLANNING AGENCY MINUTES**

The Brevard County Planning & Zoning Board met in regular session on **Monday, October 16, 2023**, at **3:00 p.m.**, in the Florida Room, Building C, Brevard County Government Center, 2725 Judge Fran Jamieson Way, Viera, Florida.

The meeting was called to order at 3:00 p.m.

Board members present were: Board members present were: Ron Bartcher (D1); Robert Sullivan (D2); Brian Hodgers (D2); Ben Glover (D3); Debbie Thomas (D4); Mark Wadsworth, Chair (D4); Logan Luse (D4 Alt); Bruce Moia; (D5); and John Hopengarten (BPS).

Staff members present were: Jeffrey Ball, Planning and Zoning Manager; Alex Esseeesse, Deputy County Attorney; Billy Prasad, Strategic Operations Manager; Paul Body, Senior Planner; and Jennifer Jones, Special Projects Coordinator.

### **Excerpt of Complete Agenda**

#### **Joseph Minnick**

A change of zoning classification from GU (General Use) to RR-1 (Rural Residential). The property is 1.32 acres, located on the south side of April Lane, approx. 0.22 miles east of International Ave. (4055 April Lane, Mims) (23Z00064) (Tax Account 2001554) (District 1)

Joseph Minnick, 1968 Turpentine Road, Mims, stated he would like to rezone to RR-1 in order to be able to build a single-family residence.

No public comment.

Motion by Ron Bartcher, seconded by Robert Sullivan, to recommend approval of the change of zoning classification from GU to RR-1. The motion passed unanimously.